

| BUILDING CHARACTERISTICS |                  |                |      |              |                      |
|--------------------------|------------------|----------------|------|--------------|----------------------|
| ELEMENT                  | CD               | CONSTRUCTION   |      |              |                      |
| Exterior Wall            | 19               | COMMON BRK 100 |      |              |                      |
| Roof Structur            | 03               | GABLE/HIP 100  |      |              |                      |
| Roof Cover               | 12               | MODULAR MT 100 |      |              |                      |
| Interior Wall            | 05               | DRYWALL 100    |      |              |                      |
| Interior Floo            | 14               | CARPET 100     |      |              |                      |
| Air Condition            | 03               | CENTRAL 100    |      |              |                      |
| Heating Type             | 04               | AIR DUCTED 100 |      |              |                      |
| Bedrooms                 |                  | 2 100          |      |              |                      |
| Bathrooms                |                  | 1.5 100        |      |              |                      |
| Frame                    | 01               | NONE 100       |      |              |                      |
| Stories                  | 1.               | 1. 100         |      |              |                      |
| Architectual             | 05               | CONV 100       |      |              |                      |
| Units                    |                  | 0 100          |      |              |                      |
| Condition Adj            | 03               | 03 100         |      |              |                      |
| Kitchen Adjus            | 01               | 01 100         |      |              |                      |
| Quality                  | 05               | 05             |      |              |                      |
| DOR CODE                 | 0100             | SINGLE FAMILY  |      |              |                      |
| MAP NUM                  |                  | MKT AREA 01    |      |              |                      |
| NEIGHBORHOOD/LOC         | 35416.010        | 1.00/          |      |              |                      |
| AREA TYPE                | TOTAL GROSS AREA | PCT OF BASE    | YEAR | TOT ADJ AREA | SUBAREA MARKET VALUE |
| BAS                      | 2,004            | 100            |      | 2,004        | 161,067              |
| FEP                      | 144              | 80             |      | 115          | 9,243                |
| FOP                      | 12               | 30             |      | 4            | 322                  |
| UOP                      | 430              | 20             |      | 86           | 6,912                |
| USP                      | 760              | 35             |      | 266          | 21,379               |
| TOTALS                   | 3,350            |                |      | 2,475        | 198,922              |

| MARKET ADJUSTMENTS                                 |     |           |             |                |                |      |      |      |      |      |        |       |
|--|-----|-----------|-------------|----------------|----------------|------|------|------|------|------|--------|-------|
| TYPE   | MDL | EFF. AREA | TOT ADJ PTS | EFF. BASE RATE | REPL. COST NEW | AYB  | EYB  | ECON | FNCT | NORM | % COND |       |
| 0100   | 01  | 2,475     | 110.4000    | 123.65         | 306,034        | 1978 | 1978 | 0    | 0    | 0    | 35.00  | 65.00 |
| 1 SINGLE FAM 100% - 0 Heated Area: 2004 HX Base Yr |     |           |             |                |                |      |      |      |      |      |        |       |

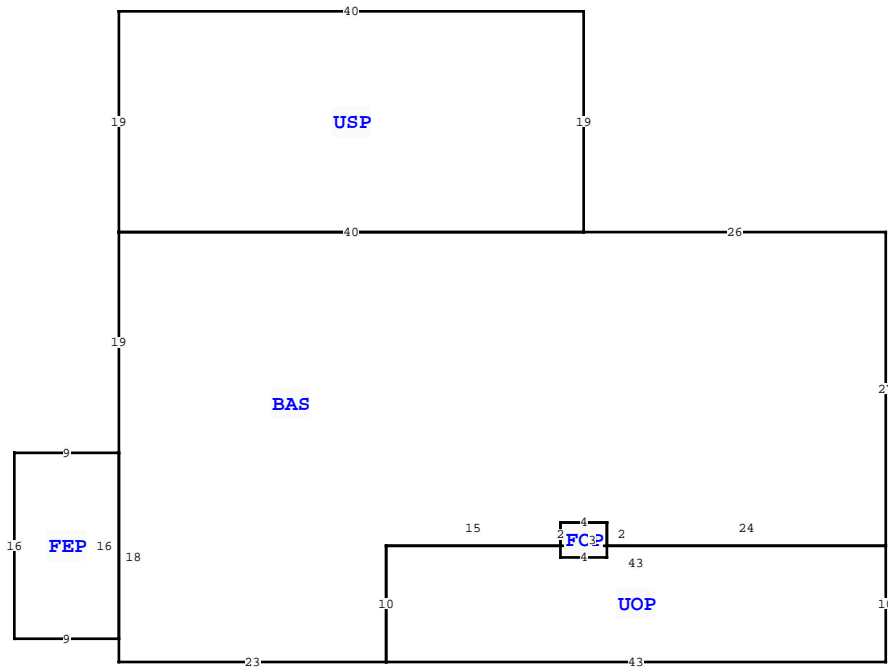

| COLUMBIA COUNTY PROPERTY                          |                  |                 |             |
|---|------------------|-----------------|-------------|
| VALUATION SUMMARY                                 |                  |                 | PAGE 1 of 2 |
| VALUATION BY STANDARD                             |                  |                 |             |
| Tax Group: 3                                      |                  | Tax Dist:       |             |
| BUILDING MARKET VALUE                             |                  | 198,922         |             |
| TOTAL MARKET OB/XF VALUE                          |                  | 28,950          |             |
| TOTAL LAND VALUE - MARKET                         |                  | 23,680          |             |
| TOTAL MARKET VALUE                                |                  | 251,552         |             |
| SOH/AGL Deduction                                 |                  | 89,433          |             |
| ASSESSED VALUE                                    |                  | 162,119         |             |
| TOTAL EXEMPTION VALUE                             |                  | HX HB WX 56,411 |             |
| BASE TAXABLE VALUE                                |                  | 105,708         |             |
| TOTAL JUST VALUE                                  |                  | 251,552         |             |
| NCON VALUE  |                  | 23,200          |             |
| INCOME VALUE                                      |                  |                 |             |
| PREVIOUS YEAR MKT VALUE                           |                  | 231,312         |             |
| LAND:1:1: PLAT SAYS 1.52 AC FOR LOT 8 KING'S WOOD |                  |                 |             |
| PERMIT NUM DESCRIPTION AMT ISSUED                 |                  |                 |             |
| 000047521   | Roof Replacement | 15,000          | 06/22/2023  |

| SALES DATA                  |           |           |       |       |        |            |
|-----------------------------|-----------|-----------|-------|-------|--------|------------|
| OFF RECORD Number           | DATE      | TYPE INST | Q / I | V / I | RSN CD | SALE PRICE |
| 0694/0069                   | 8/11/1989 | WD Q      | Q     | I     |        | 79,500     |
| GRANTOR: DANIEL             |           |           |       |       |        |            |
| GRANTEE: FREEMAN            |           |           |       |       |        |            |
| 0655/0522                   | 6/09/1988 | WD Q      | Q     | I     |        | 64,000     |
| GRANTOR: DANNELS DALE G &   |           |           |       |       |        |            |
| GRANTEE: DANIEL CHARLES E & |           |           |       |       |        |            |

| EXTRA FEATURES |            |             |         |     |   |       |      |       |                |           |         |             |        |        |                 |       |
|----------------|------------|-------------|---------|-----|---|-------|------|-------|----------------|-----------|---------|-------------|--------|--------|-----------------|-------|
| L N            | OB/XF CODE | DESCRIPTION | BLD CAP | L   | W | UNITS | UT   | Adj R | ADJ UNIT PRICE | ORIG COND | YEAR ON | YEAR ACTUAL | Q      | % COND | OB/XF MKT VALUE | NOTES |
| 1              | 0190       | FPLC PF     | 0       | 100 | 0 | 0     | 1.00 | UT    | 1,200.00       | 100       | 0       | 0           | 3      | 100    | 1,200           |       |
| 2              | 0166       | CONC, PAVMT | 0       | 100 | 0 | 0     | 1.00 | UT    | 0.00           | 100       | 1993    | 1993        | 3      | 100    | 100             |       |
| 3              | 0294       | SHED WOOD/  | 0       | 100 | 0 | 0     | 1.00 | UT    | 0.00           | 100       | 1993    | 1993        | 3      | 100    | 500             |       |
| 4              | 0294       | SHED WOOD/  | 0       | 100 | 0 | 0     | 1.00 | UT    | 0.00           | 100       | 1993    | 1993        | 3      | 100    | 750             |       |
| 5              | 0263       | PRCH, USP   | 0       | 100 | 0 | 0     | 1.00 | UT    | 0.00           | 100       | 2019    | 2019        | 3      | 100    | 500             |       |
| 6              | 0261       | PRCH, UOP   | 0       | 100 | 0 | 0     | 1.00 | UT    | 0.00           | 100       | 2019    | 2019        | 3      | 100    | 400             |       |
| 7              | 0296       | SHED METAL  | 0       | 100 | 0 | 0     | 1.00 | UT    | 0.00           | 100       | 2019    | 2019        | 3      | 100    | 800             |       |
| 8              | 0120       | CLFENCE 4   | 0       | 100 | 0 | 0     | 1.00 | UT    | 0.00           | 100       | 2019    | 2019        | 3      | 100    | 1,500           |       |
| 9              | 0294       | SHED WOOD/  | 0       | 100 | 0 | 0     | 1.00 | UT    | 10,800.00      | 100       | 2026    | 2025        |        | 100    | 10,800          |       |
| 10             | 0252       | LEAN-TO W/  | 0       | 100 | 0 | 0     | 1.00 | UT    | 400.00         | 100       | 2026    | 2025        |        | 100    | 400             |       |
| TOTALS         |            |             |         |     |   |       |      |       |                |           |         |             | 16,950 |        |                 |       |

| LAND DESCRIPTION |          |     |                      |     |     |          |        |        |             |           |     |          |        |         |            |                |            |                             |      |         |      |     |    |        |
|------------------|----------|-----|----------------------|-----|-----|----------|--------|--------|-------------|-----------|-----|----------|--------|---------|------------|----------------|------------|-----------------------------|------|---------|------|-----|----|--------|
| L N              | USE CODE | CLS | LAND USE DESCRIPTION | CAP | R D | LOC ZONE | FRONT  | DEPTH  | TOT LND UTS | UNIT TYPE | D T | DPH FACT | % COND | TOT ADJ | UNIT PRICE | ADJ UNIT PRICE | LAND VALUE | OTHER ADJUSTMENTS AND NOTES | YEAR | DENSITY | DECL | FRZ | YR | CONSRV |
| 1                | 0100     | C   | SFR                  | 100 |     | 00       | 161.00 | 403.00 | 1.48        | AC        |     | 1.00     | 1.00   | 1.00    | 16,000.00  | 16,000.00      | 23,680     |                             |      |         |      |     |    |        |

