

COMM 846 FT S OF NW, E 552.92 FT  
371.75 FT, E 162.36 FT, S 371.75  
TO POB.

FOWLER SETH/FOWLER EMILY  
211 SW KINGWOOD PL  
LAKE CITY, FL 32024

**2026**

35-4S-16-03282-013



| BUILDING CHARACTERISTICS |                  | CONSTRUCTION  |      |
|--------------------------|------------------|---------------|------|
| ELEMENT                  | CD               |               |      |
| Exterior Wall            | 17               | MSNRY STUC    | 100  |
| Roof Structur            | 03               | GABLE/HIP     | 100  |
| Roof Cover               | 03               | COMP SHNGL    | 100  |
| Interior Wall            | 05               | DRYWALL       | 100  |
| Interior Floo            | 14               | CARPET        | 90   |
| Interior Floo            | 06               | VINYL ASB     | 10   |
| Air Condition            | 03               | CENTRAL       | 100  |
| Heating Type             | 04               | AIR DUCTED    | 100  |
| Bedrooms                 |                  | 3             | 100  |
| Bathrooms                |                  | 2             | 100  |
| Frame                    | 01               | NONE          | 100  |
| Stories                  | 1.               | 1.            | 100  |
| Architectual             | 05               | CONV          | 100  |
| Units                    |                  | 0             | 100  |
| Condition Adj            | 01               | 01            | 100  |
| Kitchen Adjus            | 01               | 01            | 100  |
| Quality                  | 05               | 05            |      |
| DOR CODE                 | 0100             | SINGLE FAMILY |      |
| MAP NUM                  |                  | MKT AREA      | 01   |
| NEIGHBORHOOD/LOC         | 35416.010        | 1.00/         |      |
| AREA TYPE                | TOTAL GROSS AREA | PCT OF BASE   | YEAR |
| BAS                      | 1,377            | 100           |      |
| FCP                      | 228              | 25            |      |
| FOP                      | 35               | 30            |      |
| FOP                      | 48               | 30            |      |
| FSP                      | 288              | 40            |      |
| UST                      | 48               | 45            |      |
| TOTALS                   | 2,024            |               |      |

| MARKET ADJUSTMENTS |            |           |             |                |                |                 |     |      |      |      |        |
|--------------------|------------|-----------|-------------|----------------|----------------|-----------------|-----|------|------|------|--------|
| TYPE               | MDL        | EFF. AREA | TOT ADJ PTS | EFF. BASE RATE | REPL. COST NEW | AYB             | EYB | ECON | FNCT | NORM | % COND |
| 1                  | SINGLE FAM | 100%      | - 1996      |                |                |                 |     |      |      |      |        |
| Heated Area: 1377  |            |           |             |                |                | HX Base Yr 1996 |     |      |      |      |        |

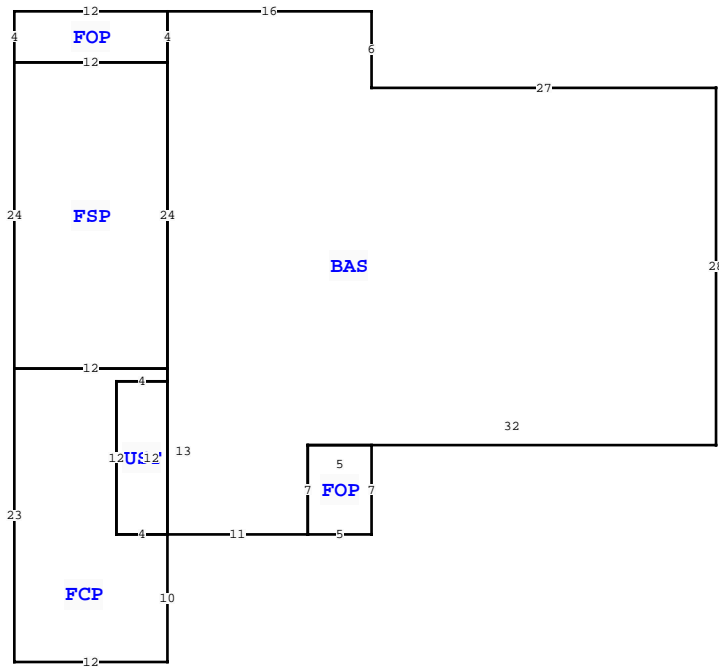

| COLUMBIA COUNTY PROPERTY  |             | PAGE 1 of 1 | 3 |
|---------------------------|-------------|-------------|---|
| VALUATION SUMMARY         |             |             |   |
| VALUATION BY              |             | STANDARD    |   |
| Tax Group: 3              | Tax Dist:   |             |   |
| BUILDING MARKET VALUE     |             | 104,380     |   |
| TOTAL MARKET OB/XF VALUE  |             | 2,780       |   |
| TOTAL LAND VALUE - MARKET |             | 20,016      |   |
| TOTAL MARKET VALUE        |             | 127,176     |   |
| SOH/AGL Deduction         |             | 57,607      |   |
| ASSESSED VALUE            |             | 69,569      |   |
| TOTAL EXEMPTION VALUE     | HX HB SL WX | 69,569      |   |
| BASE TAXABLE VALUE        |             | 0           |   |
| TOTAL JUST VALUE          |             | 127,176     |   |
| NCON VALUE                |             | 800         |   |
| INCOME VALUE              |             |             |   |
| PREVIOUS YEAR MKT VALUE   |             | 123,874     |   |

| PERMIT NUM | DESCRIPTION | AMT | ISSUED     |
|------------|-------------|-----|------------|
| 31877      | MAINT/ALTR  | 30  | 04/09/2014 |

| SALES DATA               |           |           |     |     |        |            |
|--------------------------|-----------|-----------|-----|-----|--------|------------|
| OFF RECORD Number        | DATE      | TYPE INST | Q U | V I | RSN CD | SALE PRICE |
| 1569/2585                | 6/05/2026 | WD Q      | Q   | I   | 01     | 242,000    |
| GRANTOR: YOUNG AUDREY M  |           |           |     |     |        |            |
| GRANTEE: FOWLER SETH     |           |           |     |     |        |            |
| 0808/1410                | 7/31/1995 | WD Q      | Q   | I   |        | 51,900     |
| GRANTOR: PETER W GIEBEIG |           |           |     |     |        |            |
| GRANTEE: AUDREY M YOUNG  |           |           |     |     |        |            |

| BLD DATE |          | LGL DATE   |         |
|----------|----------|------------|---------|
| XF DATE  | INC DATE | LAND DATE  | AG DATE |
|          |          | 04/16/2026 | MLU     |

| BUILDING NOTES   |  |
|--|--|
| <p><b>BUILDING DIMENSIONS</b></p> <p>BAS= W27 N6 W16 FOP= W12 S4 E12 N4\$ S4 FSP= W12 S24 E12 N24\$S24 FCP= W12 S23 E12 N10 UST= N12 W4 S12 E4\$ W4 N12 E4 N1\$ S13 E11 FOP= E5 N7 W5 S7\$ N7 E32 N28\$.</p> |  |

| EXTRA FEATURES |            |             |         |     |    |       |        |       |                |           |         |             |   |        |                 |       |
|----------------|------------|-------------|---------|-----|----|-------|--------|-------|----------------|-----------|---------|-------------|---|--------|-----------------|-------|
| L N            | OB/XF CODE | DESCRIPTION | BLD CAP | L   | W  | UNITS | UT     | Adj R | ADJ UNIT PRICE | ORIG COND | YEAR ON | YEAR ACTUAL | Q | % COND | OB/XF MKT VALUE | NOTES |
| 1              | 0190       | FPLC PF     | 0       | 100 | 0  | 0     | 1.00   | UT    | 1,200.00       | 100       | 0       | 0           | 3 | 100    | 1,200           |       |
| 2              | 0296       | SHED METAL  | 0       | 100 | 12 | 16    | 192.00 | UT    | 5.00           | 50        | 1996    | 1996        | 3 | 50     | 480             |       |
| 3              | 0040       | BARN, POLE  | 0       | 100 | 0  | 0     | 1.00   | UT    | 400.00         | 75        | 1993    | 1993        | 3 | 75     | 300             |       |
| 4              | 0296       | SHED METAL  | 0       | 100 | 0  | 0     | 1.00   | UT    | 800.00         | 100       | 2026    | 2025        |   | 100    | 800             |       |

| LAND DESCRIPTION |          |     |                      |     |     |          |       |       |             |           |     | TOTAL OB/XF |        |         |            |                |            |                             |      |         |      |     |    |        |
|------------------|----------|-----|----------------------|-----|-----|----------|-------|-------|-------------|-----------|-----|-------------|--------|---------|------------|----------------|------------|-----------------------------|------|---------|------|-----|----|--------|
| L N              | USE CODE | CLS | LAND USE DESCRIPTION | CAP | R D | LOC ZONE | FRONT | DEPTH | TOT LND UTS | UNIT TYPE | D T | DPH FACT    | % COND | TOT ADJ | UNIT PRICE | ADJ UNIT PRICE | LAND VALUE | OTHER ADJUSTMENTS AND NOTES | YEAR | DENSITY | DECL | FRZ | YR | CONSRV |
| 1                | 0100     | C   | SFR                  | 100 |     | 00       | 0.00  | 0.00  | 1.39        | AC        |     | 1.00        | 1.00   | 0.90    | 16,000.00  | 14,400.00      | 20,016     |                             |      |         |      |     |    |        |