

COMM SE COR OF SEC, RUN N 93.99
N 344.55 FT, W 122.26 FT, S 342.
FT TO POB.

STEINMANN LORETTA S
166 SE HORACE WITT WAY
LAKE CITY, FL 32025

2026

34-5S-17-09514-001
VALUATION SUMMARY

BUILDING CHARACTERISTICS		CONSTRUCTION	
ELEMENT	CD		
Exterior Wall	19	COMMON BRK	100
Roof Structur	03	GABLE/HIP	100
Roof Cover	03	COMP SHNGL	100
Interior Wall	05	DRYWALL	100
Interior Floor	14	CARPET	90
Interior Floor	06	VINYL ASB	10
Air Condition	03	CENTRAL	100
Heating Type	04	AIR DUCTED	100
Bedrooms		3	100
Bathrooms		2	100
Frame	01	NONE	100
Stories	1.1	1.100	
Architectural	05	CONV	100
Units		0	100
Condition Adj	03	03	100
Kitchen Adjus	01	01	100
Quality	07	07	
DOR CODE	0100	SINGLE FAMILY	
MAP NUM		MKT AREA	02
NEIGHBORHOOD/LOC	34517.00 1.00/		
AREA TYPE	TOTAL GROSS AREA	PCT OF BASE	YEAR
BAS	2,004	100	
FEP	200	80	
FGR	900	55	
FOP	112	30	
FOP	120	30	
FST	84	55	
UDG	576	55	
UOP	112	20	
UST	288	45	
TOTALS	4,396		

MARKET ADJUSTMENTS											
TYPE	MDL	EFF. AREA	TOT ADJ PTS	EFF. BASE RATE	REPL. COST NEW	AYB	EYB	ECON	FNCT	NORM	% COND
0100	01	3,244	117.5625	131.67	427,137	1968	1968	0	0	0	35.00
1 SINGLE FAM 100% - 0 Heated Area: 2004 HX Base Yr											

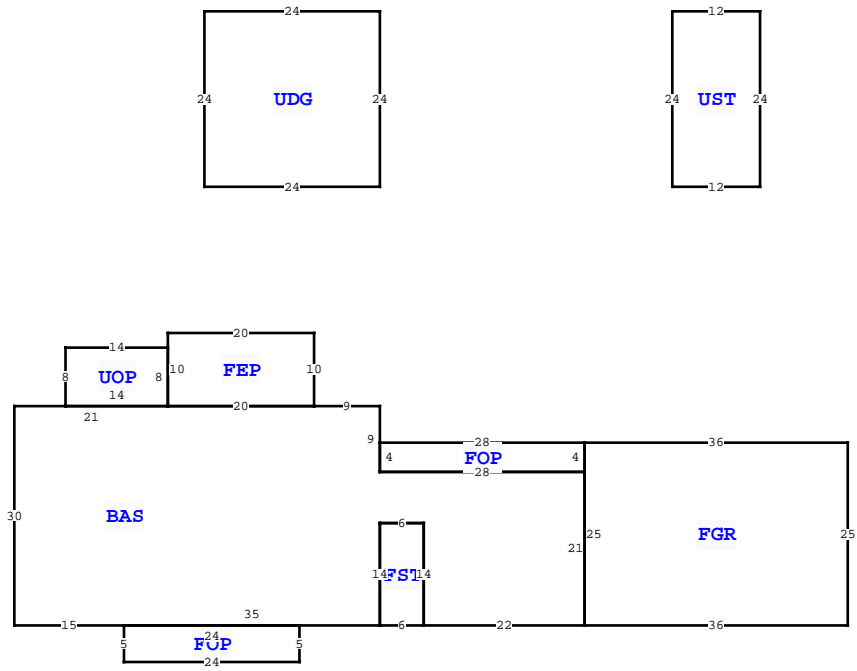

VALUATION BY		STANDARD
Tax Group: 3	Tax Dist:	
BUILDING MARKET VALUE		277,639
TOTAL MARKET OB/XF VALUE		17,086
TOTAL LAND VALUE - MARKET		16,560
TOTAL MARKET VALUE		311,285
SOH/AGL Deduction		164,696
ASSESSED VALUE		146,589
TOTAL EXEMPTION VALUE	HX HB WX	56,411
BASE TAXABLE VALUE		90,178
TOTAL JUST VALUE		311,285
NCON VALUE		0
INCOME VALUE		
PREVIOUS YEAR MKT VALUE		308,525

PERMIT NUM	DESCRIPTION	AMT	ISSUED
000055190	Generator		03/09/2026
000055147	Electrical Servic		03/03/2026
000052934	Roof Replacement	8,390	04/25/2025
000052935	Roof Replacement	22,590	04/25/2025
19621	PUMP/UTPOL	30	06/06/2002
19525	GARAGE	140	05/09/2002

SALES DATA						
OFF RECORD Number	DATE	TYPE INST	Q / U	V / I	RSN CD	SALE PRICE
0639/0527	12/16/1987	WD	U	I		60,000

GRANTOR: COBB L J & MAURINE
GRANTEE: STEINMANN E JAMES &

BUILDING NOTES	
BUILDING DIMENSIONS	
BAS= W9 FEP= N10 W20 S10 E20\$ W20 UOP= N8 W14 S8 E14 \$ W21 S30 E15 FOP= S5 E24 N5 W24\$ E35 FST= E6 N14W6 S14\$ N14 E6 S14 E22 FGR= E36 N25 W36 S25\$ N21 FOP= N4 W28 S4 E28\$ W28 N9\$ PTR= N30 UDG= N24 W24 S24 E24\$ S30\$ PTR= N30 E40 UST= E12 N24 W12 S24\$ S30 W40\$.	

EXTRA FEATURES																
L N	OB/XF CODE	DESCRIPTION	BLD CAP	L	W	UNITS	UT	Adj R	ADJ UNIT PRICE	ORIG COND	YEAR ON	YEAR ACTUAL	Q	% COND	OB/XF MKT VALUE	NOTES
1	0190	FPLC PF	0	100	0	0	UT	1.00	1,200.00	100	0	0	3	100	1,200	
2	0280	POOL R/CON	0	100	16	32	UT	70.00	70.00	100	1968	1968	3	40	14,336	
3	0080	DECKING	0	100	12	20	UT	0.00	0.00	100	1993	1993	3	100	250	
4	0296	SHED METAL	0	100	12	20	UT	0.00	0.00	100	1993	1993	3	100	400	
5	0251	LEAN TO W/	0	100	0	0	UT	0.00	0.00	100	2017	2017	3	100	400	
6	0296	SHED METAL	0	100	0	0	UT	0.00	0.00	100	2017	2017	3	100	500	

LAND DESCRIPTION		TOTAL OB/XF													17,086									
L N	USE CODE	CLS	LAND USE DESCRIPTION	CAP	R D	LOC ZONE	FRONT	DEPTH	TOT LND UTS	UNIT TYPE	D T	DPH FACT	% COND	TOT ADJ	UNIT PRICE	ADJ UNIT PRICE	LAND VALUE	OTHER ADJUSTMENTS AND NOTES	YEAR	DENSITY	DECL	FRZ	YR	CONSRV
1	0100	C	SFR	100		A-1	0.00	0.00	0.92	AC		1.00	1.00	1.00	18,000.00	18,000.00	16,560							