

LOT 77 EASTSIDE VILLAGE S/D.
695-497, DC 1258-2495, WD 1258-2

STEPHENS JEANIE/PEACE FRANCES
173 SE JENESE WAY
LAKE CITY, FL 32025

2026

34-3S-17-07018-177
VALUATION SUMMARY

ELEMENT	CD	CONSTRUCTION
Exterior Wall	31	VINYL SID 100
Roof Structur	03	GABLE/HIP 100
Roof Cover	03	COMP SHNGL 100
Interior Wall	05	DRYWALL 100
Interior Floor	14	CARPET 90
Interior Floor	08	SHT VINYL 10
Air Condition	03	CENTRAL 100
Heating Type	04	AIR DUCTED 100
Bedrooms		2 100
Bathrooms		2 100
Frame	01	NONE 100
Stories	1.	1. 100
Architectual	05	CONV 100
Units		0 100
Condition Adj	03	03 100
Kitchen Adjus	01	01 100

TYPE	MDL	EFF. AREA	TOT ADJ PTS	EFF. BASE RATE	REPL. COST NEW	AYB	EYB	ECON	FNCT	NORM	% COND
1	SINGLE FAM	0%	2026								

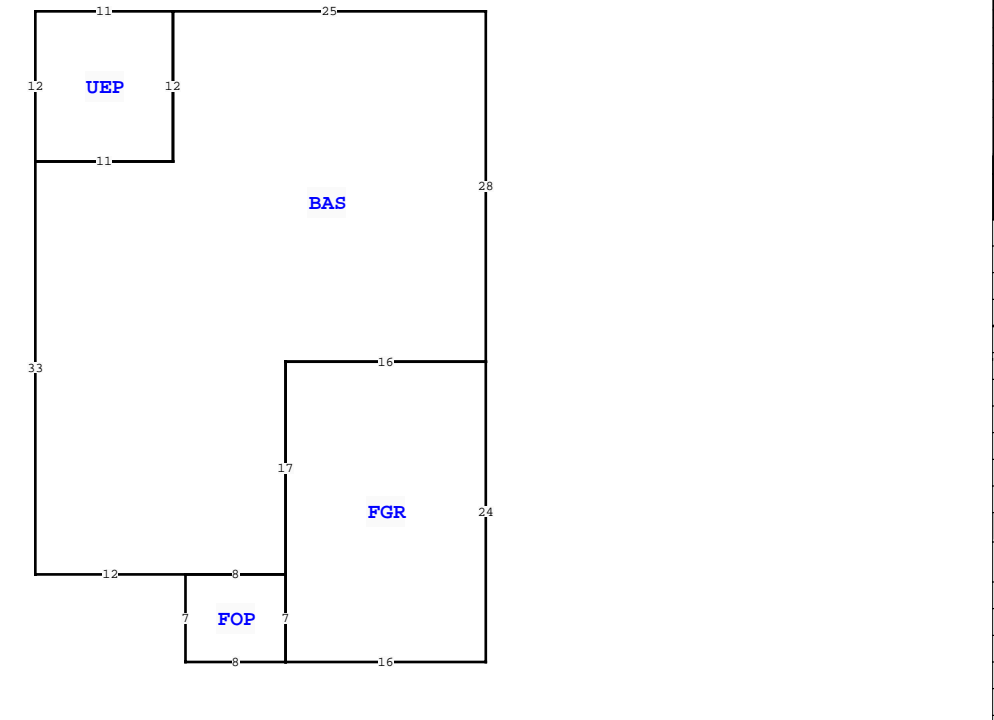

AREA TYPE	TOTAL GROSS AREA	PCT OF BASE	YEAR	TOT ADJ AREA	SUBAREA MARKET VALUE
BAS	1,216	100		1,216	95,354
FGR	384	55		211	16,546
FOP	56	30		17	1,333
UEP	132	60		79	6,195
TOTALS	1,788			1,523	119,428

L N	OB/XF CODE	DESCRIPTION	BLD CAP	L	W	UNITS	UT	Adj R	ADJ UNIT PRICE	ORIG COND	YEAR ON	YEAR ACTUAL	Q	% COND	OB/XF MKT VALUE	NOTES
1	0166	CONC,PAVMT	0	0	0	1.00	UT	0.00	0.00	100	0	0	3	100	400	

EXTRA FEATURES		TOTAL OB/XF	
173 SE JENESE WAY, LAKE CITY		400	

L N	USE CODE	CLS	LAND USE DESCRIPTION	CAP	R D	LOC ZONE	FRONT	DEPTH	TOT LND UTS	UNIT TYPE	D T	DPH FACT	% COND	TOT ADJ	UNIT PRICE	ADJ UNIT PRICE	LAND VALUE	OTHER ADJUSTMENTS AND NOTES	YEAR	DENSITY	DECL	FRZ	YR	CONSRV
1	0100	C	SFR	0		RSF/MH	0.00	0.00	1.00	LT		1.00	1.00	1.00	22,500.00	22,500.00	22,500							

BLD DATE	XF DATE	INC DATE	LGL DATE	LAND DATE	AG DATE
			04/21/2023	MLU	

VALUATION BY		STANDARD
Tax Group: 2	Tax Dist:	
BUILDING MARKET VALUE		119,428
TOTAL MARKET OB/XF VALUE		400
TOTAL LAND VALUE - MARKET		22,500
TOTAL MARKET VALUE		142,328
SOH/AGL Deduction		0
ASSESSED VALUE		142,328
TOTAL EXEMPTION VALUE		0
BASE TAXABLE VALUE		142,328
TOTAL JUST VALUE		142,328
NCON VALUE		0
INCOME VALUE		
PREVIOUS YEAR MKT VALUE		142,328

PERMIT NUM	DESCRIPTION	AMT	ISSUED

SALES DATA						
OFF RECORD Number	DATE	TYPE INST	Q U	V I	RSN CD	SALE PRICE
1502/2120	11/13/2023	LE U	I	I	14	23,800
GRANTOR: COLEMAN JUDITH GIDDEN						
GRANTEE: STEPHENS JEANIE (RM)						
1258/2497	7/22/2013	WD Q	I	I	01	64,000
GRANTOR: GERTRUDE REASH						
GRANTEE: JUDITH GIDDENS						

BUILDING NOTES	

BUILDING DIMENSIONS	
BAS= W25 UEP= W11 S12 E11 N12\$ S12 W11 S33 E12 FOP= S7E8 N7 W8\$ E8 FGR= S7 E16 N24W16 S17\$ N17 E16 N28\$.	