

LOT 7 EASTSIDE VILLAGE S/D.
687-182, 835-1566, 925-782, LE 1

JOHNS LONNIE R/JOHNS PATRICIA L
232 SE PEARL TER
LAKE CITY, FL 32025

2026

34-3S-17-07018-107
VALUATION SUMMARY PAGE 1 of 1

BUILDING CHARACTERISTICS		CONSTRUCTION	
ELEMENT	CD		
Exterior Wall	26	ALM SIDING 100	
Roof Structur	03	GABLE/HIP 100	
Roof Cover	12	MODULAR MT 80	
Roof Cover	01	MINIMUM 20	
Interior Wall	05	DRYWALL 100	
Interior Floor	14	CARPET 90	
Interior Floor	08	SHT VINYL 10	
Air Condition	03	CENTRAL 100	
Heating Type	04	AIR DUCTED 100	
Bedrooms		2 100	
Bathrooms		2 100	
Stories	1.	1. 100	
Architectual	01	CONV 100	
Units		0 100	
Condition Adj	03	03 100	
Kitchen Adjus	01	01 100	
Quality	05	05	
DOR CODE	0200 MOBILE HOME		
MAP NUM		MKT AREA	06
NEIGHBORHOOD/LOC	34317.040 1.00/		
AREA TYPE	TOTAL GROSS AREA	PCT OF BASE	YEAR
BAS	1,056	100	
FCP	552	25	
FEP	120	85	
FST	144	55	
TOTALS	1,872		

MARKET ADJUSTMENTS											
TYPE	MDL	EFF. AREA	TOT ADJ PTS	EFF. BASE RATE	REPL. COST NEW	AYB	EYB	ECON	FNCT	NORM	% COND
1	MOBILE HME	100%	2005								
					Heated Area: 1056			HX Base Yr 2005			

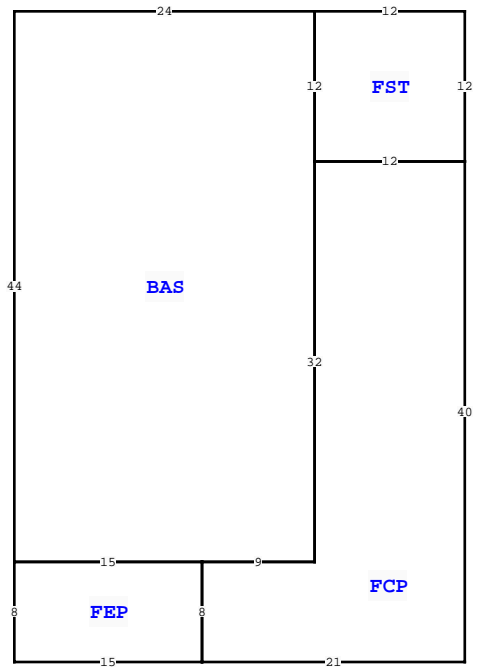

COLUMBIA COUNTY PROPERTY		PAGE 1 of 1	2
VALUATION SUMMARY			
VALUATION BY			STANDARD
Tax Group: 2		Tax Dist:	
BUILDING MARKET VALUE			38,379
TOTAL MARKET OB/XF VALUE			1,000
TOTAL LAND VALUE - MARKET			22,500
TOTAL MARKET VALUE			61,879
SOH/AGL Deduction			30,745
ASSESSED VALUE			31,134
TOTAL EXEMPTION VALUE	HX HB WR		30,000
BASE TAXABLE VALUE			1,134
TOTAL JUST VALUE			61,879
NCON VALUE			0
INCOME VALUE			
PREVIOUS YEAR MKT VALUE			61,879

PERMIT NUM	DESCRIPTION	AMT	ISSUED

SALES DATA						
OFF RECORD Number	DATE	TYPE INST	Q / U	V / I	RSN CD	SALE PRICE
1469/2154	6/13/2022	LE	U	I	14	100
GRANTOR: JOHNS LONNIE RAY SR						
GRANTEE: JOHNS LONNIE RAY SR						
0925/0782	4/23/2001	WD	Q	I		49,500
GRANTOR: JAMES M & DIANE R PAR						
GRANTEE: LONNIE R & PATRICIA						

EXTRA FEATURES		TOTAL OB/XF	
L N	OB/XF CODE	DESCRIPTION	ADJ UNIT PRICE
1	0166	CONC, PAVMT	0.00
2	0080	DECKING	0.00
3	0166	CONC, PAVMT	0.00

BLD DATE	XF DATE	INC DATE	LGL DATE	LAND DATE	AG DATE
			04/21/2023		

BUILDING NOTES	

BUILDING DIMENSIONS	
BAS= W24 S44 FEP= S8 E15 N8 W15 E15 FCP= S8 E21 N40 W12 S32 W9 E9 N32 FST= E12 N12 W12 S12 N12 S.	

LAND DESCRIPTION										TOTAL OB/XF														
L N	USE CODE	CLS	LAND USE DESCRIPTION	CAP	R D	LOC ZONE	FRONT	DEPTH	TOT LND UTS	UNIT TYPE	D T	DPH FACT	% COND	TOT ADJ	UNIT PRICE	ADJ UNIT PRICE	LAND VALUE	OTHER ADJUSTMENTS AND NOTES	YEAR	DENSITY	DECL	FRZ	YR	CONSRV
1	0200	C	MBL HM	100		RSF/MH	0.00	0.00	1.00	LT		1.00	1.00	1.00	22,500.00	22,500.00	22,500							