

| BUILDING CHARACTERISTICS | | CONSTRUCTION | |
|--------------------------|------------------|--------------|---------------|
| ELEMENT | CD | | |
| Exterior Wall | 19 | COMMON BRK | 100 |
| Roof Structur | 03 | GABLE/HIP | 100 |
| Roof Cover | 03 | COMP SHNGL | 100 |
| Interior Wall | 05 | DRYWALL | 100 |
| Interior Floor | 14 | CARPET | 90 |
| Interior Floor | 06 | VINYL ASB | 10 |
| Air Condition | 01 | NONE | 100 |
| Heating Type | 04 | AIR DUCTED | 100 |
| Bedrooms | | 3 | 100 |
| Bathrooms | | 2 | 100 |
| Frame | 01 | NONE | 100 |
| Stories | 1. | 1. | 100 |
| Architectual | 05 | CONV | 100 |
| Units | | 0 | 100 |
| Condition Adj | 03 | 03 | 100 |
| Kitchen Adjus | 01 | 01 | 100 |
| Quality | 05 | 05 | |
| DOR CODE | 5000 | IMPROVED | AG |
| MAP NUM | | MKT AREA | 03 |
| NEIGHBORHOOD/LOC | 33216.00 | 1.00/ | |
| AREA TYPE | TOTAL GROSS AREA | PCT OF BASE | YEAR |
| BAS | 418 | 100 | |
| BAS | 1,596 | 100 | |
| FOP | 288 | 30 | |
| TOTALS | 2,302 | | 2,100 156,456 |

| MARKET ADJUSTMENTS | | | | | | | | | | | | | | |
|--|-----|-----------|-------------|----------------|----------------|------|------|------|------|------|--------|-------|--|--|
| TYPE | MDL | EFF. AREA | TOT ADJ PTS | EFF. BASE RATE | REPL. COST NEW | AYB | EYB | ECON | FNCT | NORM | % COND | | | |
| 0100 | 01 | 2,100 | 102.3350 | 114.62 | 240,702 | 1972 | 1972 | 0 | 0 | 0 | 35.00 | 65.00 | | |
| 1 SINGLE FAM 100% - 0 Heated Area: 2014 HX Base Yr | | | | | | | | | | | | | | |

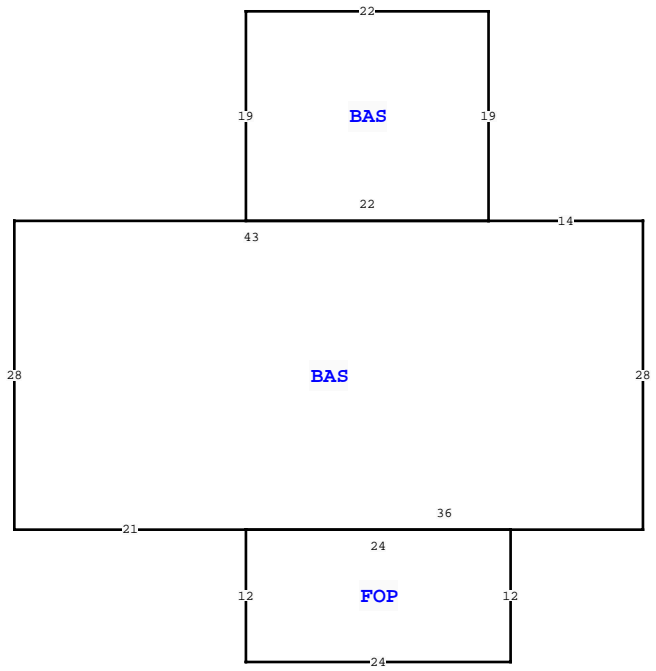

| COLUMBIA COUNTY PROPERTY | | PAGE 1 of 2 | 3 |
|---------------------------|--|--------------|---|
| VALUATION SUMMARY | | | |
| VALUATION BY | | STANDARD | |
| Tax Group: 3 | | Tax Dist: | |
| BUILDING MARKET VALUE | | 212,863 | |
| TOTAL MARKET OB/XF VALUE | | 42,946 | |
| TOTAL LAND VALUE - MARKET | | 167,800 | |
| TOTAL MARKET VALUE | | 284,086 | |
| SOH/AGL Deduction | | 74,777 | |
| ASSESSED VALUE | | 209,309 | |
| TOTAL EXEMPTION VALUE | | HX HB 51,411 | |
| BASE TAXABLE VALUE | | 157,898 | |
| TOTAL JUST VALUE | | 423,609 | |
| NCON VALUE | | 0 | |
| INCOME VALUE | | | |
| PREVIOUS YEAR MKT VALUE | | 426,212 | |

| PERMIT NUM | DESCRIPTION | AMT | ISSUED |
|------------|-------------|-----|------------|
| 40062 | ELECTRICAL | 0 | 06/29/2020 |
| 39957 | ELECTRICAL | 0 | 06/16/2020 |
| 30353 | M H | 371 | 08/07/2012 |
| 14372 | M H | 125 | 08/07/1998 |

| SALES DATA | | | | | | |
|-------------------|------------|-----------|-----|-----|--------|------------|
| OFF RECORD Number | DATE | TYPE INST | Q U | V I | RSN CD | SALE PRICE |
| 1456/52 | 12/13/2021 | LE U | | I | 14 | 100 |

GRANTOR: HALL DONALD D (ENH LE)
GRANTEE: HALL LARRY F (RMDR)

| BUILDING NOTES | |
|--|--|
| | |
| BUILDING DIMENSIONS | |
| BAS= W14 BAS= N19 W22 S19 E22\$ W43 S28 E21 FOP= S12 E24N12 W24\$ E36 N28\$. | |

| EXTRA FEATURES | | | | | | | | | | | | | | TOTAL OB/XF | | 21,946 | |
|----------------|------------|-------------|-----|-----|----|----|--------|----|----------|----------------|-----------|---------|-------------|-------------|--------|-----------------|-------|
| L N | OB/XF CODE | DESCRIPTION | BLD | CAP | L | W | UNITS | UT | Adj R | ADJ UNIT PRICE | ORIG COND | YEAR ON | YEAR ACTUAL | Q | % COND | OB/XF MKT VALUE | NOTES |
| 1 | 0166 | CONC, PAVMT | 0 | 100 | 0 | 0 | 1.00 | UT | 0.00 | 0.00 | 100 | 1995 | 1995 | 3 | 100 | 300 | |
| 2 | 0040 | BARN, POLE | 0 | 100 | 8 | 20 | 1.00 | UT | 0.00 | 0.00 | 100 | 1995 | 1995 | 3 | 100 | 100 | |
| 3 | 0040 | BARN, POLE | 0 | 100 | 0 | 0 | 1.00 | UT | 0.00 | 0.00 | 100 | 1995 | 1995 | 3 | 100 | 250 | |
| 4 | 0190 | FPLC PF | 0 | 100 | 0 | 0 | 1.00 | UT | 1,200.00 | 1,200.00 | 100 | 1996 | 1996 | 3 | 100 | 1,200 | |
| 5 | 0294 | SHED WOOD/ | 0 | 100 | 12 | 24 | 288.00 | UT | 14.00 | 14.00 | 100 | 2008 | 2008 | 3 | 100 | 4,032 | |
| 6 | 9947 | Septic | 0 | 100 | 0 | 0 | 2.00 | UT | 3,000.00 | 3,000.00 | 100 | | | 3 | 100 | 6,000 | |
| 7 | 0251 | LEAN TO W/ | 0 | 100 | 10 | 24 | 240.00 | UT | 5.00 | 5.00 | 100 | 2008 | 2008 | 3 | 100 | 1,200 | |
| 8 | 9945 | Well/Sept | 0 | 0 | 0 | 0 | 1.00 | UT | 7,000.00 | 7,000.00 | 100 | | | 3 | 100 | 7,000 | |
| 9 | 0166 | CONC, PAVMT | 0 | 100 | 12 | 24 | 288.00 | UT | 3.00 | 3.00 | 100 | 2008 | 2008 | 3 | 100 | 864 | |
| 10 | 0285 | SALVAGE | 0 | 100 | 0 | 0 | 1.00 | UT | 0.00 | 0.00 | 100 | 2008 | 2008 | 3 | 100 | 1,000 | |

| LAND DESCRIPTION | | | | | | | | | | | | | | TOTAL OB/XF | | | | | | | | | | 21,946 | |
|------------------|----------|-----|----------------------|-----|-----|----------|-------|-------|-------------|-----------|-----|-----------|--------|-------------|------------|----------------|------------|-----------------------------|------|---------|------|-----|----|--------|--|
| L N | USE CODE | CLS | LAND USE DESCRIPTION | CAP | R D | LOC ZONE | FRONT | DEPTH | TOT LND UTS | UNIT TYPE | D T | DPHT FACT | % COND | TOT ADJ | UNIT PRICE | ADJ UNIT PRICE | LAND VALUE | OTHER ADJUSTMENTS AND NOTES | YEAR | DENSITY | DECL | FRZ | YR | CONSRV | |
| 1 | 0100 | C | SFR | 100 | | A-1 | 0.00 | 0.00 | 1.00 | AC | | 1.00 | 1.00 | 1.00 | 5,000.00 | 5,000.00 | 5,000 | | | | | | | | |
| 2 | 0200 | C | MBL HM | 0 | | 00 | 0.00 | 0.00 | 1.00 | AC | | 1.00 | 1.00 | 1.00 | 5,000.00 | 5,000.00 | 5,000 | | | | | | | | |
| 3 | 0200 | C | MBL HM | 0 | | 00 | 0.00 | 0.00 | 1.00 | AC | | 1.00 | 1.00 | 1.00 | 5,000.00 | 5,000.00 | 5,000 | | | | | | | | |
| 4 | 0200 | C | MBL HM | 0 | | 00 | 0.00 | 0.00 | 1.00 | AC | | 1.00 | 1.00 | 1.00 | 5,000.00 | 5,000.00 | 5,000 | | | | | | | | |
| 5 | 6200 | A | PASTURE 3 | 0 | | 00 | 0.00 | 0.00 | 29.56 | AC | | 1.00 | 1.00 | 1.00 | 280.00 | 280.00 | 8,277 | | | | | | | | |
| 6 | 9910 | M | MKT. VAL. AG | 0 | | A-1 | 0.00 | 0.00 | 29.56 | AC | | 1.00 | 1.00 | 1.00 | 5,000.00 | 5,000.00 | 147,800 | | | | | | | | |

