

COMM NW COR OF SEC, S 991.50 FT,
POB, CONT E 150 FT, S 290.71 FT
W ALONG R/W 179.51 FT, N 240.71

JOHNSON MARISOL
141 SW ARROWHEAD TER
LAKE CITY, FL 32024

2026

30-4S-17-08885-004

| BUILDING CHARACTERISTICS | | CONSTRUCTION | |
|--------------------------|-------------------------|--------------|------|
| ELEMENT | CD | | |
| Exterior Wall | 17 | MSNRY STUC | 100 |
| Roof Structur | 03 | GABLE/HIP | 100 |
| Roof Cover | 03 | COMP SHNGL | 100 |
| Interior Wall | 05 | DRYWALL | 100 |
| Interior Floo | 14 | CARPET | 80 |
| Interior Floo | 08 | SHT VINYL | 20 |
| Air Condition | 03 | CENTRAL | 100 |
| Heating Type | 04 | AIR DUCTED | 100 |
| Fixtures | | 6 | 100 |
| Frame | 02 | WOOD FRAME | 100 |
| Story Height | | 8 | 100 |
| RMS | | 7 | 100 |
| Stories | 0 | 0 | 100 |
| Units | | 0 | 100 |
| Condition Adj | 02 | 02 | 100 |
| Quality | 04 | 04 | |
| DOR CODE | 7200 PRVT SCHL/DAY CARE | | |
| MAP NUM | | MKT AREA | 06 |
| NEIGHBORHOOD/LOC | 30417.00 1.00/ | | |
| AREA TYPE | TOTAL GROSS AREA | PCT OF BASE | YEAR |
| BAS | 5,940 | 100 | |
| FOP | 136 | 30 | |
| UCP | 270 | 20 | |
| TOTALS | 6,346 | | |

| MARKET ADJUSTMENTS | | | | | | | | | | | | | |
|--|-----|-----------|-------------|----------------|----------------|------|------|------|------|-------|--------|--|--|
| TYPE | MDL | EFF. AREA | TOT ADJ PTS | EFF. BASE RATE | REPL. COST NEW | AYB | EYB | ECON | FNCT | NORM | % COND | | |
| 0700 | 04 | 6,035 | 69.2913 | 45.73 | 275,981 | 1970 | 1970 | 0 | 0 | 50.00 | 50.00 | | |
| 1 DAY CARE 0% - 0 Heated Area: 5940 HX Base Yr | | | | | | | | | | | | | |

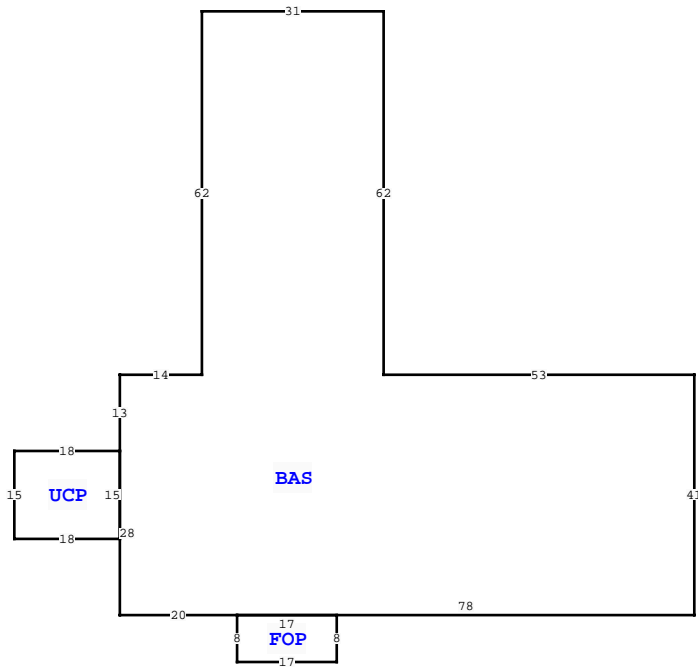

| COLUMBIA COUNTY PROPERTY | | | |
|---------------------------|-----------|----------|-------------|
| VALUATION SUMMARY | | | PAGE 1 of 1 |
| VALUATION BY | | STANDARD | |
| Tax Group: 2 | Tax Dist: | | |
| BUILDING MARKET VALUE | | | 137,990 |
| TOTAL MARKET OB/XF VALUE | | | 3,000 |
| TOTAL LAND VALUE - MARKET | | | 174,600 |
| TOTAL MARKET VALUE | | | 315,590 |
| SOH/AGL Deduction | | | 14,706 |
| ASSESSED VALUE | | | 300,884 |
| TOTAL EXEMPTION VALUE | | | 0 |
| BASE TAXABLE VALUE | | | 300,884 |
| TOTAL JUST VALUE | | | 315,590 |
| NCON VALUE | | | 0 |
| INCOME VALUE | | | |
| PREVIOUS YEAR MKT VALUE | | | 273,531 |

| PERMIT NUM | DESCRIPTION | AMT | ISSUED |
|------------|-------------|-----|------------|
| 27047 | MAINT/ALTR | 30 | 05/28/2008 |

| SALES DATA | | | | | | |
|-------------------|-----------|-----------|-------|-------|--------|------------|
| OFF RECORD Number | DATE | TYPE INST | Q / U | V / I | RSN CD | SALE PRICE |
| 1395/1327 | 9/19/2019 | TR | U | I | 17 | 382,200 |

GRANTOR: JULIA BYRD, BILL HUNT
GRANTEE: MARISOL JOHNSON

| BLD DATE | | LGL DATE | |
|----------|----------|------------|---------|
| XF DATE | INC DATE | LAND DATE | AG DATE |
| | | 05/18/2026 | MLU |

| BUILDING NOTES | |
|--|--|
| BUILDING DIMENSIONS | |
| BAS= W53 N62 W31 S62 W14 S13 UCP= W18 S15 E18 N15\$ S28 E20FOP= S8 E17 N8 W17\$ E78 N41\$. | |

| EXTRA FEATURES | | | | | | | | | | | | | | | | |
|----------------|------------|-------------|---------|---|---|-------|----|-------|----------------|-----------|---------|-------------|---|--------|-----------------|-------|
| L N | OB/XF CODE | DESCRIPTION | BLD CAP | L | W | UNITS | UT | Adj R | ADJ UNIT PRICE | ORIG COND | YEAR ON | YEAR ACTUAL | Q | % COND | OB/XF MKT VALUE | NOTES |
| 1 | 0166 | CONC, PAVMT | 0 | 0 | 0 | 1.00 | UT | 0.00 | 0.00 | 100 | 2017 | 2017 | 3 | 100 | 1,500 | |
| 2 | 0169 | FENCE/WOOD | 0 | 0 | 0 | 1.00 | UT | 0.00 | 0.00 | 100 | 2017 | 2017 | 3 | 100 | 1,500 | |

| LAND DESCRIPTION | | | | | | | | | | | | | | TOTAL OB/XF | | | | | | | | | | |
|------------------|----------|-----|----------------------|-----|-----|----------|--------|--------|-------------|-----------|-----|----------|--------|-------------|------------|----------------|------------|-----------------------------|------|---------|------|-----|----|--------|
| L N | USE CODE | CLS | LAND USE DESCRIPTION | CAP | R D | LOC ZONE | FRONT | DEPTH | TOT LND UTS | UNIT TYPE | D T | DPH FACT | % COND | TOT ADJ | UNIT PRICE | ADJ UNIT PRICE | LAND VALUE | OTHER ADJUSTMENTS AND NOTES | YEAR | DENSITY | DECL | FRZ | YR | CONSRV |
| 1 | 7200 | C | SCHOOL PRI | 0 | | CHI | 150.00 | 291.00 | 43,650.00 | SF | | 1.00 | 1.00 | 0.80 | 5.00 | 4.00 | 174,600 | | | | | | | |