

BUILDING CHARACTERISTICS					
ELEMENT	CD CONSTRUCTION				
Exterior Wall	31 VINYL SID 100				
Roof Structur	03 GABLE/HIP 100				
Roof Cover	03 COMP SHNGL 100				
Interior Wall	05 DRYWALL 100				
Interior Floo	14 CARPET 90				
Interior Floo	08 SHT VINYL 10				
Air Condition	03 CENTRAL 100				
Heating Type	04 AIR DUCTED 100				
Bedrooms	3 100				
Bathrooms	2 100				
Stories	1. 1. 100				
Architctual Units	01 CONV 100 0 100				
Quality	04 04				
DOR CODE	0200 MOBILE HOME				
MAP NUM	MKT AREA 06				
NEIGHBORHOOD/LOC	30317.00 1.00/				
AREA TYPE	TOTAL GROSS AREA	PCT OF BASE	YEAR	TOT ADJ AREA	SUBAREA MARKET VALUE
BAS	1,548	100		1,548	86,596
TOTALS	1,548			1,548	86,596

MARKET ADJUSTMENTS											
TYPE	MDL	EFF. AREA	TOT ADJ PTS	EFF. BASE RATE	REPL. COST NEW	AYB	EYB	ECON	FNCT	NORM	% COND
1	MANUF	1	100% - 2011								
Heated Area: 1548						HX Base Yr 2011					

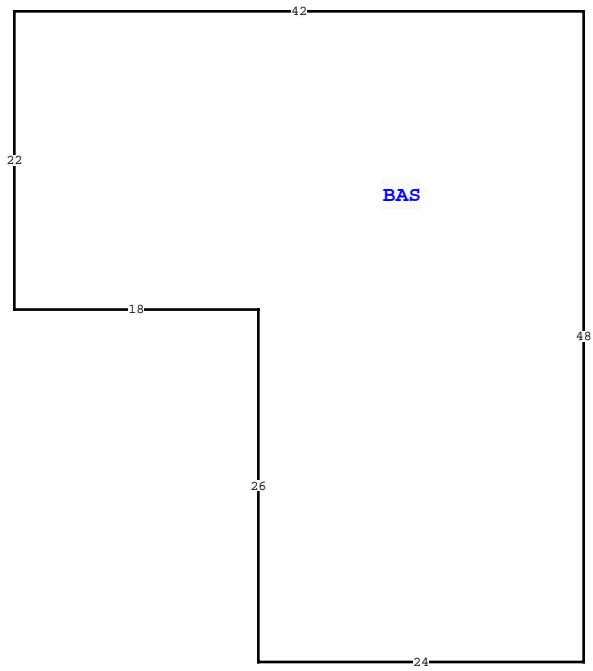

COLUMBIA COUNTY PROPERTY		PAGE 1 of 1	2
VALUATION SUMMARY			
VALUATION BY			STANDARD
Tax Group: 2		Tax Dist:	
BUILDING MARKET VALUE			86,596
TOTAL MARKET OB/XF VALUE			100
TOTAL LAND VALUE - MARKET			5,100
TOTAL MARKET VALUE			91,796
SOH/AGL Deduction			63,014
ASSESSED VALUE			28,782
TOTAL EXEMPTION VALUE	HX HB		25,000
BASE TAXABLE VALUE			3,782
TOTAL JUST VALUE			91,796
NCON VALUE			0
INCOME VALUE			
PREVIOUS YEAR MKT VALUE			91,796

PERMIT NUM	DESCRIPTION	AMT	ISSUED

SALES DATA						
OFF RECORD Number	DATE	TYPE INST	Q U	V I	RSN CD	SALE PRICE

BUILDING NOTES	

BUILDING DIMENSIONS	
BAS=	W42 S22 E18 S26 E24 N48\$.

EXTRA FEATURES																
L N	OB/XF CODE	DESCRIPTION	BLD CAP	L	W	UNITS	UT	Adj R	ADJ UNIT PRICE	ORIG COND	YEAR ON	YEAR ACTUAL	Q	% COND	OB/XF MKT VALUE	NOTES
1	0070	CARPOT UF	0	100	0	0			1.00	UT	0.00				0.00	
2	0296	SHED METAL	0	100	0	0			1.00	UT	0.00				0.00	

LAND DESCRIPTION															TOTAL OB/XF									
L N	USE CODE	CLS	LAND USE DESCRIPTION	CAP	R D	LOC ZONE	FRONT	DEPTH	TOT LND UTS	UNIT TYPE	D T	DPHT FACT	% COND	TOT ADJ	UNIT PRICE	ADJ UNIT PRICE	LAND VALUE	OTHER ADJUSTMENTS AND NOTES	YEAR	DENSITY	DECL	FRZ	YR	CONSRV
1	0200	C	MBL HM	100		00	0.00	0.00	0.34	AC		1.00	1.00	1.00	15,000.00	15,000.00	5,100							