

N1/4 OF W1/4 OF W1/2 OF NE1/4 OF
NW1/4 OF NW1/4 AS LIES E OF BOOK
COMBS RD, AKA OLD WHITE SPRINGS

CONNER LYNDA N
P O BOX 115
WHITE SPRINGS, FL 32096-0115

2026

30-2S-16-01788-008



| BUILDING CHARACTERISTICS | | CONSTRUCTION | |
|--------------------------|------------------|--------------|------|
| ELEMENT | CD | | |
| Exterior Wall | 31 | VINYL SID | 100 |
| Roof Structur | 03 | GABLE/HIP | 100 |
| Roof Cover | 12 | MODULAR MT | 100 |
| Interior Wall | 04 | PLYWOOD | 100 |
| Interior Floor | 14 | CARPET | 90 |
| Interior Floor | 08 | SHT VINYL | 10 |
| Air Condition | 03 | CENTRAL | 100 |
| Heating Type | 04 | AIR DUCTED | 100 |
| Bedrooms | | 3 | 100 |
| Bathrooms | | 2 | 100 |
| Stories | 1. | 1. | 100 |
| Architectual | 01 | CONV | 100 |
| Units | | 0 | 100 |
| Condition Adj | 03 | 03 | 100 |
| Kitchen Adjus | 01 | 01 | 100 |
| Quality | 05 | 05 | |
| DOR CODE | 0200 MOBILE HOME | | |
| MAP NUM | | MKT AREA | 03 |
| NEIGHBORHOOD/LOC | 30216.00 1.00/ | | |
| AREA TYPE | TOTAL GROSS AREA | PCT OF BASE | YEAR |
| BAS | 1,768 | 100 | |
| FSP | 206 | 40 | |
| FSP | 270 | 40 | |
| TOTALS | 2,244 | | |

| MARKET ADJUSTMENTS | | | | | | | | | | | |
|--------------------|------------|-----------|-------------------|----------------|----------------|------------|-----|------|------|------|--------|
| TYPE | MDL | EFF. AREA | TOT ADJ PTS | EFF. BASE RATE | REPL. COST NEW | AYB | EYB | ECON | FNCT | NORM | % COND |
| 1 | MOBILE HME | 0% | - 2026 | | | | | | | | |
| | | | Heated Area: 1768 | | | HX Base Yr | | | | | |

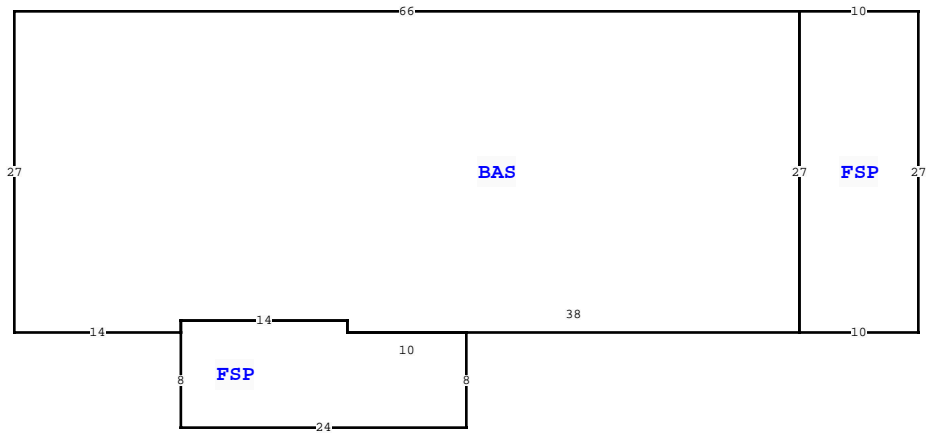

| COLUMBIA COUNTY PROPERTY | | | | PAGE 1 of 1 | 3 | |
|--|-------------|-----------|--------|-------------|--------|------------|
| VALUATION SUMMARY | | | | | | |
| VALUATION BY | | | | STANDARD | | |
| Tax Group: 3 | | | | Tax Dist: | | |
| BUILDING MARKET VALUE | | | | 53,994 | | |
| TOTAL MARKET OB/XF VALUE | | | | 20,860 | | |
| TOTAL LAND VALUE - MARKET | | | | 31,000 | | |
| TOTAL MARKET VALUE | | | | 105,854 | | |
| SOH/AGL Deduction | | | | 0 | | |
| ASSESSED VALUE | | | | 105,854 | | |
| TOTAL EXEMPTION VALUE | | | | 0 | | |
| BASE TAXABLE VALUE | | | | 105,854 | | |
| TOTAL JUST VALUE | | | | 105,854 | | |
| NCON VALUE | | | | 0 | | |
| INCOME VALUE | | | | 0 | | |
| PREVIOUS YEAR MKT VALUE | | | | 98,104 | | |
| SALE:2:1: AERIAL SHOWS NO IMPROVEMENTS | | | | | | |
| XFOB:1:1: CONCORD M H | | | | | | |
| SALE:1:1: 3.10 ACRES WITH IMP | | | | | | |
| PERMIT NUM | DESCRIPTION | AMT | ISSUED | | | |
| SALES DATA | | | | | | |
| OFF RECORD Number | DATE | TYPE INST | Q / U | V / I | RSN CD | SALE PRICE |
| 0880/0985 | 5/10/1999 | WD | Q | I | | 45,000 |
| GRANTOR: BOARDMAN | | | | | | |
| GRANTEE: CONNER | | | | | | |
| 0802/2379 | 3/14/1995 | WD | Q | I | | 38,000 |
| GRANTOR: ROBERT J & NAOMI R DU | | | | | | |
| GRANTEE: DONALD E & SARAH M | | | | | | |
| BUILDING NOTES | | | | | | |
| BUILDING DIMENSIONS | | | | | | |
| BAS= W66 S27 E14 FSP= S8 E24N8 W10 N1 W14 S1\$ N1 E14 S1 E38 FSP= E10 N27 W10 S27\$ N27\$. | | | | | | |

| EXTRA FEATURES | | | | | | | | | | | | | | | | | |
|----------------|------------|-------------|-----|-----|----|----|--------|----|-----------|----------------|-----------|---------|-------------|---|--------|-----------------|-------|
| L N | OB/XF CODE | DESCRIPTION | BLD | CAP | L | W | UNITS | UT | Adj R | ADJ UNIT PRICE | ORIG COND | YEAR ON | YEAR ACTUAL | Q | % COND | OB/XF MKT VALUE | NOTES |
| 1 | 0294 | SHED WOOD/ | 0 | 0 | 10 | 12 | 1.00 | UT | 0.00 | 0.00 | 100 | 1993 | 1993 | 3 | 100 | 500 | |
| 2 | 0294 | SHED WOOD/ | 0 | 0 | 10 | 12 | 1.00 | UT | 0.00 | 0.00 | 100 | 1993 | 1993 | 3 | 100 | 500 | |
| 3 | 9945 | Well/Sept | 0 | 0 | 0 | 0 | 1.00 | UT | 7,000.00 | 7,000.00 | 100 | | | 3 | 100 | 7,000 | |
| 4 | 0070 | CARPORT UF | 0 | 0 | 20 | 24 | 480.00 | UT | 3.50 | 3.50 | 100 | 1993 | 1993 | 3 | 100 | 1,680 | |
| 5 | 0261 | PRCH, UOP | 0 | 0 | 0 | 0 | 1.00 | UT | 0.00 | 0.00 | 100 | 1993 | 1993 | 3 | 100 | 480 | |
| 6 | 0060 | CARPORT F | 0 | 0 | 0 | 0 | 1.00 | UT | 0.00 | 0.00 | 100 | 2013 | 2013 | 3 | 100 | 700 | |
| 7 | 0030 | BARN,MT | 0 | 0 | 0 | 0 | 1.00 | UT | 10,000.00 | 10,000.00 | 100 | 2023 | 2022 | | 100 | 10,000 | |
| TOTAL OB/XF | | | | | | | | | | | | | | | 20,860 | | |

| LAND DESCRIPTION | | | | | | | | | | | | | | | | | | | | | | | | |
|------------------|----------|-----|----------------------|-----|-----|----------|-------|-------|-------------|-----------|-----|----------|--------|---------|------------|----------------|------------|-----------------------------|------|---------|------|-----|----|--------|
| L N | USE CODE | CLS | LAND USE DESCRIPTION | CAP | R D | LOC ZONE | FRONT | DEPTH | TOT LND UTS | UNIT TYPE | D T | DPH FACT | % COND | TOT ADJ | UNIT PRICE | ADJ UNIT PRICE | LAND VALUE | OTHER ADJUSTMENTS AND NOTES | YEAR | DENSITY | DECL | FRZ | YR | CONSRV |
| 1 | 0200 | C | MBL HM | 0 | | 00 | 0.00 | 0.00 | 3.10 | AC | | 1.00 | 1.00 | 1.00 | 10,000.00 | 10,000.00 | 31,000 | | | | | | | |