

| BUILDING CHARACTERISTICS | |
|--------------------------|------------------------|
| ELEMENT | CD |
| Exterior Wall | 05 AVERAGE 100 |
| Roof Structur | 03 GABLE/HIP 100 |
| Roof Cover | 12 MODULAR MT 100 |
| Interior Wall | 02 WALL BD/WD 50 |
| Interior Wall | 05 DRYWALL 50 |
| Interior Floo | 14 CARPET 90 |
| Interior Floo | 08 SHT VINYL 10 |
| Air Condition | 02 WINDOW 100 |
| Heating Type | 02 CONVECTION 100 |
| Bedrooms | 3 100 |
| Bathrooms | 1.5 100 |
| Frame | 01 NONE 100 |
| Stories | 1.5 100 |
| Architectual | 05 CONV 100 |
| Units | 0 100 |
| Condition Adj | 03 03 100 |
| Kitchen Adjus | 01 01 100 |
| Quality | 05 05 |
| DOR CODE | 0102 SFRES/MOBILE HOME |
| MAP NUM | MKT AREA 02 |
| NEIGHBORHOOD/LOC | 28417.00 1.00/ |
| AREA TYPE | TOTAL GROSS AREA |
| BAS | 150 100 |
| BAS | 1,098 100 |
| FOP | 63 30 |
| FSP | 56 40 |
| FSP | 198 40 |
| FSP | 316 40 |
| FST | 72 55 |
| UCP | 180 20 |
| UST | 56 45 |
| UST | 120 45 |
| TOTALS | 2,309 1,649 123,809 |

| MARKET ADJUSTMENTS | | | | | | | | | | | | | |
|--|-----|-----------|-------------|----------------|----------------|------|------|------|------|-------|--------|--|--|
| TYPE | MDL | EFF. AREA | TOT ADJ PTS | EFF. BASE RATE | REPL. COST NEW | AYB | EYB | ECON | FNCT | NORM | % COND | | |
| 0100 | 01 | 1,649 | 103.1373 | 115.51 | 190,476 | 1963 | 1963 | 0 | 0 | 35.00 | 65.00 | | |
| 1 SINGLE FAM 100% - 0 Heated Area: 1248 HX Base Yr | | | | | | | | | | | | | |

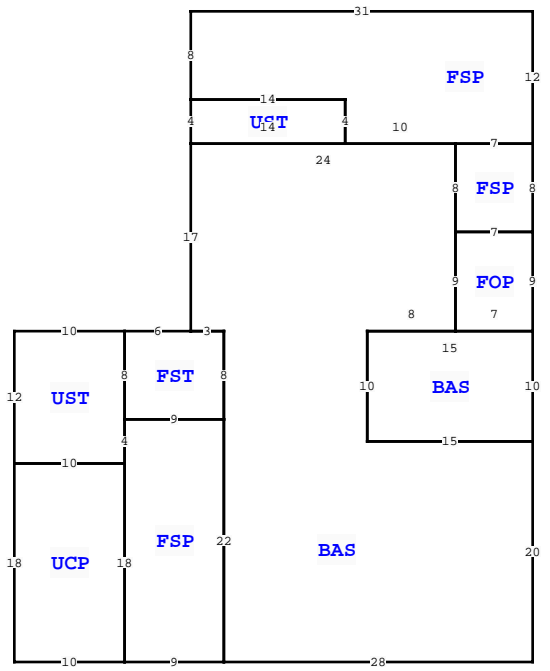

| COLUMBIA COUNTY PROPERTY | | | |
|---------------------------|-----------|--------|-------------|
| VALUATION SUMMARY | | | PAGE 1 of 2 |
| VALUATION BY | | | STANDARD |
| Tax Group: 2 | Tax Dist: | | |
| BUILDING MARKET VALUE | | | 229,808 |
| TOTAL MARKET OB/XF VALUE | | | 10,700 |
| TOTAL LAND VALUE - MARKET | | | 21,060 |
| TOTAL MARKET VALUE | | | 261,568 |
| SOH/AGL Deduction | | | 141,919 |
| ASSESSED VALUE | | | 119,649 |
| TOTAL EXEMPTION VALUE | HX HB | 42,245 | |
| BASE TAXABLE VALUE | | | 77,404 |
| TOTAL JUST VALUE | | | 261,568 |
| NCON VALUE | | | 0 |
| INCOME VALUE | | | |
| PREVIOUS YEAR MKT VALUE | | | 256,888 |

| PERMIT NUM | DESCRIPTION | AMT | ISSUED |
|------------|-------------|-----|------------|
| 13889 | M H | 125 | 04/13/1998 |

| SALES DATA | | | | | | |
|------------------------------|-----------|-----------|-----|-----|--------|------------|
| OFF RECORD Number | DATE | TYPE INST | Q U | V I | RSN CD | SALE PRICE |
| 1470/739 | 7/01/2022 | QC | U | I | 11 | 100 |
| GRANTOR: WATKINS CARLTON D | | | | | | |
| GRANTEE: WATKINS CARLTON D | | | | | | |
| 1336/0625 | 5/04/2017 | WD | U | I | 11 | 100 |
| GRANTOR: EVELYN WATKINS | | | | | | |
| GRANTEE: EVELYN & RUFUS CARL | | | | | | |

| EXTRA FEATURES | | | | | | | | | | | | | | | | |
|----------------|------------|-------------|---------|-----|---|-------|----|----------|----------------|-----------|---------|-------------|---|--------|-----------------|-------|
| L N | OB/XF CODE | DESCRIPTION | BLD CAP | L | W | UNITS | UT | Adj R | ADJ UNIT PRICE | ORIG COND | YEAR ON | YEAR ACTUAL | Q | % COND | OB/XF MKT VALUE | NOTES |
| 1 | 0021 | BARN, FR AE | 0 | 100 | 0 | 0 | 0 | 0 | 0.00 | 100 | 0 | 0 | 3 | 100 | 500 | |
| 2 | 0120 | CLFENCE 4 | 0 | 100 | 0 | 0 | 0 | 0 | 0.00 | 100 | 2012 | 2012 | 3 | 100 | 400 | |
| 3 | 9945 | Well/Sept | 0 | 0 | 0 | 0 | 0 | 7,000.00 | 7,000.00 | 100 | | | 3 | 100 | 7,000 | |
| 4 | 0190 | FPLC PF | 0 | 100 | 0 | 0 | 0 | 1,200.00 | 1,200.00 | 100 | 2017 | 2017 | 3 | 100 | 1,200 | |
| 5 | 0296 | SHED METAL | 0 | 100 | 0 | 0 | 0 | 0.00 | 0.00 | 100 | 2017 | 2017 | 3 | 100 | 1,200 | |
| 6 | 0294 | SHED WOOD/ | 0 | 100 | 0 | 0 | 0 | 0.00 | 0.00 | 100 | 2017 | 2017 | 3 | 100 | 400 | |

| BUILDING NOTES | | | |
|----------------|--|----------------|--|
| BLD DATE | | | |
| XF DATE | | | |
| INC DATE | | | |
| LGL DATE | | 05/08/2026 MLU | |
| LAND DATE | | | |
| AG DATE | | | |

| BUILDING DIMENSIONS | | | |
|--|--|--|--|
| BAS= W24 S17 FST= W6 S8 E9 N8 W3\$ E3 S8 FSP= W9 UST= N8 W10 S12 E10 N4\$ S4 UCP= W10 S18 E10 N18\$ S18 E9 N22\$ S22 E28 N20 BAS= N10 W15 S10 E15\$ W15 N10 E8 FOP= E7 N9 W7 S9\$ N9 FSP= E7 N8 W7 S8\$ N8 FSP= E7 N12 W31 S8 UST= S4 E14 N4 W14\$ E14 S4 E10\$. | | | |

| LAND DESCRIPTION | | | | | | | | | | | | | | TOTAL OB/XF | | | | | | | | | | |
|------------------|----------|-----|----------------------|-----|-----|----------|-------|-------|-------------|-----------|-----|-----------|--------|-------------|------------|----------------|------------|-----------------------------|------|---------|------|-----|----|--------|
| L N | USE CODE | CLS | LAND USE DESCRIPTION | CAP | R D | LOC ZONE | FRONT | DEPTH | TOT LND UTS | UNIT TYPE | D T | DPTH FACT | % COND | TOT ADJ | UNIT PRICE | ADJ UNIT PRICE | LAND VALUE | OTHER ADJUSTMENTS AND NOTES | YEAR | DENSITY | DECL | FRZ | YR | CONSRV |
| 1 | 0100 | C | SFR | 100 | | A-1 | 0.00 | 0.00 | 1.17 | AC | | 1.00 | 1.00 | 1.00 | 18,000.00 | 18,000.00 | 21,060 | | | | | | | |

