

COMM AT NW COR OF E1/2 OF NE 1/4  
1652.99 FT FOR POB, N 72 DEG E 7  
S 636.46 FT, S 72 DEG W 719.49 F

BELL JACQUELINE S/BELL JASON C  
190 NW PAPS CT  
LAKE CITY, FL 32055

2026

27-2S-16-01754-002



| BUILDING CHARACTERISTICS |                  | CONSTRUCTION |              |
|--------------------------|------------------|--------------|--------------|
| ELEMENT                  | CD               |              |              |
| Exterior Wall            | 31               | VINYL SID    | 100          |
| Roof Structur            | 03               | GABLE/HIP    | 100          |
| Roof Cover               | 14               | PREFIN MT    | 100          |
| Interior Wall            | 05               | DRYWALL      | 100          |
| Interior Floo            | 09               | PINE WOOD    | 100          |
| Air Condition            | 03               | CENTRAL      | 100          |
| Heating Type             | 04               | AIR DUCTED   | 100          |
| Bedrooms                 |                  | 3            | 100          |
| Bathrooms                |                  | 2            | 100          |
| Stories                  | 1.               | 1.           | 100          |
| Architectual             | 01               | CONV         | 100          |
| Units                    |                  | 0            | 100          |
| Quality                  | 03               | 03           |              |
| DOR CODE                 | 5000             | IMPROVED AG  |              |
| MAP NUM                  |                  | MKT AREA     | 03           |
| NEIGHBORHOOD/LOC         | 27216.00         | 1.00/        |              |
| AREA TYPE                | TOTAL GROSS AREA | PCT OF BASE  | YEAR         |
| BAS                      | 1,782            | 100          |              |
| UOP                      | 168              | 25           |              |
| TOTALS                   | 1,950            |              | 1,824 95,053 |

| MARKET ADJUSTMENTS |       |           |             |                |                |                 |     |      |      |      |        |
|--------------------|-------|-----------|-------------|----------------|----------------|-----------------|-----|------|------|------|--------|
| TYPE               | MDL   | EFF. AREA | TOT ADJ PTS | EFF. BASE RATE | REPL. COST NEW | AYB             | EYB | ECON | FNCT | NORM | % COND |
| 1                  | MANUF | 1         | 100%        | - 2008         |                |                 |     |      |      |      |        |
| Heated Area: 1782  |       |           |             |                |                | HX Base Yr 2008 |     |      |      |      |        |

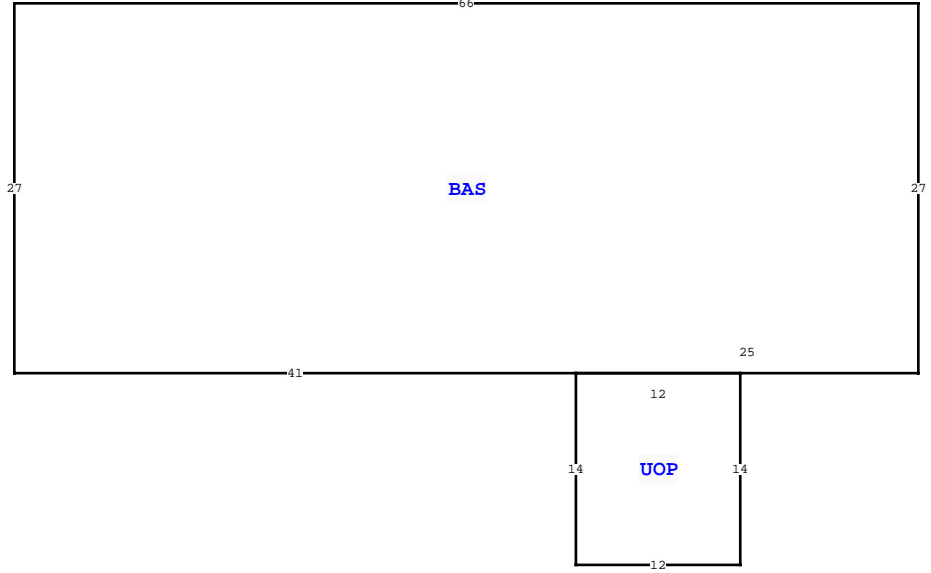

| COLUMBIA COUNTY PROPERTY  |       | PAGE 1 of 1 | 3        |
|---------------------------|-------|-------------|----------|
| VALUATION SUMMARY         |       |             |          |
| VALUATION BY              |       |             | STANDARD |
| Tax Group: 3              |       | Tax Dist:   |          |
| BUILDING MARKET VALUE     |       |             | 95,053   |
| TOTAL MARKET OB/XF VALUE  |       |             | 11,650   |
| TOTAL LAND VALUE - MARKET |       |             | 80,000   |
| TOTAL MARKET VALUE        |       |             | 118,708  |
| SOH/AGL Deduction         |       |             | 71,306   |
| ASSESSED VALUE            |       |             | 47,402   |
| TOTAL EXEMPTION VALUE     | HX HB |             | 25,000   |
| BASE TAXABLE VALUE        |       |             | 22,402   |
| TOTAL JUST VALUE          |       |             | 186,703  |
| NCON VALUE                |       |             | 0        |
| INCOME VALUE              |       |             |          |
| PREVIOUS YEAR MKT VALUE   |       |             | 171,703  |

| PERMIT NUM | DESCRIPTION      | AMT    | ISSUED     |
|------------|------------------|--------|------------|
| 000050430  | Roof Replacement | 7,750  | 07/23/2024 |
| 000047676  | Roof Replacement | 12,875 | 07/17/2023 |
| 27884      | M H              | 468    | 06/16/2009 |

| SALES DATA        |            |           |     |     |        |            |
|-------------------|------------|-----------|-----|-----|--------|------------|
| OFF RECORD Number | DATE       | TYPE INST | Q U | V I | RSN CD | SALE PRICE |
| 1135/1067         | 11/05/2007 | WD        | Q   | V   | 06     | 100        |

GRANTOR: FRANKIE M SCOTT  
GRANTEE: JASON & JACQUELINE

| BLD DATE |          | LGL DATE   |         |
|----------|----------|------------|---------|
| XF DATE  | INC DATE | LAND DATE  | AG DATE |
|          |          | 05/12/2026 | MLU     |
|          |          | 05/15/2022 | SPF     |

| BUILDING NOTES |  |
|----------------|--|
|                |  |

| BUILDING DIMENSIONS                                |  |
|--|--|
| BAS= W66 S27 E41 UOP= S14 E12 N14 W12 S E25 N27 S. |  |

| EXTRA FEATURES |            |             |         |     |   |       |    |       |                |           |         |             |   |        |                 |       |
|----------------|------------|-------------|---------|-----|---|-------|----|-------|----------------|-----------|---------|-------------|---|--------|-----------------|-------|
| L N            | OB/XF CODE | DESCRIPTION | BLD CAP | L   | W | UNITS | UT | Adj R | ADJ UNIT PRICE | ORIG COND | YEAR ON | YEAR ACTUAL | Q | % COND | OB/XF MKT VALUE | NOTES |
| 1              | 0166       | CONC, PAVMT | 0       | 100 | 0 | 0     |    |       | 0.00           | 100       | 2013    | 2013        | 3 | 100    | 50              |       |
| 2              | 0296       | SHED METAL  | 0       | 100 | 0 | 0     |    |       | 0.00           | 100       | 2013    | 2013        | 3 | 100    | 600             |       |
| 3              | 0070       | CARPORT UF  | 0       | 100 | 0 | 0     |    |       | 0.00           | 100       | 2013    | 2013        | 3 | 100    | 200             |       |
| 4              | 0294       | SHED WOOD/  | 0       | 100 | 0 | 0     |    |       | 0.00           | 100       | 2013    | 2013        | 3 | 100    | 600             |       |
| 5              | 9945       | Well/Sept   | 0       | 100 | 0 | 0     |    |       | 7,000.00       | 7,000.00  | 100     |             | 3 | 100    | 7,000           |       |
| 6              | 0252       | LEAN-TO W/  | 0       | 100 | 0 | 0     |    |       | 0.00           | 100       | 2013    | 2013        | 3 | 100    | 200             |       |
| 7              | 9947       | Septic      | 0       | 100 | 0 | 0     |    |       | 3,000.00       | 3,000.00  | 100     |             | 3 | 100    | 3,000           |       |

| LAND DESCRIPTION |          |     |                      |     |     |          |       |       |             |           |     |          |        |         | TOTAL OB/XF |                |            |                             |      |         |      |     |    |        |
|------------------|----------|-----|----------------------|-----|-----|----------|-------|-------|-------------|-----------|-----|----------|--------|---------|-------------|----------------|------------|-----------------------------|------|---------|------|-----|----|--------|
| L N              | USE CODE | CLS | LAND USE DESCRIPTION | CAP | R D | LOC ZONE | FRONT | DEPTH | TOT LND UTS | UNIT TYPE | D T | DPH FACT | % COND | TOT ADJ | UNIT PRICE  | ADJ UNIT PRICE | LAND VALUE | OTHER ADJUSTMENTS AND NOTES | YEAR | DENSITY | DECL | FRZ | YR | CONSRV |
| 1                | 0200     | C   | MBL HM               | 100 |     | A-1      | 0.00  | 0.00  | 1.00        | AC        |     | 1.00     | 1.00   | 1.00    | 8,000.00    | 8,000.00       | 8,000      |                             |      |         |      |     |    |        |
| 2                | 5500     | A   | TIMBER 2             | 0   |     |          | 0.00  | 0.00  | 9.00        | AC        |     | 1.00     | 1.00   | 1.00    | 445.00      | 445.00         | 4,005      |                             |      |         |      |     |    |        |
| 3                | 9910     | M   | MKT. VAL. AG         | 0   |     | A-1      | 0.00  | 0.00  | 9.00        | AC        |     | 1.00     | 1.00   | 1.00    | 8,000.00    | 8,000.00       | 72,000     |                             |      |         |      |     |    |        |