

COMM SW COR OF NW1/4, RUN E  
1098.76 FT FOR POB, CONT E  
369.26 FT, N 1024.07 FT TO SW

CONTI GREGORY/CONTI HOLLY  
215 SW WINDY ACRES CT  
FT WHITE, FL 32038

**2026**

26-6S-16-03943-005  
PAGE 1 of 1

| BUILDING CHARACTERISTICS |                  | CONSTRUCTION |         |
|--------------------------|------------------|--------------|---------|
| ELEMENT                  | CD               |              |         |
| Exterior Wall            | 31               | VINYL SID    | 100     |
| Roof Structur            | 03               | GABLE/HIP    | 100     |
| Roof Cover               | 14               | PREFIN MT    | 100     |
| Interior Wall            | 05               | DRYWALL      | 100     |
| Interior Floor           | 14               | CARPET       | 90      |
| Interior Floor           | 08               | SHT VINYL    | 10      |
| Air Condition            | 03               | CENTRAL      | 100     |
| Heating Type             | 04               | AIR DUCTED   | 100     |
| Bedrooms                 |                  | 3            | 100     |
| Bathrooms                |                  | 2            | 100     |
| Stories                  | 1.               | 1.           | 100     |
| Architactual Units       | 01               | CONV         | 100     |
|                          |                  | 0            | 100     |
| Quality                  | 05               | 05           |         |
| DOR CODE                 | 0200 MOBILE HOME |              |         |
| MAP NUM                  |                  | MKT AREA     | 02      |
| NEIGHBORHOOD/LOC         | 26616.00 1.00/   |              |         |
| AREA TYPE                | TOTAL GROSS AREA | PCT OF BASE  | YEAR    |
| BAS                      | 1,826            | 100          |         |
| UOP                      | 80               | 25           |         |
| UOP                      | 156              | 25           |         |
| TOTALS                   | 2,062            |              |         |
|                          |                  | 1,885        | 114,903 |

| MARKET ADJUSTMENTS |       |           |             |                |                |                 |     |      |      |      |        |
|--------------------|-------|-----------|-------------|----------------|----------------|-----------------|-----|------|------|------|--------|
| TYPE               | MDL   | EFF. AREA | TOT ADJ PTS | EFF. BASE RATE | REPL. COST NEW | AYB             | EYB | ECON | FNCT | NORM | % COND |
| 2                  | MANUF | 1         | 100%        | - 2013         |                |                 |     |      |      |      |        |
| Heated Area: 1826  |       |           |             |                |                | HX Base Yr 2013 |     |      |      |      |        |

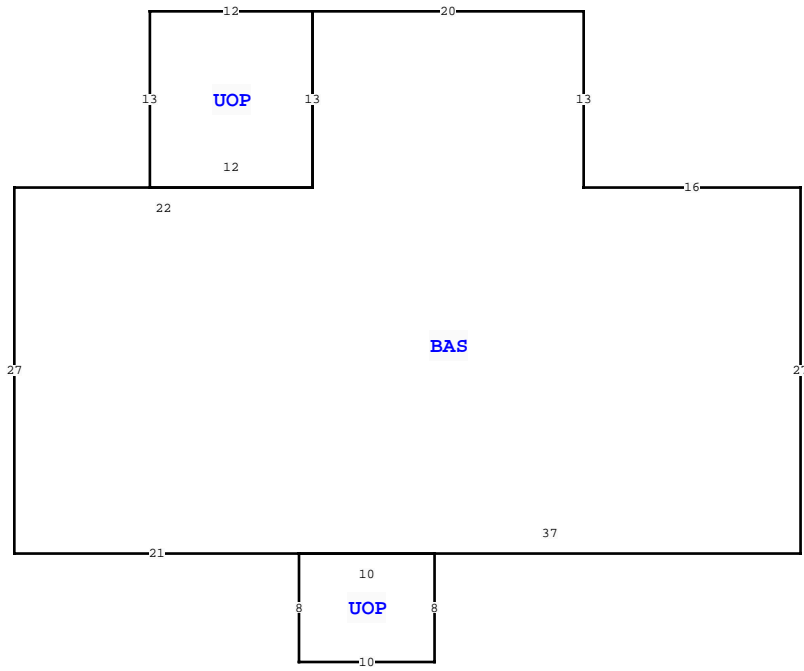

| COLUMBIA COUNTY PROPERTY  |       | PAGE 1 of 1 | 3        |
|---------------------------|-------|-------------|----------|
| VALUATION SUMMARY         |       |             |          |
| VALUATION BY              |       |             | STANDARD |
| Tax Group: 3              |       | Tax Dist:   |          |
| BUILDING MARKET VALUE     |       |             | 114,903  |
| TOTAL MARKET OB/XF VALUE  |       |             | 11,000   |
| TOTAL LAND VALUE - MARKET |       |             | 90,120   |
| TOTAL MARKET VALUE        |       |             | 216,023  |
| SOH/AGL Deduction         |       |             | 117,733  |
| ASSESSED VALUE            |       |             | 98,290   |
| TOTAL EXEMPTION VALUE     | HX HB |             | 51,411   |
| BASE TAXABLE VALUE        |       |             | 46,879   |
| TOTAL JUST VALUE          |       |             | 216,023  |
| NCON VALUE                |       |             | 500      |
| INCOME VALUE              |       |             |          |
| PREVIOUS YEAR MKT VALUE   |       |             | 200,503  |

| PERMIT NUM | DESCRIPTION | AMT | ISSUED     |
|------------|-------------|-----|------------|
| 35123      | M H         | 595 | 03/31/2017 |
| 33180      | M H         | 375 | 07/14/2015 |

| SALES DATA        |            |           |     |     |        |            |
|-------------------|------------|-----------|-----|-----|--------|------------|
| OFF RECORD Number | DATE       | TYPE INST | Q U | V I | RSN CD | SALE PRICE |
| 1204/1942         | 11/08/2010 | QC        | U   | I   | 11     | 100        |

GRANTOR: JANICE D MOORE  
GRANTEE: GREGORY & HOLLY CON  
0705/0481 12/26/1989 AG Q V 18,000  
GRANTOR: MARY WOOLEY  
GRANTEE: LEROY & JANICE MOOR

| EXTRA FEATURES |            |             |     |     |   |   |       |    |          |                |           |
|----------------|------------|-------------|-----|-----|---|---|-------|----|----------|----------------|-----------|
| L N            | OB/XF CODE | DESCRIPTION | BLD | CAP | L | W | UNITS | UT | Adj R    | ADJ UNIT PRICE | ORIG COND |
| 1              | 0255       | MBL HOME S  | 0   | 100 | 0 | 0 | 1.00  | UT | 0.00     | 0.00           | 100       |
| 2              | 9945       | Well/Sept   | 0   | 100 | 0 | 0 | 1.00  | UT | 7,000.00 | 7,000.00       | 100       |
| 3              | 9947       | Septic      | 0   | 0   | 0 | 0 | 1.00  | UT | 3,000.00 | 3,000.00       | 100       |
| 4              | 0255       | MBL HOME S  | 0   | 100 | 0 | 0 | 1.00  | UT | 500.00   | 500.00         | 100       |

147 SW WINDY ACRES CT, FORT WHITE

|          |  |           |            |
|----------|--|-----------|------------|
| BLD DATE |  | LGL DATE  |            |
| XF DATE  |  | LAND DATE | 05/06/2026 |
| INC DATE |  | AG DATE   | MLU        |

| BUILDING NOTES |  |
|----------------|--|
|                |  |

| BUILDING DIMENSIONS   |  |
|---|--|
| BAS= W16 N13 W20 UOP= W12 S13 E12 N13\$ S13 W22 S27 E21 UOP= S8 E10 N8 W10\$ E37 N27\$. |  |

| LAND DESCRIPTION |          |     |                      |     |     |          |       |       |             |           |     | TOTAL OB/XF |        |         |            |                |            |                             |      |         |      |     |    |        |
|------------------|----------|-----|----------------------|-----|-----|----------|-------|-------|-------------|-----------|-----|-------------|--------|---------|------------|----------------|------------|-----------------------------|------|---------|------|-----|----|--------|
| L N              | USE CODE | CLS | LAND USE DESCRIPTION | CAP | R D | LOC ZONE | FRONT | DEPTH | TOT LND UTS | UNIT TYPE | D T | DPTH FACT   | % COND | TOT ADJ | UNIT PRICE | ADJ UNIT PRICE | LAND VALUE | OTHER ADJUSTMENTS AND NOTES | YEAR | DENSITY | DECL | FRZ | YR | CONSRV |
| 1                | 0200     | C   | MBL HM               | 100 |     | A-1      | 0.00  | 0.00  | 7.51        | AC        |     | 1.00        | 1.00   | 1.00    | 12,000.00  | 12,000.00      | 90,120     |                             |      |         |      |     |    |        |