

LOTS 3 & A PART OF LOT 4 AND THE LOT 5 & THE EAST 1/2 OF LOT 8 BI UNREC: DESC AS FOLLOWS: COMM AT

BENNETT SHIRLEY  
3108 SW OLD WIRE RD  
FORT WHITE, FL 32038

2026

26-5S-16-03717-132



| BUILDING CHARACTERISTICS |                  | CONSTRUCTION |      |
|--------------------------|------------------|--------------|------|
| ELEMENT                  | CD               |              |      |
| Exterior Wall            | 31               | VINYL SID    | 100  |
| Roof Structur            | 03               | GABLE/HIP    | 100  |
| Roof Cover               | 03               | COMP SHNGL   | 100  |
| Interior Wall            | 05               | DRYWALL      | 100  |
| Interior Floo            | 14               | CARPET       | 90   |
| Interior Floo            | 08               | SHT VINYL    | 10   |
| Air Condition            | 03               | CENTRAL      | 100  |
| Heating Type             | 04               | AIR DUCTED   | 100  |
| Bedrooms                 |                  | 3            | 100  |
| Bathrooms                |                  | 2            | 100  |
| Stories                  | 1.               | 1.           | 100  |
| Architectual             | 01               | CONV         | 100  |
| Units                    |                  | 0            | 100  |
| Condition Adj            | 03               | 03           | 100  |
| Kitchen Adjus            | 01               | 01           | 100  |
| Quality                  | 05               | 05           |      |
| DOR CODE                 | 0200 MOBILE HOME |              |      |
| MAP NUM                  |                  | MKT AREA     | 02   |
| NEIGHBORHOOD/LOC         | 26516.010 1.00/  |              |      |
| AREA TYPE                | TOTAL GROSS AREA | PCT OF BASE  | YEAR |
| BAS                      | 1,900            | 100          |      |
| FCP                      | 624              | 25           |      |
| UOP                      | 180              | 25           |      |
| TOTALS                   | 2,704            |              |      |

| MARKET ADJUSTMENTS |       |           |             |                |                   |     |     |                 |      |      |        |  |
|--------------------|-------|-----------|-------------|----------------|-------------------|-----|-----|-----------------|------|------|--------|--|
| TYPE               | MDL   | EFF. AREA | TOT ADJ PTS | EFF. BASE RATE | REPL. COST NEW    | AYB | EYB | ECON            | FNCT | NORM | % COND |  |
| 1                  | MANUF | 1         | 100%        | - 2002         |                   |     |     |                 |      |      |        |  |
|                    |       |           |             |                | Heated Area: 1900 |     |     | HX Base Yr 2002 |      |      |        |  |

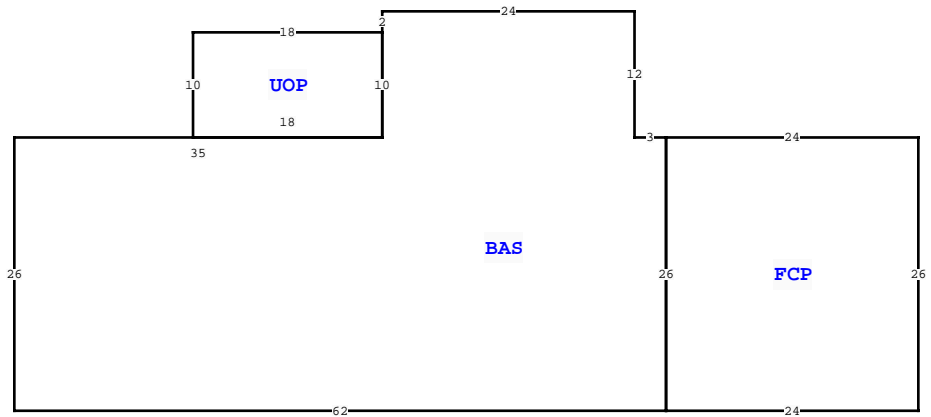

| COLUMBIA COUNTY PROPERTY  |  | PAGE 1 of 2  | 3 |
|---------------------------|--|--------------|---|
| VALUATION SUMMARY         |  |              |   |
| VALUATION BY              |  | STANDARD     |   |
| Tax Group: 3              |  | Tax Dist:    |   |
| BUILDING MARKET VALUE     |  | 123,725      |   |
| TOTAL MARKET OB/XF VALUE  |  | 20,230       |   |
| TOTAL LAND VALUE - MARKET |  | 48,175       |   |
| TOTAL MARKET VALUE        |  | 192,130      |   |
| SOH/AGL Deduction         |  | 118,696      |   |
| ASSESSED VALUE            |  | 73,434       |   |
| TOTAL EXEMPTION VALUE     |  | HX HB 37,819 |   |
| BASE TAXABLE VALUE        |  | 35,615       |   |
| TOTAL JUST VALUE          |  | 192,130      |   |
| NCON VALUE                |  | 0            |   |
| INCOME VALUE              |  |              |   |
| PREVIOUS YEAR MKT VALUE   |  | 180,130      |   |

| PERMIT NUM | DESCRIPTION | AMT | ISSUED     |
|------------|-------------|-----|------------|
| 21400      | M H         | 411 | 01/07/2004 |
| 18402      | M H         | 125 | 06/15/2001 |
| 16329      | M H         | 125 | 11/23/1999 |
| 8482       | M H         | 125 | 06/10/1994 |
| 8309       | M H         | 125 | 04/26/1994 |

| SALES DATA                     |            |           |       |       |        |            |
|--------------------------------|------------|-----------|-------|-------|--------|------------|
| OFF RECORD Number              | DATE       | TYPE INST | Q / U | V / I | RSN CD | SALE PRICE |
| 1309/0493                      | 5/22/2015  | CD        | U     | V     | 11     | 0          |
| GRANTOR: ROBERT MOULTON & DANI |            |           |       |       |        |            |
| GRANTEE: SHIRLEY BENNETT       |            |           |       |       |        |            |
| 1003/2296                      | 12/24/2003 | WD        | Q     | V     | 04     | 10,000     |
| GRANTOR: DEAS BULLARD          |            |           |       |       |        |            |
| GRANTEE: SHIRLEY BENNETT       |            |           |       |       |        |            |

| EXTRA FEATURES |            |             |         |     |    |       |    |        |                |           |         |             |
|----------------|------------|-------------|---------|-----|----|-------|----|--------|----------------|-----------|---------|-------------|
| L N            | OB/XF CODE | DESCRIPTION | BLD CAP | L   | W  | UNITS | UT | Adj R  | ADJ UNIT PRICE | ORIG COND | YEAR ON | YEAR ACTUAL |
| 1              | 0190       | FPLC PF     | 0       | 100 | 0  | 0     | 0  | 1.00   | 1,200.00       | 100       | 1999    | 1999        |
| 2              | 0169       | FENCE/WOOD  | 0       | 100 | 0  | 0     | 0  | 96.00  | 7.50           | 100       | 1999    | 1999        |
| 3              | 0294       | SHED WOOD/  | 0       | 100 | 6  | 6     | 0  | 36.00  | 7.50           | 100       | 1999    | 1999        |
| 4              | 0294       | SHED WOOD/  | 0       | 100 | 8  | 10    | 0  | 80.00  | 7.50           | 100       | 1999    | 1999        |
| 5              | 9945       | Well/Sept   | 0       | 100 | 0  | 0     | 0  | 1.00   | 7,000.00       | 100       |         |             |
| 6              | 0190       | FPLC PF     | 0       | 0   | 0  | 0     | 0  | 1.00   | 1,200.00       | 100       | 2009    | 2009        |
| 7              | 0294       | SHED WOOD/  | 0       | 0   | 0  | 0     | 0  | 1.00   | 0.00           | 100       | 2009    | 2009        |
| 8              | 0296       | SHED METAL  | 0       | 0   | 0  | 0     | 0  | 1.00   | 0.00           | 100       | 2009    | 2009        |
| 9              | 0080       | DECKING     | 0       | 0   | 0  | 0     | 0  | 1.00   | 0.00           | 100       | 2009    | 2009        |
| 10             | 0296       | SHED METAL  | 0       | 0   | 12 | 24    | 0  | 288.00 | 10.00          | 100       | 2009    | 2009        |

| TOTAL OB/XF |          |     |                      |     |     |          |       |       |             |           |     |          |
|-------------|----------|-----|----------------------|-----|-----|----------|-------|-------|-------------|-----------|-----|----------|
| 15,670      |          |     |                      |     |     |          |       |       |             |           |     |          |
| L N         | USE CODE | CLS | LAND USE DESCRIPTION | CAP | R D | LOC ZONE | FRONT | DEPTH | TOT LND UTS | UNIT TYPE | D T | DPH FACT |
| 1           | 0200     | C   | MBL HM               | 100 |     | A-1      | 0.00  | 0.00  | 4.00        | AC        |     | 1.00     |
| 2           | 9601     | C   | RETENTION AR         | 0   |     |          | 0.00  | 0.00  | 1.00        | AC        |     | 1.00     |

| BUILDING NOTES  |  |  |  |  |  |  |  |  |  |  |  |  |
|---|--|--|--|--|--|--|--|--|--|--|--|--|
| BAS= W3 N12 W24 S2 UOP= W18 S10 E18 N10 S10 W35 S26 E62 |  |  |  |  |  |  |  |  |  |  |  |  |
| FCP= E24 N26 W24 S26 S N26 S.                           |  |  |  |  |  |  |  |  |  |  |  |  |

| BUILDING DIMENSIONS                                     |  |  |  |  |  |  |  |  |  |  |  |  |
|---|--|--|--|--|--|--|--|--|--|--|--|--|
| BAS= W3 N12 W24 S2 UOP= W18 S10 E18 N10 S10 W35 S26 E62 |  |  |  |  |  |  |  |  |  |  |  |  |
| FCP= E24 N26 W24 S26 S N26 S.                           |  |  |  |  |  |  |  |  |  |  |  |  |

| LAND DESCRIPTION |          |     |                      |     |     |          |       |       |             |           |     |          | TOTAL OB/XF |         |            |                |            |                             |      |         |      |     |    |        |  |
|------------------|----------|-----|----------------------|-----|-----|----------|-------|-------|-------------|-----------|-----|----------|-------------|---------|------------|----------------|------------|-----------------------------|------|---------|------|-----|----|--------|--|
| L N              | USE CODE | CLS | LAND USE DESCRIPTION | CAP | R D | LOC ZONE | FRONT | DEPTH | TOT LND UTS | UNIT TYPE | D T | DPH FACT | % COND      | TOT ADJ | UNIT PRICE | ADJ UNIT PRICE | LAND VALUE | OTHER ADJUSTMENTS AND NOTES | YEAR | DENSITY | DECL | FRZ | YR | CONSRV |  |
| 1                | 0200     | C   | MBL HM               | 100 |     | A-1      | 0.00  | 0.00  | 4.00        | AC        |     | 1.00     | 1.00        | 1.00    | 12,000.00  | 12,000.00      | 48,000     |                             |      |         |      |     |    |        |  |
| 2                | 9601     | C   | RETENTION AR         | 0   |     |          | 0.00  | 0.00  | 1.00        | AC        |     | 1.00     | 1.00        | 1.00    | 175.00     | 175.00         | 175        |                             |      |         |      |     |    |        |  |

