

| BUILDING CHARACTERISTICS |                  | CONSTRUCTION  |      |
|--------------------------|------------------|---------------|------|
| ELEMENT                  | CD               |               |      |
| Exterior Wall            | 16               | WD FR STUC    | 100  |
| Roof Structur            | 08               | IRREGULAR     | 100  |
| Roof Cover               | 03               | COMP SHNGL    | 100  |
| Interior Wall            | 05               | DRYWALL       | 100  |
| Interior Floor           | 13               | LAM/VNLPK     | 80   |
| Interior Floor           | 15               | HARDTILE      | 20   |
| Air Condition            | 03               | CENTRAL       | 100  |
| Heating Type             | 04               | AIR DUCTED    | 100  |
| Bedrooms                 |                  | 3             | 100  |
| Bathrooms                |                  | 2.5           | 100  |
| Frame                    | 02               | WOOD FRAME    | 100  |
| Stories                  | 1.1              | 1.100         |      |
| ArchitECTUAL             | 05               | CONV          | 100  |
| Units                    |                  | 0             | 100  |
| Condition Adj            | 03               | 03            | 100  |
| Kitchen Adjus            | 01               | 01            | 100  |
| Quality                  | 07               | 07            |      |
| DOR CODE                 | 0100             | SINGLE FAMILY |      |
| MAP NUM                  |                  | MKT AREA      | 06   |
| NEIGHBORHOOD/LOC         | 23316.020        | 1.00/         |      |
| AREA TYPE                | TOTAL GROSS AREA | PCT OF BASE   | YEAR |
| BAS                      | 2,563            | 100           |      |
| FGR                      | 492              | 55            |      |
| FOP                      | 86               | 30            |      |
| FSP                      | 484              | 40            |      |
| TOTALS                   | 3,625            |               |      |

| MARKET ADJUSTMENTS   |     |           |             |                |                |      |      |      |      |       |        |
|--|-----|-----------|-------------|----------------|----------------|------|------|------|------|-------|--------|
| TYPE   | MDL | EFF. AREA | TOT ADJ PTS | EFF. BASE RATE | REPL. COST NEW | AYB  | EYB  | ECON | FNCT | NORM  | % COND |
| 0100   | 01  | 3,054     | 121.2112    | 135.76         | 414,611        | 2000 | 2000 | 0    | 0    | 35.00 | 65.00  |
| 1 SINGLE FAM 100% - 2021 Heated Area: 2563 HX Base Yr 2021 |     |           |             |                |                |      |      |      |      |       |        |

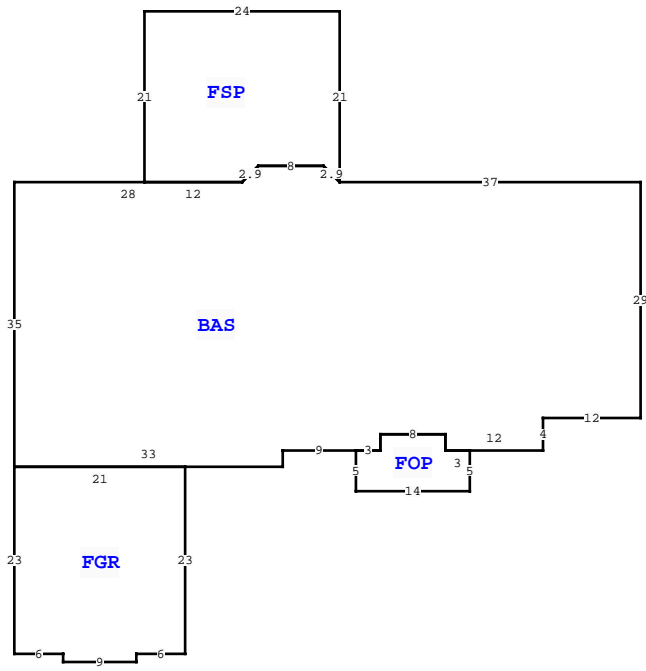

| COLUMBIA COUNTY PROPERTY  |           |  | PAGE 1 of 1 | 2 |
|---------------------------|-----------|--|-------------|---|
| VALUATION SUMMARY         |           |  |             |   |
| VALUATION BY              | STANDARD  |  |             |   |
| Tax Group: 2              | Tax Dist: |  |             |   |
| BUILDING MARKET VALUE     | 269,497   |  |             |   |
| TOTAL MARKET OB/XF VALUE  | 34,219    |  |             |   |
| TOTAL LAND VALUE - MARKET | 50,400    |  |             |   |
| TOTAL MARKET VALUE        | 354,116   |  |             |   |
| SOH/AGL Deduction         | 54,076    |  |             |   |
| ASSESSED VALUE            | 300,040   |  |             |   |
| TOTAL EXEMPTION VALUE     | 51,411    |  | HX HB       |   |
| BASE TAXABLE VALUE        | 248,629   |  |             |   |
| TOTAL JUST VALUE          | 354,116   |  |             |   |
| NCON VALUE                | 0         |  |             |   |
| INCOME VALUE              |           |  |             |   |
| PREVIOUS YEAR MKT VALUE   | 355,147   |  |             |   |

| PERMIT NUM | DESCRIPTION       | AMT | ISSUED     |
|------------|-------------------|-----|------------|
| 000044108  | Electrical Servic | 0   | 04/05/2022 |
| 39870      | REMODEL           | 0   | 06/03/2020 |
| 33223      | POOL              | 160 | 07/28/2015 |
| 16875      | SFR               | 405 | 04/19/2000 |

| SALES DATA                     |           |           |     |     |        |            |
|--------------------------------|-----------|-----------|-----|-----|--------|------------|
| OFF RECORD Number              | DATE      | TYPE INST | Q U | V I | RSN CD | SALE PRICE |
| 1383/1262                      | 4/29/2019 | WD Q      | Q   | I   | 01     | 319,000    |
| GRANTOR: SHANNON M MILLER      |           |           |     |     |        |            |
| GRANTEE: BARON KHARI & PAMEL   |           |           |     |     |        |            |
| 1356/1383                      | 3/21/2018 | WD Q      | Q   | I   | 01     | 258,500    |
| GRANTOR: MICHAEL TODD LIVERMOR |           |           |     |     |        |            |
| GRANTEE: SHANNON M MILLER      |           |           |     |     |        |            |

| EXTRA FEATURES |            |             |         |       |          |    |
|----------------|------------|-------------|---------|-------|----------|----|
| L N            | OB/XF CODE | DESCRIPTION | BLD CAP | L W   | UNITS    | UT |
| 1              | 0190       | FPLC PF     | 0 100   | 0 0   | 1.00     | UT |
| 2              | 0166       | CONC, PAVMT | 0 100   | 0 0   | 1,522.00 | UT |
| 3              | 0294       | SHED WOOD/  | 0 100   | 16 24 | 384.00   | UT |
| 4              | 0252       | LEAN-TO W/  | 0 100   | 12 24 | 288.00   | UT |
| 5              | 0120       | CLFENCE 4   | 0 100   | 0 0   | 1.00     | UT |
| 6              | 0280       | POOL R/CON  | 0 100   | 12 29 | 348.00   | UT |
| 7              | 0104       | GENERATOR   | 0 100   | 0 0   | 1.00     | UT |
| 8              | 0169       | FENCE/WOOD  | 0 100   | 0 0   | 1.00     | UT |

| TOTAL OB/XF |            |             |         |       |          |    |          |                |           |         |             | 34,219 |        |                 |       |
|-------------|------------|-------------|---------|-------|----------|----|----------|----------------|-----------|---------|-------------|--------|--------|-----------------|-------|
| L N         | OB/XF CODE | DESCRIPTION | BLD CAP | L W   | UNITS    | UT | Adj R    | ADJ UNIT PRICE | ORIG COND | YEAR ON | YEAR ACTUAL | Q      | % COND | OB/XF MKT VALUE | NOTES |
| 1           | 0190       | FPLC PF     | 0 100   | 0 0   | 1.00     | UT | 1,200.00 | 1,200.00       | 100       | 2000    | 2000        | 3      | 100    | 1,200           |       |
| 2           | 0166       | CONC, PAVMT | 0 100   | 0 0   | 1,522.00 | UT | 1.50     | 1.50           | 100       | 2000    | 2000        | 3      | 100    | 2,283           |       |
| 3           | 0294       | SHED WOOD/  | 0 100   | 16 24 | 384.00   | UT | 12.00    | 12.00          | 50        | 2009    | 2009        | 3      | 50     | 2,304           |       |
| 4           | 0252       | LEAN-TO W/  | 0 100   | 12 24 | 288.00   | UT | 2.00     | 2.00           | 50        | 2009    | 2009        | 3      | 50     | 288             |       |
| 5           | 0120       | CLFENCE 4   | 0 100   | 0 0   | 1.00     | UT | 0.00     | 0.00           | 100       | 2014    | 2014        | 3      | 100    | 100             |       |
| 6           | 0280       | POOL R/CON  | 0 100   | 12 29 | 348.00   | UT | 70.00    | 70.00          | 100       | 2015    | 2015        | 3      | 79     | 19,244          |       |
| 7           | 0104       | GENERATOR   | 0 100   | 0 0   | 1.00     | UT | 6,000.00 | 6,000.00       | 100       | 2023    | 2022        |        | 80     | 4,800           |       |
| 8           | 0169       | FENCE/WOOD  | 0 100   | 0 0   | 1.00     | UT | 4,000.00 | 4,000.00       | 100       | 2023    | 2022        |        | 100    | 4,000           |       |

| BUILDING NOTES |  |  |  |  |  |  |  |  |  |  |  |
|----------------|--|--|--|--|--|--|--|--|--|--|--|
| BLD DATE       |  |  |  |  |  |  |  |  |  |  |  |
| XF DATE        |  |  |  |  |  |  |  |  |  |  |  |
| INC DATE       |  |  |  |  |  |  |  |  |  |  |  |
| LGL DATE       |  |  |  |  |  |  |  |  |  |  |  |
| LAND DATE      |  |  |  |  |  |  |  |  |  |  |  |
| AG DATE        |  |  |  |  |  |  |  |  |  |  |  |
| 05/11/2023 MLU |  |  |  |  |  |  |  |  |  |  |  |

| BUILDING DIMENSIONS  |  |  |  |  |  |  |  |  |  |  |  |
|--|--|--|--|--|--|--|--|--|--|--|--|
| BAS= W37 FSP= N21 W24 S21 E12 R2 U2 E8 D2 R2 \$ L2 U2 W8     |  |  |  |  |  |  |  |  |  |  |  |
| D2 L2 W28 S35 FGR= S23 E6 S1 E9 N1 E6 N23 W21\$ E33 N2 E9    |  |  |  |  |  |  |  |  |  |  |  |
| FOP= S5 E14 N5 W3N2 W8 S2 W3\$ E3 N2 E8 S2 E12 N4 E12 N29\$. |  |  |  |  |  |  |  |  |  |  |  |

| LAND DESCRIPTION |          |     |                      |     |     |          |       |       |             |           |     | TOTAL OB/XF |        |         |            |                |            |                             |      |         |      |     |    | 34,219 |  |  |  |  |  |  |  |  |  |  |  |
|------------------|----------|-----|----------------------|-----|-----|----------|-------|-------|-------------|-----------|-----|-------------|--------|---------|------------|----------------|------------|-----------------------------|------|---------|------|-----|----|--------|--|--|--|--|--|--|--|--|--|--|--|
| L N              | USE CODE | CLS | LAND USE DESCRIPTION | CAP | R D | LOC ZONE | FRONT | DEPTH | TOT LND UTS | UNIT TYPE | D T | DPH FACT    | % COND | TOT ADJ | UNIT PRICE | ADJ UNIT PRICE | LAND VALUE | OTHER ADJUSTMENTS AND NOTES | YEAR | DENSITY | DECL | FRZ | YR | CONSRV |  |  |  |  |  |  |  |  |  |  |  |
| 1                | 0100     | C   | SFR                  | 100 |     | RSF-1    | 0.00  | 0.00  | 1.00        | LT        |     | 1.00        | 1.00   | 0.90    | 28,000.00  | 25,200.00      | 25,200     |                             |      |         |      |     |    |        |  |  |  |  |  |  |  |  |  |  |  |
| 2                | 0000     | C   | VAC RES              | 100 |     |          | 0.00  | 0.00  | 1.00        | LT        |     | 1.00        | 1.00   | 0.90    | 28,000.00  | 25,200.00      | 25,200     |                             |      |         |      |     |    |        |  |  |  |  |  |  |  |  |  |  |  |