

BEG SW COR OF SE1/4 OF NW1/4 OF N 118.23 FT, E 135.22 FT, N 41 D E 73.79 FT TO W R/W OF NW YATES

NETTLES JOSHUA
429 NW YATES LOOP
LAKE CITY, FL 32055

2026

21-3S-16-02215-049

| BUILDING CHARACTERISTICS | | CONSTRUCTION | |
|--------------------------|------------------|---------------|------|
| ELEMENT | CD | | |
| Exterior Wall | 32 | HARDIE BRD | 100 |
| Roof Structur | 08 | IRREGULAR | 100 |
| Roof Cover | 12 | MODULAR MT | 100 |
| Interior Wall | 05 | DRYWALL | 100 |
| Interior Floor | 12 | HARDWOOD | 80 |
| Interior Floor | 15 | HARDTILE | 20 |
| Air Condition | 03 | CENTRAL | 100 |
| Heating Type | 04 | AIR DUCTED | 100 |
| Bedrooms | | 3 | 100 |
| Bathrooms | | 2 | 100 |
| Frame | 02 | WOOD FRAME | 100 |
| Stories | 1. | 1. | 100 |
| Architectual | 05 | CONV | 100 |
| Units | | 0 | 100 |
| Quality | 07 | 07 | |
| DOR CODE | 0100 | SINGLE FAMILY | |
| MAP NUM | | MKT AREA | 01 |
| NEIGHBORHOOD/LOC | 21316.00 | 1.00/ | |
| AREA TYPE | TOTAL GROSS AREA | PCT OF BASE | YEAR |
| BAS | 1,596 | 100 | |
| FGR | 460 | 55 | |
| FOP | 106 | 30 | |
| TOTALS | 2,162 | | |

| MARKET ADJUSTMENTS | | | | | | | | | | | |
|--|-----|-----------|-------------|----------------|----------------|------|------|------|------|------|--------|
| TYPE | MDL | EFF. AREA | TOT ADJ PTS | EFF. BASE RATE | REPL. COST NEW | AYB | EYB | ECON | FNCT | NORM | % COND |
| 0100 | 01 | 1,881 | 133.9470 | 150.02 | 282,188 | 2018 | 2018 | | 0 | 0 | 7.00 |
| 1 SINGLE FAM 100% - 2020 Heated Area: 1596 HX Base Yr 2020 | | | | | | | | | | | |

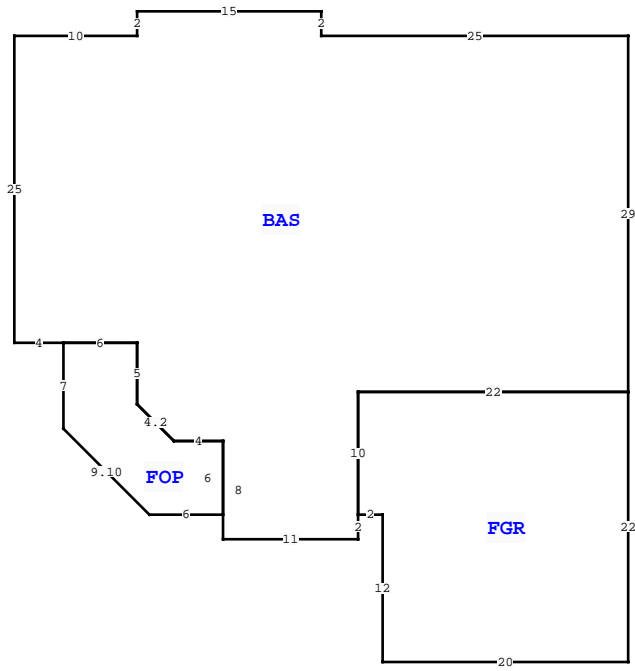

| COLUMBIA COUNTY PROPERTY | | PAGE 1 of 1 | 2 |
|---------------------------|-----------|-------------|----------|
| VALUATION SUMMARY | | | |
| VALUATION BY | | | STANDARD |
| Tax Group: 2 | Tax Dist: | | |
| BUILDING MARKET VALUE | | | 262,435 |
| TOTAL MARKET OB/XF VALUE | | | 10,216 |
| TOTAL LAND VALUE - MARKET | | | 18,180 |
| TOTAL MARKET VALUE | | | 290,831 |
| SOH/AGL Deduction | | | 84,998 |
| ASSESSED VALUE | | | 205,833 |
| TOTAL EXEMPTION VALUE | HX HB | | 51,411 |
| BASE TAXABLE VALUE | | | 154,422 |
| TOTAL JUST VALUE | | | 290,831 |
| NCON VALUE | | | 0 |
| INCOME VALUE | | | |
| PREVIOUS YEAR MKT VALUE | | | 294,523 |

| PERMIT NUM | DESCRIPTION | AMT | ISSUED |
|------------|-------------|-----|------------|
| 32432 | SFR | 636 | 10/24/2014 |
| 51028 | | | |

| SALES DATA | | | | | | |
|-------------------------|-----------|-----------|-----|-----|--------|------------|
| OFF RECORD Number | DATE | TYPE INST | Q U | V I | RSN CD | SALE PRICE |
| 1536/2505 | 4/02/2025 | QC | U | I | 11 | 100 |
| GRANTOR: NETTLES JOHN | | | | | | |
| GRANTEE: NETTLES JOSHUA | | | | | | |
| 1536/2438 | 4/01/2025 | QC | U | I | 11 | 0 |
| GRANTOR: NETTLES JOHN M | | | | | | |
| GRANTEE: NETTLES JOSHUA | | | | | | |

| EXTRA FEATURES | | | | | | | | | | | | | | | | | |
|----------------|------------|-------------|---------|-----|---|-------|------|-------------|----------------|-----------|---------|-------------|------|--------|-----------------|-------|--|
| L N | OB/XF CODE | DESCRIPTION | BLD CAP | L | W | UNITS | UT | Adj R | ADJ UNIT PRICE | ORIG COND | YEAR ON | YEAR ACTUAL | Q | % COND | OB/XF MKT VALUE | NOTES | |
| 1 | 0166 | CONC, PAVMT | 0 | 100 | 0 | 0 | 0 | 2,708.00 | UT 2.00 | 2.00 | 100 | 2018 | 2018 | 3 | 100 | 5,416 | |
| 2 | 0104 | GENERATOR | 0 | 100 | 0 | 0 | 1.00 | UT 6,000.00 | 6,000.00 | 100 | 2023 | 2022 | | 80 | 4,800 | | |

| | | | |
|----------|--|-----------|------------|
| BLD DATE | | LGL DATE | |
| XF DATE | | LAND DATE | 04/16/2026 |
| INC DATE | | AG DATE | MLU |

| BUILDING NOTES | |
|----------------|--|
| | |

| BUILDING DIMENSIONS | |
|--|--|
| BAS= W25 N2 W15 S2 W10 S25 E4 FOP= S7 D7 R7 E6 N6 W4 U3 L3 N5 W6\$ E6 S5 R3 D3 E4 S8 E11 N2 FGR= E2 S12 E20 N22 W22 S10\$ N10 E22 N29\$. | |

| LAND DESCRIPTION | | | | | | | | | | TOTAL OB/XF | | | | | | | | | | | | | | |
|------------------|----------|-----|----------------------|-----|-----|----------|-------|-------|-------------|-------------|-----|----------|--------|---------|------------|----------------|------------|-----------------------------|------|---------|------|-----|----|--------|
| L N | USE CODE | CLS | LAND USE DESCRIPTION | CAP | R D | LOC ZONE | FRONT | DEPTH | TOT LND UTS | UNIT TYPE | D T | DPH FACT | % COND | TOT ADJ | UNIT PRICE | ADJ UNIT PRICE | LAND VALUE | OTHER ADJUSTMENTS AND NOTES | YEAR | DENSITY | DECL | FRZ | YR | CONSRV |
| 1 | 0100 | C | SFR | 100 | | A-1 | 0.00 | 0.00 | 1.01 | AC | | 1.00 | 1.00 | 1.00 | 18,000.00 | 18,000.00 | 18,180 | | | | | | | |