

COMM SE COR OF NW1/4, RUN W 78.6  
RD, RUN N ALONG R/W 829.23 FT, W  
CONT W 369.15 FT, N 235.95 FT, E

NEWTON REVONIA  
191 SW AMISTAD GLN  
LAKE CITY, FL 32025

**2026**

20-4S-17-08606-012

| BUILDING CHARACTERISTICS |                  |                |
|--------------------------|------------------|----------------|
| ELEMENT                  | CD               | CONSTRUCTION   |
| Exterior Wall            | 19               | COMMON BRK 100 |
| Roof Structur            | 03               | GABLE/HIP 100  |
| Roof Cover               | 03               | COMP SHNGL 100 |
| Interior Wall            | 05               | DRYWALL 100    |
| Interior Floor           | 14               | CARPET 80      |
| Interior Floor           | 06               | VINYL ASB 20   |
| Air Condition            | 03               | CENTRAL 100    |
| Heating Type             | 04               | AIR DUCTED 100 |
| Bedrooms                 |                  | 3 100          |
| Bathrooms                |                  | 2.5 100        |
| Frame                    | 01               | NONE 100       |
| Stories                  | 1.               | 1. 100         |
| Architectual             | 05               | CONV 100       |
| Units                    |                  | 0 100          |
| Condition Adj            | 03               | 03 100         |
| Kitchen Adjus            | 01               | 01 100         |
| Quality                  | 05               | 05             |
| DOR CODE                 | 0100             | SINGLE FAMILY  |
| MAP NUM                  |                  | MKT AREA 02    |
| NEIGHBORHOOD/LOC         | 20417.00         | 1.00/          |
| AREA TYPE                | TOTAL GROSS AREA | PCT OF BASE    |
| BAS                      | 2,667            | 100            |
| FGR                      | 462              | 55             |
| FOP                      | 174              | 30             |
| FSP                      | 225              | 40             |
| UOP                      | 189              | 20             |
| TOTALS                   | 3,717            |                |

| MARKET ADJUSTMENTS |     |           |             |                   |                |            |      |      |      |       |        |  |
|--------------------|-----|-----------|-------------|-------------------|----------------|------------|------|------|------|-------|--------|--|
| TYPE               | MDL | EFF. AREA | TOT ADJ PTS | EFF. BASE RATE    | REPL. COST NEW | AYB        | EYB  | ECON | FNCT | NORM  | % COND |  |
| 0100               | 01  | 3,101     | 107.5200    | 120.42            | 373,422        | 1979       | 1979 | 0    | 0    | 35.00 | 65.00  |  |
| 1 SINGLE FAM       |     |           | 100% - 0    | Heated Area: 2667 |                | HX Base Yr |      |      |      |       |        |  |

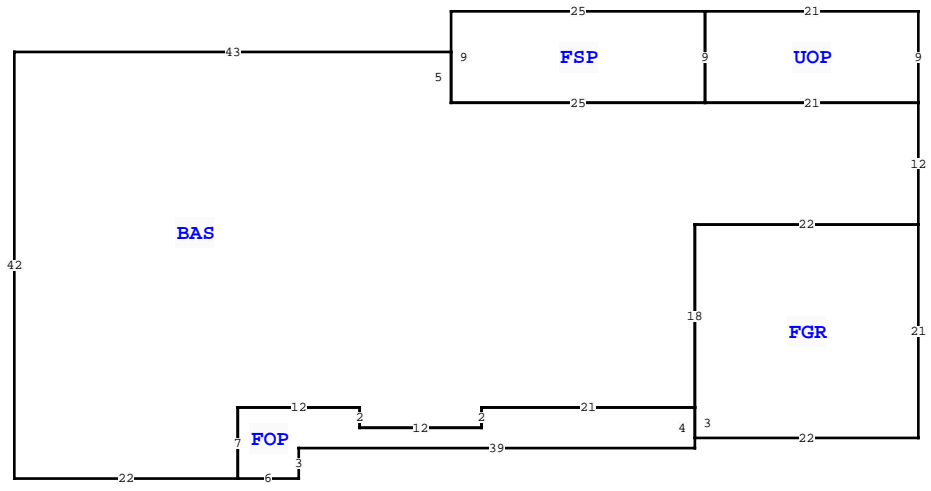

| COLUMBIA COUNTY PROPERTY  |           |             |
|---------------------------|-----------|-------------|
| VALUATION SUMMARY         |           | PAGE 1 of 1 |
| VALUATION BY              |           | STANDARD    |
| Tax Group: 2              | Tax Dist: |             |
| BUILDING MARKET VALUE     |           | 242,724     |
| TOTAL MARKET OB/XF VALUE  |           | 5,780       |
| TOTAL LAND VALUE - MARKET |           | 32,000      |
| TOTAL MARKET VALUE        |           | 280,504     |
| SOH/AGL Deduction         |           | 120,681     |
| ASSESSED VALUE            |           | 159,823     |
| TOTAL EXEMPTION VALUE     | HX HB     | 51,411      |
| BASE TAXABLE VALUE        |           | 108,412     |
| TOTAL JUST VALUE          |           | 280,504     |
| NCON VALUE                |           | 0           |
| INCOME VALUE              |           |             |
| PREVIOUS YEAR MKT VALUE   |           | 276,504     |

| PERMIT NUM | DESCRIPTION      | AMT    | ISSUED     |
|------------|------------------|--------|------------|
| 000049140  | Remodel          | 4,270  | 02/01/2024 |
| 000043632  | Remodel          | 13,708 | 02/02/2022 |
| 000042437  | Roof Replacement | 29,900 | 07/28/2021 |

| SALES DATA        |           |           |       |       |        |            |
|-------------------|-----------|-----------|-------|-------|--------|------------|
| OFF RECORD Number | DATE      | TYPE INST | Q / U | V / I | RSN CD | SALE PRICE |
| 1568/283          | 5/07/2026 | LE U      |       | I     | 14     | 0          |

GRANTOR: NEWTON REVONIA (ENH L)  
GRANTEE: NEWTON JELANI OMARI  
1139/0715 12/21/2007 WD Q I 01 0  
GRANTOR: FREEMAN NEWTON  
GRANTEE: REVONIA NEWTON

| EXTRA FEATURES |            |             |         |     |    |       |    |          |                |           |         |             |   |        |                 |       |
|----------------|------------|-------------|---------|-----|----|-------|----|----------|----------------|-----------|---------|-------------|---|--------|-----------------|-------|
| L N            | OB/XF CODE | DESCRIPTION | BLD CAP | L   | W  | UNITS | UT | Adj R    | ADJ UNIT PRICE | ORIG COND | YEAR ON | YEAR ACTUAL | Q | % COND | OB/XF MKT VALUE | NOTES |
| 1              | 0190       | FPLC PF     | 0       | 100 | 0  | 0     | UT | 1,200.00 | 1,200.00       | 100       | 0       | 0           | 3 | 100    | 1,200           |       |
| 2              | 0294       | SHED WOOD/  | 0       | 100 | 0  | 0     | UT | 0.00     | 0.00           | 100       | 1993    | 1993        | 3 | 100    | 500             |       |
| 3              | 0252       | LEAN-TO W/  | 0       | 100 | 10 | 12    | UT | 2.00     | 2.00           | 100       | 1993    | 1993        | 3 | 100    | 240             |       |
| 4              | 0252       | LEAN-TO W/  | 0       | 100 | 10 | 12    | UT | 2.00     | 2.00           | 100       | 1993    | 1993        | 3 | 100    | 240             |       |
| 5              | 0166       | CONC, PAVMT | 0       | 100 | 0  | 0     | UT | 0.00     | 0.00           | 100       | 1993    | 1993        | 3 | 100    | 1,800           |       |
| 6              | 0120       | CLFENCE 4   | 0       | 100 | 0  | 0     | UT | 0.00     | 0.00           | 100       | 1993    | 1993        | 3 | 100    | 1,800           |       |

| BLD DATE |          | LGL DATE   |         |
|----------|----------|------------|---------|
| XF DATE  | INC DATE | LAND DATE  | AG DATE |
|          |          | 05/06/2026 | MLU     |

| BUILDING NOTES  |  |
|---|--|
| BUILDING DIMENSIONS   |  |
| BAS= W43 S42 E22 FOP= E6 N3E39N4 W21 S2 W12 N2 W12 S7\$ N7E12 S2 E12 N2 E21 FGR= S3 E22N21 W22 S18\$ N18 E22 N12 UOP= N9 W21 S9 E21\$ W21 FSP= N9 W25 S9 E25\$ W25 N5\$ . |  |

| LAND DESCRIPTION |          |     |                      |     |     |          |       |       |             |           |     |          | TOTAL OB/XF |         |            |                |            |                             |      |         |      |     |    |        |  |
|------------------|----------|-----|----------------------|-----|-----|----------|-------|-------|-------------|-----------|-----|----------|-------------|---------|------------|----------------|------------|-----------------------------|------|---------|------|-----|----|--------|--|
| L N              | USE CODE | CLS | LAND USE DESCRIPTION | CAP | R D | LOC ZONE | FRONT | DEPTH | TOT LND UTS | UNIT TYPE | D T | DPH FACT | % COND      | TOT ADJ | UNIT PRICE | ADJ UNIT PRICE | LAND VALUE | OTHER ADJUSTMENTS AND NOTES | YEAR | DENSITY | DECL | FRZ | YR | CONSRV |  |
| 1                | 0100     | C   | SFR                  | 100 |     | A-1      | 0.00  | 0.00  | 2.00        | AC        |     | 1.00     | 1.00        | 1.00    | 16,000.00  | 16,000.00      | 32,000     |                             |      |         |      |     |    |        |  |