

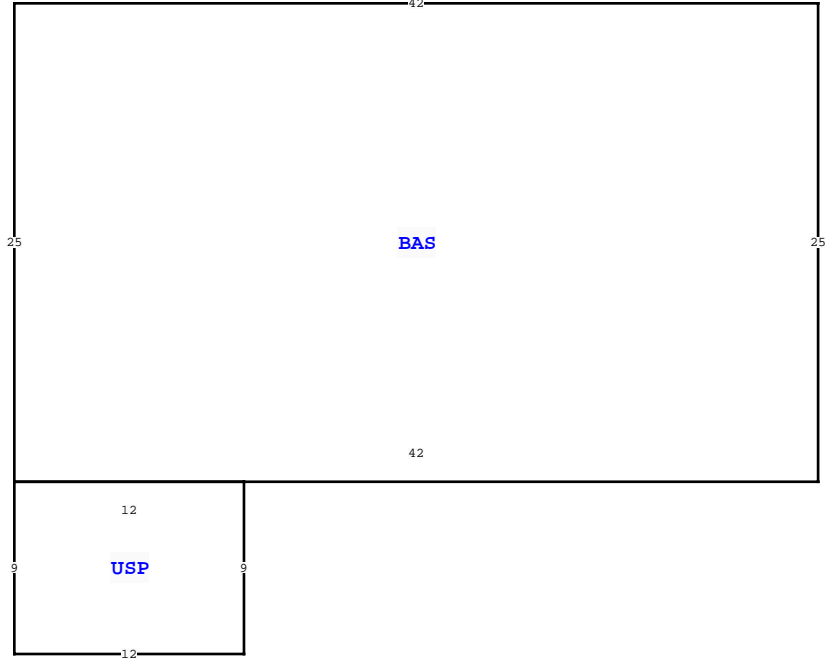

| BUILDING CHARACTERISTICS | | CONSTRUCTION | |
|--------------------------|------------------|---------------|--------|
| ELEMENT | CD | | |
| Exterior Wall | 31 | VINYL SID | 100 |
| Roof Structur | 03 | GABLE/HIP | 100 |
| Roof Cover | 12 | MODULAR MT | 100 |
| Interior Wall | 05 | DRYWALL | 100 |
| Interior Floo | 09 | PINE WOOD | 100 |
| Air Condition | 03 | CENTRAL | 100 |
| Heating Type | 04 | AIR DUCTED | 100 |
| Bedrooms | | 3 | 100 |
| Bathrooms | | 1.5 | 100 |
| Frame | 01 | NONE | 100 |
| Stories | 1. | 1. | 100 |
| Architectual | 05 | CONV | 100 |
| Units | | 0 | 100 |
| Condition Adj | 01 | 01 | 100 |
| Kitchen Adjus | 01 | 01 | 100 |
| Quality | 01 | 01 | |
| DOR CODE | 0100 | SINGLE FAMILY | |
| MAP NUM | | MKT AREA | 07 |
| NEIGHBORHOOD/LOC | 20317.00 | 1.00/ | |
| AREA TYPE | TOTAL GROSS AREA | PCT OF BASE | YEAR |
| BAS | 1,050 | 100 | |
| USP | 108 | 35 | |
| TOTALS | 1,158 | | |
| | | 1,088 | 52,354 |

| MARKET ADJUSTMENTS | | | | | | | | | | | | |
|--------------------|------------|-----------|-------------------|----------------|----------------|------------|------|------|------|-------|--------|--|
| TYPE | MDL | EFF. AREA | TOT ADJ PTS | EFF. BASE RATE | REPL. COST NEW | AYB | EYB | ECON | FNCT | NORM | % COND | |
| 1 | SINGLE FAM | 0% | 0 | 74.03 | 80,545 | 1975 | 1975 | 0 | 0 | 35.00 | 65.00 | |
| | | | Heated Area: 1050 | | | HX Base Yr | | | | | | |



223 NE SUNNYBROOK ST, LAKE CITY

| | | | |
|----------|--|-----------|--|
| BLD DATE | | LGL DATE | |
| XF DATE | | LAND DATE | |
| INC DATE | | AG DATE | |

| EXTRA FEATURES | | | | | | | | | | | | |
|----------------|------------|-------------|-----|-----|---|----|-------|----|-------|----------------|-------------|---------|
| L N | OB/XF CODE | DESCRIPTION | BLD | CAP | L | W | UNITS | UT | Adj R | ADJ UNIT PRICE | ORIG COND | YEAR ON |
| 1 | 0294 | SHED WOOD/ | 0 | 0 | 8 | 12 | 1.00 | UT | 0.00 | 0.00 | 100 | 0 |
| 2 | 0166 | CONC, PAVMT | 0 | 0 | 0 | 0 | 1.00 | UT | 0.00 | 0.00 | 100 | 2009 |
| 3 | 0251 | LEAN TO W/ | 0 | 0 | 0 | 0 | 1.00 | UT | 0.00 | 0.00 | 100 | 0 |
| | | | | | | | | | | | TOTAL OB/XF | 950 |

| LAND DESCRIPTION | | | | | | | | | | | | |
|------------------|----------|-----|----------------------|-----|-----|----------|-------|-------|-------------|-----------|----------------|-----------|
| L N | USE CODE | CLS | LAND USE DESCRIPTION | CAP | R D | LOC ZONE | FRONT | DEPTH | TOT LND UTS | UNIT TYPE | D T | DPHT FACT |
| 1 | 0000 | C | VAC RES | 0 | | 00 | 0.00 | 0.00 | 87,120.00 | SF | | 1.00 |
| | | | | | | | | | | | TOTAL ADJ | 0.25 |
| | | | | | | | | | | | UNIT PRICE | 0.50 |
| | | | | | | | | | | | ADJ UNIT PRICE | 0.13 |
| | | | | | | | | | | | LAND VALUE | 10,890 |

| COLUMBIA COUNTY PROPERTY | | | |
|-------------------------------|-------------------|-----------|-------------|
| VALUATION SUMMARY | | | PAGE 1 of 1 |
| VALUATION BY | | STANDARD | |
| Tax Group: 2 | | Tax Dist: | |
| BUILDING MARKET VALUE | | 52,354 | |
| TOTAL MARKET OB/XF VALUE | | 950 | |
| TOTAL LAND VALUE - MARKET | | 10,890 | |
| TOTAL MARKET VALUE | | 64,194 | |
| SOH/AGL Deduction | | 0 | |
| ASSESSED VALUE | | 64,194 | |
| TOTAL EXEMPTION VALUE | | 0 | |
| BASE TAXABLE VALUE | | 64,194 | |
| TOTAL JUST VALUE | | 64,194 | |
| NCON VALUE | | 0 | |
| INCOME VALUE | | | |
| PREVIOUS YEAR MKT VALUE | | 64,194 | |
| LAND:1:1: ABOUT 1AC IS SWAMPY | | | |
| PERMIT NUM | DESCRIPTION | AMT | ISSUED |
| 000047350 | Electrical Servic | 0 | 06/01/2023 |

| SALES DATA | | | | | | |
|--------------------------------|-----------|-----------|-----|-----|--------|------------|
| OFF RECORD Number | DATE | TYPE INST | Q U | V I | RSN CD | SALE PRICE |
| 1296/2771 | 6/23/2015 | QC | U | I | 11 | 100 |
| GRANTOR: GREGORY STEPHEN CREAM | | | | | | |
| GRANTEE: DONALD EDWARD CREAM | | | | | | |
| 1296/2764 | 6/19/2015 | PR | U | I | 18 | 100 |
| GRANTOR: DONALD E CREAMER (PR | | | | | | |
| GRANTEE: DONALD EDWARD CREAM | | | | | | |

| BUILDING NOTES |
|----------------|
| |

| BUILDING DIMENSIONS |
|--|
| BAS= W42 S25 USP= S9 E12 N9 W12\$ E42 N25\$. |