

LOT 27 HIGH POINTE S/D
 WD 1189-1043, WD 1264-1720,
 QC 1290-593, WD 1352-1231, WD

MCGEE RURMELL/MCGEE ERICKA
 213 NW ANSLEY PLACE
 LAKE CITY, FL 32055

2026

20-3S-16-02202-127

BUILDING CHARACTERISTICS		CONSTRUCTION	
ELEMENT	CD		
Exterior Wall	32	HARDIE BRD	100
Roof Structur	08	IRREGULAR	100
Roof Cover	03	COMP SHNGL	100
Interior Wall	05	DRYWALL	100
Interior Floo	12	HARDWOOD	80
Interior Floo	15	HARDTILE	20
Air Condition	03	CENTRAL	100
Heating Type	04	AIR DUCTED	100
Bedrooms		4	100
Bathrooms		2	100
Frame	02	WOOD FRAME	100
Stories	1.	1.	100
Architectual	05	CONV	100
Units		0	100
Quality	07	07	
DOR CODE	0100	SINGLE FAMILY	
MAP NUM		MKT AREA	01
NEIGHBORHOOD/LOC	20316.00	1.00/	
AREA TYPE	TOTAL GROSS AREA	PCT OF BASE	YEAR
BAS	2,177	100	
FGR	516	55	
FOP	126	30	
FOP	180	30	
TOTALS	2,999		

MARKET ADJUSTMENTS													
TYPE	MDL	EFF. AREA	TOT ADJ PTS	EFF. BASE RATE	REPL. COST NEW	AYB	EYB	ECON	FNCT	NORM	% COND		
0100	01	2,553	125.0480	140.05	357,548	2018	2018	0	0	7.00	93.00		
1 SINGLE FAM 0% - 0 Heated Area: 2177 HX Base Yr													

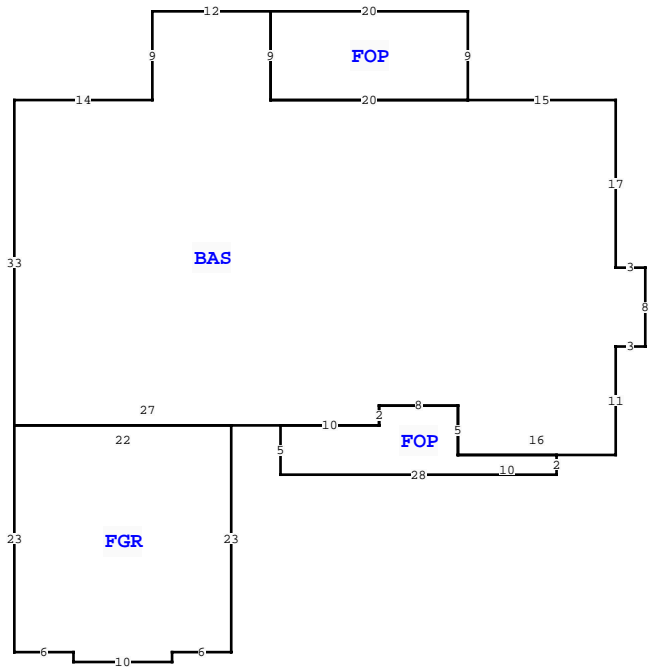

COLUMBIA COUNTY PROPERTY		PAGE 1 of 1	3
VALUATION SUMMARY			
VALUATION BY	STANDARD		
Tax Group: 3	Tax Dist:		
BUILDING MARKET VALUE	332,520		
TOTAL MARKET OB/XF VALUE	5,280		
TOTAL LAND VALUE - MARKET	55,000		
TOTAL MARKET VALUE	392,800		
SOH/AGL Deduction	0		
ASSESSED VALUE	392,800		
TOTAL EXEMPTION VALUE	0		
BASE TAXABLE VALUE	392,800		
TOTAL JUST VALUE	392,800		
NCON VALUE	0		
INCOME VALUE			
PREVIOUS YEAR MKT VALUE	396,375		

PERMIT NUM	DESCRIPTION	AMT	ISSUED
36448	SFR	1,068	03/15/2018

SALES DATA						
OFF RECORD Number	DATE	TYPE INST	Q / U	V / I	RSN CD	SALE PRICE
1370/1821	10/15/2018	WD Q	Q	I	01	295,785
GRANTOR: BROWN ROAD BUILDERS I						
GRANTEE: RURMELL & ERICKA MC						
1352/1231	1/30/2018	WD U	V	V	30	69,500
GRANTOR: BROWN ROAD PROPERTIES						
GRANTEE: BROWN ROAD BUILDERS						

EXTRA FEATURES		213 NW ANSLEY PL, LAKE CITY	
L N	OB/XF CODE	DESCRIPTION	ADJ UNIT PRICE
1	0166	CONC, PAVMT	2.25
2	0169	FENCE/WOOD	1,500.00

BLD DATE	XF DATE	INC DATE	LGL DATE	LAND DATE	AG DATE
			04/20/2026	MLU	

BUILDING NOTES													

BUILDING DIMENSIONS													
BAS= W15 FOP= N9 W20 S9 E20\$ W20 N9 W12 S9 W14 S33 FGR= S23 E6 S1 E10 N1 E6 N23 W22\$ E27 FOP= S5 E28 N2 W10 N5 W8 S2 W10\$ E10 N2 E8 S5 E16 N11 E3 N8 W3 N17\$.													

LAND DESCRIPTION														TOTAL OB/XF										
L N	USE CODE	CLS	LAND USE DESCRIPTION	CAP	R D	LOC ZONE	FRONT	DEPTH	TOT LND UTS	UNIT TYPE	D T	DPH FACT	% COND	TOT ADJ	UNIT PRICE	ADJ UNIT PRICE	LAND VALUE	OTHER ADJUSTMENTS AND NOTES	YEAR	DENSITY	DECL	FRZ	YR	CONSRV
1	0100	C	SFR	0		PRRD	0.00	0.00	1.00	LT		1.00	1.00	1.00	55,000.00	55,000.00	55,000							