

| BUILDING CHARACTERISTICS | | CONSTRUCTION | |
|--------------------------|------------------|--------------|------|
| ELEMENT | CD | | |
| Exterior Wall | 31 | VINYL SID | 100 |
| Roof Structur | 03 | GABLE/HIP | 100 |
| Roof Cover | 03 | COMP SHNGL | 100 |
| Interior Wall | 05 | DRYWALL | 100 |
| Interior Floor | 14 | CARPET | 90 |
| Interior Floor | 08 | SHT VINYL | 10 |
| Air Condition | 03 | CENTRAL | 100 |
| Heating Type | 04 | AIR DUCTED | 100 |
| Bedrooms | | 5 | 100 |
| Bathrooms | | 3 | 100 |
| Stories | 1. | 1. | 100 |
| Architectural | 01 | CONV | 100 |
| Units | | 0 | 100 |
| Condition Adj | 03 | 03 | 100 |
| Kitchen Adjus | 01 | 01 | 100 |
| Quality | 05 | 05 | |
| DOR CODE | 5000 IMPROVED AG | | |
| MAP NUM | | MKT AREA | 02 |
| NEIGHBORHOOD/LOC | 19416.010 1.00/ | | |
| AREA TYPE | TOTAL GROSS AREA | PCT OF BASE | YEAR |
| BAS | 1,512 | 100 | |
| BAS | 3,372 | 100 | |
| FOP | 48 | 35 | |
| PTO | 450 | 5 | |
| PTO | 720 | 5 | |
| UCP | 648 | 20 | |
| TOTALS | 6,750 | | |

| MARKET ADJUSTMENTS | | | | | | | | | | | | |
|--------------------|-------|-----------|-------------|----------------|-------------------|-----|-----------------|------|------|----|------|--------|
| TYPE | MDL | EFF. AREA | TOT ADJ PTS | EFF. BASE RATE | REPL. COST NEW | AYB | EYB | ECON | FNCT | AP | NORM | % COND |
| 2 | MANUF | 1 | 100% | - 2018 | Heated Area: 4884 | | HX Base Yr 2018 | | | | | |

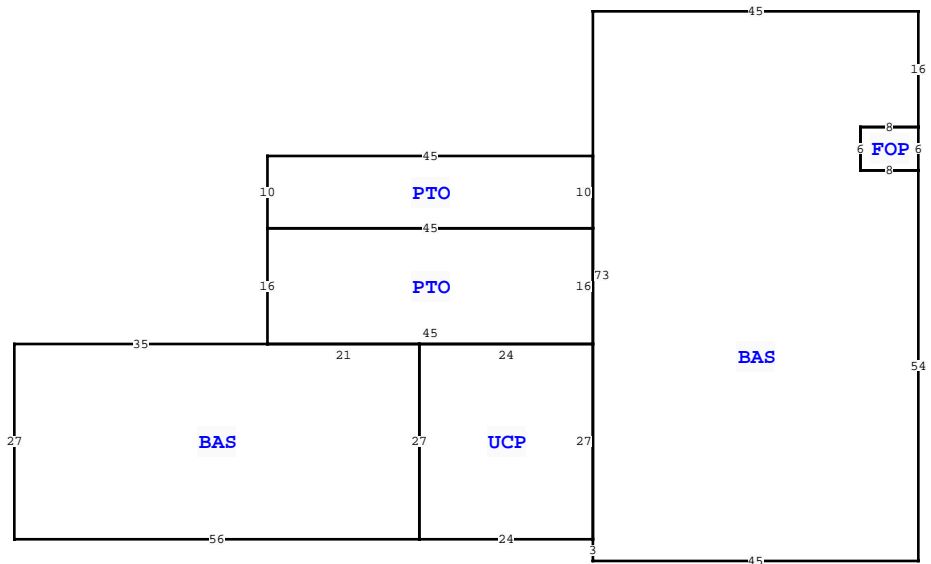

| COLUMBIA COUNTY PROPERTY | | PAGE 1 of 1 | 3 |
|---------------------------|-----------|-------------|----------|
| VALUATION SUMMARY | | | |
| VALUATION BY | | | STANDARD |
| Tax Group: 3 | Tax Dist: | | |
| BUILDING MARKET VALUE | | | 245,196 |
| TOTAL MARKET OB/XF VALUE | | | 24,208 |
| TOTAL LAND VALUE - MARKET | | | 59,500 |
| TOTAL MARKET VALUE | | | 290,462 |
| SOH/AGL Deduction | | | 132,116 |
| ASSESSED VALUE | | | 158,346 |
| TOTAL EXEMPTION VALUE | HX HB | | 51,411 |
| BASE TAXABLE VALUE | | | 106,935 |
| TOTAL JUST VALUE | | | 328,904 |
| NCON VALUE | | | 0 |
| INCOME VALUE | | | |
| PREVIOUS YEAR MKT VALUE | | | 324,404 |

| PERMIT NUM | DESCRIPTION | AMT | ISSUED |
|------------|------------------|--------|------------|
| 000051340 | Roof Replacement | 30,000 | 10/31/2024 |
| 22256 | M H | 250 | 08/30/2004 |

| SALES DATA | | | | | | |
|---------------------------------|-----------|-----------|-------|-------|--------|------------|
| OFF RECORD Number | DATE | TYPE INST | Q / I | V / I | RSN CD | SALE PRICE |
| 1343/1517 | 8/28/2017 | WD Q | Q | I | 01 | 162,000 |
| GRANTOR: DIANE H WARNER (SINGL) | | | | | | |
| GRANTEE: DAVID SCOTT NEHER | | | | | | |
| 0985/0700 | 6/05/2003 | WD Q | Q | I | | 76,300 |
| GRANTOR: HOWARD VAN ARSDALL TS | | | | | | |
| GRANTEE: BRANNON L & DIANE H | | | | | | |

| EXTRA FEATURES | | | | | | | | | | | | | | | | | |
|----------------|------------|-------------|---------|-----|----|-------|----------|-------|----------------|-----------|---------|-------------|------|--------|-----------------|-------|--|
| L N | OB/XF CODE | DESCRIPTION | BLD CAP | L | W | UNITS | UT | Adj R | ADJ UNIT PRICE | ORIG COND | YEAR ON | YEAR ACTUAL | Q | % COND | OB/XF MKT VALUE | NOTES | |
| 1 | 0294 | SHED WOOD/ | 0 | 100 | 12 | 32 | 384.00 | UT | 7.50 | 7.50 | 75 | 2003 | 2003 | 3 | 75 | 2,160 | |
| 2 | 0190 | FPLC PF | 0 | 100 | 0 | 0 | 1.00 | UT | 1,200.00 | 1,200.00 | 100 | 2004 | 2004 | 3 | 100 | 1,200 | |
| 3 | 0060 | CARPORT F | 0 | 100 | 36 | 45 | 1,620.00 | UT | 5.00 | 5.00 | 100 | 2006 | 2006 | 3 | 100 | 8,100 | |
| 4 | 0070 | CARPORT UF | 0 | 100 | 24 | 40 | 1.00 | UT | 0.00 | 0.00 | 100 | 2006 | 2006 | 3 | 100 | 1,080 | |
| 5 | 9945 | Well/Sept | 0 | 100 | 0 | 0 | 1.00 | UT | 7,000.00 | 7,000.00 | 100 | | | 3 | 100 | 7,000 | |
| 6 | 0294 | SHED WOOD/ | 0 | 100 | 12 | 32 | 384.00 | UT | 7.50 | 7.50 | 75 | 2014 | 2014 | 3 | 75 | 2,160 | |
| 7 | 0251 | LEAN TO W/ | 0 | 100 | 12 | 32 | 384.00 | UT | 3.50 | 3.50 | 75 | 2014 | 2014 | 3 | 75 | 1,008 | |
| 8 | 0261 | PRCH, UOP | 0 | 100 | 0 | 0 | 1.00 | UT | 0.00 | 0.00 | 100 | 2014 | 2014 | 3 | 100 | 300 | |
| 9 | 0120 | CLFENCE 4 | 0 | 100 | 0 | 0 | 1.00 | UT | 0.00 | 0.00 | 100 | 2014 | 2014 | 3 | 100 | 1,200 | |

| TOTAL OB/XF | | | | | | | | | | | | 24,208 | | | | | | | | | | | | |
|-------------|----------|-----|----------------------|-----|-----|----------|-------|-------|-------------|-----------|-----|-----------|--------|---------|------------|----------------|------------|-----------------------------|------|---------|------|-----|----|--------|
| L N | USE CODE | CLS | LAND USE DESCRIPTION | CAP | R D | LOC ZONE | FRONT | DEPTH | TOT LND UTS | UNIT TYPE | D T | DPHT FACT | % COND | TOT ADJ | UNIT PRICE | ADJ UNIT PRICE | LAND VALUE | OTHER ADJUSTMENTS AND NOTES | YEAR | DENSITY | DECL | FRZ | YR | CONSRV |
| 1 | 0200 | C | MBL HM | 100 | | A-1 | 0.00 | 0.00 | 1.50 | AC | | 1.00 | 1.00 | 1.00 | 13,000.00 | 13,000.00 | 19,500 | | | | | | | |
| 2 | 5500 | A | TIMBER 2 | 0 | | A-1 | 0.00 | 0.00 | 3.50 | AC | | 1.00 | 1.00 | 1.00 | 445.00 | 445.00 | 1,558 | | | | | | | |
| 3 | 9910 | M | MKT.VAL.AG | 0 | | A-1 | 0.00 | 0.00 | 4.00 | AC | | 1.00 | 1.00 | 1.00 | 10,000.00 | 10,000.00 | 40,000 | | | | | | | |

| BUILDING NOTES | | | |
|----------------|------------|-----|--|
| BLD DATE | | | |
| XF DATE | | | |
| INC DATE | | | |
| LGL DATE | 05/06/2026 | MLU | |
| LAND DATE | | | |
| AG DATE | | | |

| BUILDING DIMENSIONS | | | |
|--|--|--|--|
| BAS= W35 S27 E56 UCP= E24 BAS= S3 E45 N54 FOP= N6 W8 S6 E8\$ | | | |
| W8 N6 E8 N16 W45 S73\$ N27 PTO= N16 PTO= N10 W45 S10 E45\$ W45 | | | |
| S16 E45\$ W24 S27\$ N27 W21\$. | | | |