

| BUILDING CHARACTERISTICS | |
|--------------------------|----------------------|
| ELEMENT | CD CONSTRUCTION |
| Exterior Wall | 32 HARDIE BRD 100 |
| Roof Structur | 03 GABLE/HIP 100 |
| Roof Cover | 14 PREFIN MT 100 |
| Interior Wall | 05 DRYWALL 100 |
| Interior Floor | 13 LAM/VNLPK 90 |
| Interior Floor | 15 HARDTILE 10 |
| Air Condition | 03 CENTRAL 100 |
| Heating Type | 04 AIR DUCTED 100 |
| Bedrooms | 3 100 |
| Bathrooms | 3.5 100 |
| Frame | 01 NONE 100 |
| Stories | 1. 1. 100 |
| Architectual Units | 05 CONV 100 0 100 |
| Condition Adj | 03 03 100 |
| Kitchen Adjus | 01 01 100 |

| MARKET ADJUSTMENTS | | | | | | | | | | | | | |
|---|-----|-----------|-------------|----------------|----------------|------|------|------|------|-------|--------|--|--|
| TYPE | MDL | EFF. AREA | TOT ADJ PTS | EFF. BASE RATE | REPL. COST NEW | AYB | EYB | ECON | FNCT | NORM | % COND | | |
| 0300 | 01 | 2,281 | 133.1616 | 162.46 | 370,571 | 1977 | 2000 | 0 | 0 | 25.00 | 75.00 | | |
| 1 SFR PILING 0% - 2022 Heated Area: 1552 HX Base Yr | | | | | | | | | | | | | |

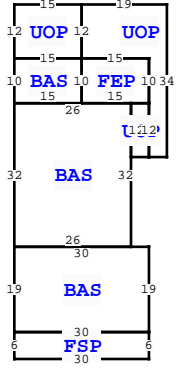
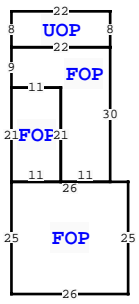

| Quality | 07 07 | | | | |
|------------------|--------------------|-------------|------|--------------|----------------------|
| DOR CODE | 0100 SINGLE FAMILY | | | | |
| MAP NUM | MKT AREA 02 | | | | |
| NEIGHBORHOOD/LOC | 18716.010 1.00/ | | | | |
| AREA TYPE | TOTAL GROSS AREA | PCT OF BASE | YEAR | TOT ADJ AREA | SUBAREA MARKET VALUE |
| BAS | 150 | 100 | | 150 | 18,277 |
| BAS | 570 | 100 | | 570 | 69,452 |
| BAS | 832 | 100 | | 832 | 101,375 |
| FEP | 150 | 80 | | 120 | 14,621 |
| FOP | 231 | 30 | | 69 | 8,408 |
| FOP | 429 | 30 | | 129 | 15,718 |
| FOP | 650 | 30 | | 195 | 23,760 |
| FSP | 180 | 40 | | 72 | 8,773 |
| UOP | 48 | 20 | | 10 | 1,219 |
| UOP | 176 | 20 | | 35 | 4,265 |
| TOTALS | 3,912 | | | 2,281 | 277,928 |

** This building has 12 Sub-Areas

| | |
|----------|-----------|
| BLD DATE | LGL DATE |
| XF DATE | LAND DATE |
| INC DATE | AG DATE |

846 SW BLUFF DR, FORT WHITE

| COLUMBIA COUNTY PROPERTY | | PAGE 1 of 1 | 3 |
|---------------------------|-----------|-------------|---|
| VALUATION SUMMARY | | | |
| VALUATION BY | STANDARD | | |
| Tax Group: 3 | Tax Dist: | | |
| BUILDING MARKET VALUE | 277,928 | | |
| TOTAL MARKET OB/XF VALUE | 19,676 | | |
| TOTAL LAND VALUE - MARKET | 75,000 | | |
| TOTAL MARKET VALUE | 372,604 | | |
| SOH/AGL Deduction | 0 | | |
| ASSESSED VALUE | 372,604 | | |
| TOTAL EXEMPTION VALUE | 0 | | |
| BASE TAXABLE VALUE | 372,604 | | |
| TOTAL JUST VALUE | 372,604 | | |
| NCON VALUE | 0 | | |
| INCOME VALUE | | | |
| PREVIOUS YEAR MKT VALUE | 376,310 | | |

| PERMIT NUM | DESCRIPTION | AMT | ISSUED |
|------------|-------------|-----|------------|
| 26766 | ADDN SFR | 333 | 02/15/2008 |

| SALES DATA | | | | | | |
|-----------------------------|-----------|-----------|-------|-------|--------|------------|
| OFF RECORD Number | DATE | TYPE INST | Q / U | V / I | RSN CD | SALE PRICE |
| 1459/676 | 7/22/2021 | WD | U | I | 11 | 100 |
| GRANTOR: SPILLERS BILLY JIM | | | | | | |
| GRANTEE: SPILLERS BILLY J & | | | | | | |
| 1427/1597 | 1/05/2021 | WD | Q | I | 01 | 355,000 |
| GRANTOR: BROOKS RICHARD C | | | | | | |
| GRANTEE: SPILLERS BILLY JIM | | | | | | |

| BUILDING NOTES | |
|----------------|--|
| | |

| BUILDING DIMENSIONS | |
|--|--|
| BAS=[ORIG=-4,0] W26 S32 E26 N32 \$ | |
| FOP=[ORIG=40,-50] S25 E26 N25 W26 \$ | |
| BAS=[ORIG=-30,32] S19 E30 N19 W30 \$ | |
| FOP=[ORIG=51,-50] E11 N30 W22 S9 E11 S21 \$ | |
| UOP=[ORIG=0,0] S12 E4 N34 W19 S12 E15 S10 \$ | |
| FOP=[ORIG=40,-50] E11 N21 W11 S21 \$ | |
| UOP=[ORIG=-15,-10] N12 W15 S12 E15 \$ | |
| FSP=[ORIG=-30,51] S6 E30 N6 W30 \$ | |
| UOP=[ORIG=62,-80] N8 W22 S8 E22 \$ | |
| FEP=[ORIG=0,0] N10 W15 S10 E15 \$ | |
| BAS=[ORIG=-15,-10] W15 S10 E15 N10 \$ | |
| UOP=[ORIG=0,0] W4 S12 E4 N12 \$ | |

| EXTRA FEATURES | | | | | | | | | | | | | | | |
|----------------|------------|-------------|---------|---------|--------|----|-----------|----------------|-----------|---------|-------------|---|--------|-----------------|-------|
| L N | OB/XF CODE | DESCRIPTION | BLD CAP | L W | UNITS | UT | Adj R | ADJ UNIT PRICE | ORIG COND | YEAR ON | YEAR ACTUAL | Q | % COND | OB/XF MKT VALUE | NOTES |
| 1 | 0070 | CARPORT UF | 0 | 0 24 30 | 720.00 | UT | 3.00 | 3.00 | 100 | 1993 | 1993 | 3 | 100 | 2,160 | |
| 2 | 0084 | DOCK-RIVER | 0 | 0 0 0 | 520.00 | UT | 14.50 | 14.50 | 100 | 1980 | 1980 | 3 | 40 | 3,016 | |
| 3 | 0040 | BARN,POLE | 0 | 0 24 40 | 1.00 | UT | 0.00 | 0.00 | 100 | 2001 | 2001 | 3 | 100 | 2,400 | |
| 4 | 0080 | DECKING | 0 | 0 40 70 | 280.00 | UT | 7.50 | 7.50 | 100 | 2008 | 2008 | 3 | 100 | 2,100 | |
| 5 | 0090 | ELEV.FGHT | 0 | 0 0 0 | 1.00 | UT | 10,000.00 | 10,000.00 | 100 | 2021 | 1977 | | 100 | 10,000 | |

| LAND DESCRIPTION | | | | | | | | | | | | | | TOTAL OB/XF | | | | | | | | | | |
|------------------|----------|-----|----------------------|-----|-----|----------|-------|-------|-------------|-----------|-----|-----------|--------|-------------|------------|----------------|------------|-----------------------------|------|---------|------|-----|----|--------|
| L N | USE CODE | CLS | LAND USE DESCRIPTION | CAP | R D | LOC ZONE | FRONT | DEPTH | TOT LND UTS | UNIT TYPE | D T | DPTH FACT | % COND | TOT ADJ | UNIT PRICE | ADJ UNIT PRICE | LAND VALUE | OTHER ADJUSTMENTS AND NOTES | YEAR | DENSITY | DECL | FRZ | YR | CONSRV |
| 1 | 0100 | C | SFR | 0 | | A-1 | 0.00 | 0.00 | 100.00 | FF | | 1.00 | 1.00 | 1.00 | 750.00 | 750.00 | 75,000 | | | | | | | |