

BUILDING CHARACTERISTICS	
ELEMENT	CD
Exterior Wall	05 AVERAGE 100
Roof Structur	03 GABLE/HIP 100
Roof Cover	12 MODULAR MT 100
Interior Wall	04 PLYWOOD 100
Interior Floor	14 CARPET 80
Interior Floor	08 SHT VINYL 20
Air Condition	01 NONE 100
Heating Type	01 NONE 100
Bedrooms	3 100
Bathrooms	2 100
Frame	01 NONE 100
Stories	1. 1. 100
Architectual Units	05 CONV 100 0 100
Condition Adj	03 03 100
Kitchen Adjus	01 01 100
Quality	05 05
DOR CODE	0100 SINGLE FAMILY

MARKET ADJUSTMENTS													
TYPE	MDL	EFF. AREA	TOT ADJ PTS	EFF. BASE RATE	REPL. COST NEW	AYB	EYB	ECON	FNCT	NORM	% COND		
1	SFR	PILING	0%	- 2021								Heated Area: 672	HX Base Yr

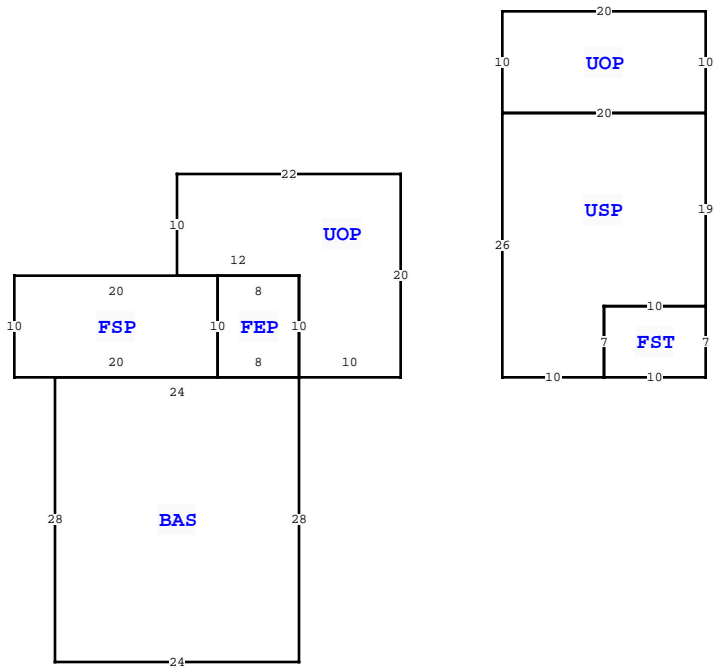

AREA TYPE	TOTAL GROSS AREA	PCT OF BASE	YEAR	TOT ADJ AREA	SUBAREA MARKET VALUE
BAS	672	100		672	51,980
FEP	80	80		64	4,951
FSP	200	40		80	6,188
FST	70	55		38	2,939
UOP	200	20		40	3,094
USP	320	20		64	4,951
USP	450	35		158	12,221
<b>TOTALS</b>	<b>1,992</b>			<b>1,116</b>	<b>86,325</b>

1084 SW BLUFF DR, FORT WHITE

BLD DATE		LGL DATE	
XF DATE		LAND DATE	
INC DATE		AG DATE	

COLUMBIA COUNTY PROPERTY			PAGE 1 of 1	3
VALUATION SUMMARY				
VALUATION BY		STANDARD		
Tax Group: 3	Tax Dist:			
BUILDING MARKET VALUE		86,325		
TOTAL MARKET OB/XF VALUE		0		
TOTAL LAND VALUE - MARKET		75,000		
TOTAL MARKET VALUE		161,325		
SOH/AGL Deduction		0		
ASSESSED VALUE		161,325		
TOTAL EXEMPTION VALUE		0		
BASE TAXABLE VALUE		161,325		
TOTAL JUST VALUE		161,325		
NCON VALUE		0		
INCOME VALUE				
PREVIOUS YEAR MKT VALUE		161,325		

PERMIT NUM	DESCRIPTION	AMT	ISSUED
32351	ADDN SFR	110	10/02/2014
30513	MAINT/ALTR	30	10/11/2012

SALES DATA						
OFF RECORD Number	DATE	TYPE INST	Q U	V I	RSN CD	SALE PRICE
1423/0617	10/23/2020	TR	U	I	11	100
GRANTOR: JOHN M LAW II & DONALD						
GRANTEE: NANCY P LAW & BETSY						
1319/0196	7/20/2016	TR	U	I	11	100
GRANTOR: BETTY J LAW & JOHN M						
GRANTEE: BETTY J LAW & JOHN						

BUILDING NOTES	

BUILDING DIMENSIONS	
FEP= N10 W8 FSP= W20 S10 E20 N10\$ S10 E8\$ BAS= W24 S28 E24 N28\$ UOP= E10 N20 W22 S10 E12 S10\$ PTR= E20 USP= E10 FST= E10 N7W10 S7\$ N7 E10 N19 UOP= N10W20 S10 E20\$ W20 S26\$ W20\$.	

L N	OB/XF CODE	DESCRIPTION	BLD CAP	L	W	UNITS	UT	Adj R	ADJ UNIT PRICE	ORIG COND	YEAR ON	YEAR ACTUAL	Q	% COND	OB/XF MKT VALUE	NOTES

LAND DESCRIPTION										TOTAL OB/XF														
L N	USE CODE	CLS	LAND USE DESCRIPTION	CAP	R D	LOC ZONE	FRONT	DEPTH	TOT LND UTS	UNIT TYPE	D T	DPH FACT	% COND	TOT ADJ	UNIT PRICE	ADJ UNIT PRICE	LAND VALUE	OTHER ADJUSTMENTS AND NOTES	YEAR	DENSITY	DECL	FRZ	YR	CONSRV
1	0100	C	SFR	0		A-1	0.00	0.00	100.00	FF		1.00	1.00	1.00	750.00	750.00	75,000							