

| BUILDING CHARACTERISTICS | | CONSTRUCTION | |
|--------------------------|------------------|--------------|------|
| ELEMENT | CD | | |
| Exterior Wall | 31 | VINYL SID | 100 |
| Roof Structur | 03 | GABLE/HIP | 100 |
| Roof Cover | 12 | MODULAR MT | 100 |
| Interior Wall | 05 | DRYWALL | 100 |
| Interior Floor | 14 | CARPET | 90 |
| Interior Floor | 08 | SHT VINYL | 10 |
| Air Condition | 03 | CENTRAL | 100 |
| Heating Type | 04 | AIR DUCTED | 100 |
| Bedrooms | | 3 | 100 |
| Bathrooms | | 2 | 100 |
| Stories | 1. | 1. | 100 |
| Architactual | 01 | CONV | 100 |
| Units | | 0 | 100 |
| Condition Adj | 03 | 03 | 100 |
| Kitchen Adjus | 01 | 01 | 100 |
| Quality | 05 | 05 | |
| DOR CODE | 0200 MOBILE HOME | | |
| MAP NUM | | MKT AREA | 03 |
| NEIGHBORHOOD/LOC | 13316.040 1.00/ | | |
| AREA TYPE | TOTAL GROSS AREA | PCT OF BASE | YEAR |
| BAS | 1,404 | 100 | |
| UOP | 120 | 25 | |
| UOP | 192 | 25 | |
| TOTALS | 1,716 | | |

| MARKET ADJUSTMENTS | | | | | | | | | | | | | |
|---|-----|-----------|-------------|----------------|----------------|------|------|------|------|-------|--------|--|--|
| TYPE | MDL | EFF. AREA | TOT ADJ PTS | EFF. BASE RATE | REPL. COST NEW | AYB | EYB | ECON | FNCT | NORM | % COND | | |
| 0201 | 02 | 1,482 | 115.9000 | 108.95 | 161,464 | 2002 | 2002 | 0 | 0 | 45.00 | 55.00 | | |
| 1 MANUF 1 0% - 0 Heated Area: 1404 HX Base Yr | | | | | | | | | | | | | |

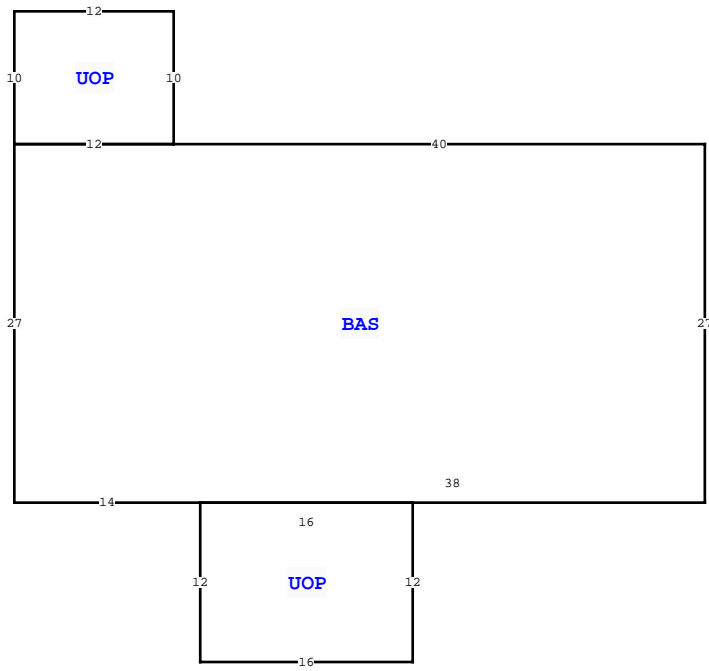

| VALUATION BY | | STANDARD |
|---------------------------|-----------|----------|
| Tax Group: 3 | Tax Dist: | |
| BUILDING MARKET VALUE | | 88,805 |
| TOTAL MARKET OB/XF VALUE | | 22,485 |
| TOTAL LAND VALUE - MARKET | | 24,000 |
| TOTAL MARKET VALUE | | 135,290 |
| SOH/AGL Deduction | | 15,388 |
| ASSESSED VALUE | | 119,902 |
| TOTAL EXEMPTION VALUE | | 0 |
| BASE TAXABLE VALUE | | 119,902 |
| TOTAL JUST VALUE | | 135,290 |
| NCON VALUE | | 0 |
| INCOME VALUE | | |
| PREVIOUS YEAR MKT VALUE | | 129,790 |

| PERMIT NUM | DESCRIPTION | AMT | ISSUED |
|------------|-------------|-----|------------|
| 18858 | M H | 125 | 10/18/2001 |

| SALES DATA | | | | | | |
|-------------------|-----------|-----------|-------|-------|--------|------------|
| OFF RECORD Number | DATE | TYPE INST | Q / U | V / I | RSN CD | SALE PRICE |
| 1565/532 | 4/01/2026 | LE U | | I | 14 | 100 |

GRANTOR: ADAMS LLOYD DANIEL (L)
GRANTEE: ADAMS LLOYD DANIEL
1004/0546 12/30/2003 WD Q I 03 32,000
GRANTOR: WACHOVIA BANK NATIONA
GRANTEE: DEPENDABLE PROPERTI

| EXTRA FEATURES | | 343 NW PATRIOT CT, LAKE CITY | | | | | | | | | | | | | | | |
|----------------|------------|------------------------------|-----|-----|---|---|-------|----|----------|----------------|-----------|---------|-------------|---|--------|-----------------|-------|
| L N | OB/XF CODE | DESCRIPTION | BLD | CAP | L | W | UNITS | UT | Adj R | ADJ UNIT PRICE | ORIG COND | YEAR ON | YEAR ACTUAL | Q | % COND | OB/XF MKT VALUE | NOTES |
| 1 | 0296 | SHED METAL | 0 | 0 | 0 | 0 | 1.00 | UT | 0.00 | 0.00 | 100 | 2018 | 2018 | 3 | 100 | 500 | |
| 2 | 0100 | ELEV. PASS | 0 | 0 | 0 | 0 | 1.00 | UT | 0.00 | 0.00 | 100 | 2018 | 2018 | 3 | 100 | 4,995 | |
| 3 | 9945 | Well/Sept | 0 | 0 | 0 | 0 | 1.00 | UT | 7,000.00 | 7,000.00 | 100 | | | 3 | 100 | 7,000 | |
| 4 | 0294 | SHED WOOD/ | 0 | 0 | 0 | 0 | 1.00 | UT | 0.00 | 0.00 | 100 | 2018 | 2018 | 3 | 100 | 4,995 | |
| 5 | 0294 | SHED WOOD/ | 0 | 0 | 0 | 0 | 1.00 | UT | 0.00 | 0.00 | 100 | 2018 | 2018 | 3 | 100 | 4,995 | |

| LAND DESCRIPTION | | TOTAL OB/XF 22,485 | | | | | | | | | | | | | | | | | | | | | | |
|------------------|----------|--------------------|----------------------|-----|-----|----------|-------|-------|-------------|-----------|-----|----------|--------|---------|------------|----------------|------------|-----------------------------|------|---------|------|-----|----|--------|
| L N | USE CODE | CLS | LAND USE DESCRIPTION | CAP | R D | LOC ZONE | FRONT | DEPTH | TOT LND UTS | UNIT TYPE | D T | DPH FACT | % COND | TOT ADJ | UNIT PRICE | ADJ UNIT PRICE | LAND VALUE | OTHER ADJUSTMENTS AND NOTES | YEAR | DENSITY | DECL | FRZ | YR | CONSRV |
| 1 | 0200 | C | MBL HM | 0 | | RSF-1 | 0.00 | 0.00 | 1.00 | LT | | 1.00 | 1.20 | 1.20 | 20,000.00 | 24,000.00 | 24,000 | | | | | | | |

| BUILDING NOTES | |
|----------------|--|
| | |

| BUILDING DIMENSIONS | |
|---|--|
| BAS= W40 UOP= N10 W12 S10 E12\$ W12 S27 E14 UOP= S12 E16 N12 W16\$ E38 N27\$. | |