

BUILDING CHARACTERISTICS		CONSTRUCTION	
ELEMENT	CD		
Exterior Wall	27	PREFIN MTL	100
Roof Structur	10	STEEL FRME	100
Roof Cover	03	COMP SHNGL	90
Roof Cover	14	PREFIN MT	10
Interior Wall	05	DRYWALL	100
Interior Floor	14	CARPET	80
Interior Floor	15	HARDTILE	20
Ceiling	01	FIN.SUSPD	100
Air Condition	06	ENG CENTRL	100
Heating Type	09	ENG F AIR	100
Fixtures		22	100
Frame	05	STEEL	100
Story Height		24	100
RMS		23	100
Stories	1.	1.	100
Units		0	100
Quality	08	08	
DOR CODE	7210	CHARTER SCHOOL	
MAP NUM		MKT AREA	01
NEIGHBORHOOD/LOC	11516.00	1.00/	
AREA TYPE	TOTAL GROSS AREA	PCT OF BASE	YEAR
BAS	18,000	100	
CAN	992	30	
UST	750	40	
UST	1,150	40	
TOTALS	20,892		19,058

MARKET ADJUSTMENTS												
TYPE	MDL	EFF. AREA	TOT ADJ PTS	EFF. BASE RATE	REPL. COST NEW	AYB	EYB	ECON	FNCT	NORM	% COND	
1	SCH/PUBLIC	0%	- 0									
			Heated Area:	18000				HX Base Yr				

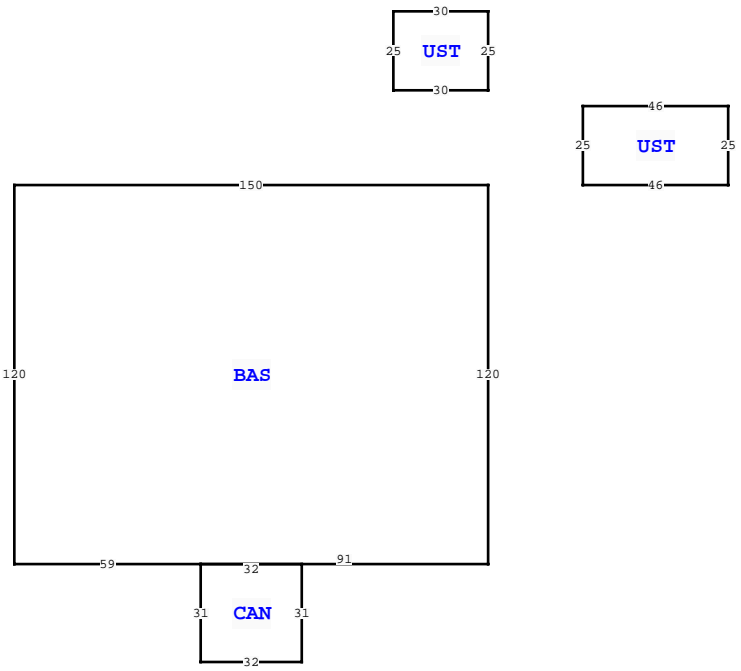

COLUMBIA COUNTY PROPERTY			
VALUATION SUMMARY			PAGE 1 of 4
VALUATION BY			STANDARD
Tax Group: 3	Tax Dist:		
BUILDING MARKET VALUE			8,569,556
TOTAL MARKET OB/XF VALUE			282,434
TOTAL LAND VALUE - MARKET			241,230
TOTAL MARKET VALUE			9,093,220
SOH/AGL Deduction			223,019
ASSESSED VALUE			8,870,201
TOTAL EXEMPTION VALUE	08	8,870,201	
BASE TAXABLE VALUE			0
TOTAL JUST VALUE			9,093,220
NCON VALUE			0
INCOME VALUE			
PREVIOUS YEAR MKT VALUE			9,184,892
XFOB:19:1:	SCHOOL		
XFOB:18:1:	SCHOOL		
XFOB:17:1:	SCHOOL		
SALE:17:1:	NEW CONSTRUCTION INVOLVED		
PERMIT NUM	DESCRIPTION	AMT	ISSUED
000044274	New Commercial Co	19,785	04/26/2022
000041977	Additions	100,000	05/21/2021
40877	REMODEL	0	11/11/2020
40136	REMODEL	0	07/10/2020
36704	ADDN COMM	1,033	05/09/2018
33785	COMMERCIAL	2,138	02/23/2016

SALES DATA						
OFF RECORD Number	DATE	TYPE INST	Q / U	V / I	RSN CD	SALE PRICE
1325/0521	11/01/2016	WD	U	I	17	2,755,000
GRANTOR: MTM CAPITAL HOLDINGS						
GRANTEE: BELMONT ACADEMY INC						
1274/1920	4/14/2014	WD	U	I	17	100
GRANTOR: MOUNTAINTOP MINISTERIE						
GRANTEE: MTM CAPITAL HOLDING						

EXTRA FEATURES										
L N	OB/XF CODE	DESCRIPTION	BLD CAP	L	W	UNITS	UT	Adj R	ADJ UNIT PRICE	ORIG COND
1	0260	PAVEMENT-A	0	0	100	350	UT	1.60	1.60	100
2	0260	PAVEMENT-A	0	0	450	20	UT	1.60	1.60	100
3	0260	PAVEMENT-A	0	0	200	200	UT	1.60	1.60	100
4	0261	PRCH, UOP	0	0	80	80	UT	7.00	7.00	100
5	0260	PAVEMENT-A	0	0	20	675	UT	1.60	1.60	100
6	0166	CONC, PAVMT	0	0	200	10	UT	2.00	2.00	100
7	0166	CONC, PAVMT	0	0	0	0	UT	0.00	0.00	100
8	0040	BARN, POLE	0	0	48	144	UT	2.00	2.00	100
9	0040	BARN, POLE	0	0	13	20	UT	0.00	0.00	100
10	0262	PRCH, FOP	0	0	0	0	UT	0.00	0.00	100

TOTAL OB/XF												
												217,624
BLD DATE		LGL DATE										
XF DATE		LAND DATE										
INC DATE		AG DATE										

BUILDING NOTES									
BUILDING DIMENSIONS									
BAS= W150 S120 E59 CAN= S31 E32 N31 W32\$ E91 N120\$ PTR= N30									
UST= N25 W30 S25 E30\$ S30\$ PTR= E30 UST= E46 N25 W46 S25\$ W30\$.									

LAND DESCRIPTION															TOTAL OB/XF									
L N	USE CODE	CLS	LAND USE DESCRIPTION	CAP	R D	LOC ZONE	FRONT	DEPTH	TOT LND UTS	UNIT TYPE	D T	DPHT FACT	% COND	TOT ADJ	UNIT PRICE	ADJ UNIT PRICE	LAND VALUE	OTHER ADJUSTMENTS AND NOTES	YEAR	DENSITY	DECL	FRZ	YR	CONSRV
1	7210	C	CHARTER SCHO	0		A-1	0.00	0.00	24.87	AC		1.00	1.00	1.00	8,500.00	8,500.00	211,395							
2	7210	C	CHARTER SCHO	0		A-1	0.00	0.00	3.51	AC		1.00	1.00	1.00	8,500.00	8,500.00	29,835							



BUILDING CHARACTERISTICS		CONSTRUCTION	
ELEMENT	CD		
Exterior Wall	27	PREFIN MTL	100
Roof Structur	10	STEEL FRME	100
Roof Cover	14	PREFIN MT	100
Interior Wall	05	DRYWALL	100
Interior Floo	15	HARDTILE	100
Ceiling	01	FIN.SUSPD	100
Air Condition	06	ENG CENTRL	100
Heating Type	09	ENG F AIR	100
Fixtures		18	100
Frame	05	STEEL	100
Story Height		16	100
RMS		4	100
Stories	1.	1.	100
Units		0	100
Quality	08	08	
DOR CODE	7210	CHARTER SCHOOL	
MAP NUM		MKT AREA	01
NEIGHBORHOOD/LOC	11516.00	1.00/	
AREA TYPE	TOTAL GROSS AREA	PCT OF BASE	YEAR
BAS	6,461	100	
TOTALS	6,461		6,461,248,253

MARKET ADJUSTMENTS													
TYPE	MDL	EFF. AREA	TOT ADJ PTS	EFF. BASE RATE	REPL. COST NEW	AYB	EYB	ECON	FNCT	NORM	% COND		
3	SCH/PUBLIC	0%	0									Heated Area: 6461 HX Base Yr	
TOTALS	6,461											6,461,248,253	

EXTRA FEATURES																
L N	OB/XF CODE	DESCRIPTION	BLD CAP	L	W	UNITS	UT	Adj R	ADJ UNIT PRICE	ORIG COND	YEAR ON	YEAR ACTUAL	Q	% COND	OB/XF MKT VALUE	NOTES
11	0020	BARN,FR	0	0	30	30	1.00	UT	0.00	100	1999	1999	3	100	14,850	
12	0020	BARN,FR	0	0	15	26	390.00	UT	64.00	100	2000	2000	3	100	24,960	
13	0260	PAVEMENT-A	0	0	0	0	1.00	UT	25,000.00	100	2022	2021		100	25,000	

LAND DESCRIPTION														TOTAL OB/XF										
L N	USE CODE	CLS	LAND USE DESCRIPTION	CAP	R D	LOC ZONE	FRONT	DEPTH	TOT LND UTS	UNIT TYPE	D T	DPHT FACT	% COND	TOT ADJ	UNIT PRICE	ADJ UNIT PRICE	LAND VALUE	OTHER ADJUSTMENTS AND NOTES	YEAR	DENSITY	DECL	FRZ	YR	CONSRV
														64,810										

COLUMBIA COUNTY PROPERTY			
VALUATION SUMMARY			
VALUATION BY	STANDARD		
Tax Group: 3	Tax Dist:		
BUILDING MARKET VALUE	8,569,556		
TOTAL MARKET OB/XF VALUE	282,434		
TOTAL LAND VALUE - MARKET	241,230		
TOTAL MARKET VALUE	9,093,220		
SOH/AGL Deduction	223,019		
ASSESSED VALUE	8,870,201		
TOTAL EXEMPTION VALUE	08	8,870,201	
BASE TAXABLE VALUE	0		
TOTAL JUST VALUE	9,093,220		
NCON VALUE	0		
INCOME VALUE			
PREVIOUS YEAR MKT VALUE	9,184,892		
XFOB:16:1: SCHOOL			
SALE:10:1: 4.01 ACRES WITH IMPROVEMENTS			
SALE:2:1: \$.70 STAMPS			
SALE:1:1: 3 DEEDS SEE 807-1661-1663.			
PERMIT NUM	DESCRIPTION	AMT	ISSUED
33162	COMMERCIAL	425	07/09/2015
32095	CHURCH	425	07/03/2014

SALES DATA						
OFF RECORD Number	DATE	TYPE INST	Q U	V I	RSN CD	SALE PRICE
1325/0521	11/01/2016	WD U	I	I	17	2,755,000
GRANTOR: MTM CAPITAL HOLDINGS						
GRANTEE: BELMONT ACADEMY INC						
1274/1920	4/14/2014	WD U	I	I	17	100
GRANTOR: MOUNTAINTOP MINISTERIE						
GRANTEE: MTM CAPITAL HOLDING						

BUILDING NOTES

BUILDING DIMENSIONS
BAS= W71 S91 E71 N91\$.

