

| BUILDING CHARACTERISTICS |                  | CONSTRUCTION  |      |
|--------------------------|------------------|---------------|------|
| ELEMENT                  | CD               |               |      |
| Exterior Wall            | 19               | COMMON BRK    | 100  |
| Roof Structur            | 08               | IRREGULAR     | 100  |
| Roof Cover               | 03               | COMP SHNGL    | 100  |
| Interior Wall            | 05               | DRYWALL       | 100  |
| Interior Floor           | 14               | CARPET        | 80   |
| Interior Floor           | 15               | HARDTILE      | 20   |
| Air Condition            | 03               | CENTRAL       | 100  |
| Heating Type             | 04               | AIR DUCTED    | 100  |
| Bedrooms                 |                  | 3             | 100  |
| Bathrooms                |                  | 2             | 100  |
| Frame                    | 02               | WOOD FRAME    | 100  |
| Stories                  | 1.               | 1.            | 100  |
| Architectural            | 05               | CONV          | 100  |
| Units                    |                  | 0             | 100  |
| Quality                  | 06               | 06            |      |
| DOR CODE                 | 0100             | SINGLE FAMILY |      |
| MAP NUM                  |                  | MKT AREA      | 06   |
| NEIGHBORHOOD/LOC         | 11416.00         | 1.00/         |      |
| AREA TYPE                | TOTAL GROSS AREA | PCT OF BASE   | YEAR |
| BAS                      | 2,089            | 100           |      |
| FGR                      | 627              | 55            |      |
| FOP                      | 168              | 30            |      |
| FSP                      | 290              | 40            |      |
| TOTALS                   | 3,174            |               |      |

| MARKET ADJUSTMENTS |            |           |             |                   |                |     |                 |      |      |      |        |
|--------------------|------------|-----------|-------------|-------------------|----------------|-----|-----------------|------|------|------|--------|
| TYPE               | MDL        | EFF. AREA | TOT ADJ PTS | EFF. BASE RATE    | REPL. COST NEW | AYB | EYB             | ECON | FNCT | NORM | % COND |
| 1                  | SINGLE FAM | 100%      | - 2026      |                   |                |     |                 |      |      |      |        |
|                    |            |           |             | Heated Area: 2089 |                |     | HX Base Yr 2026 |      |      |      |        |

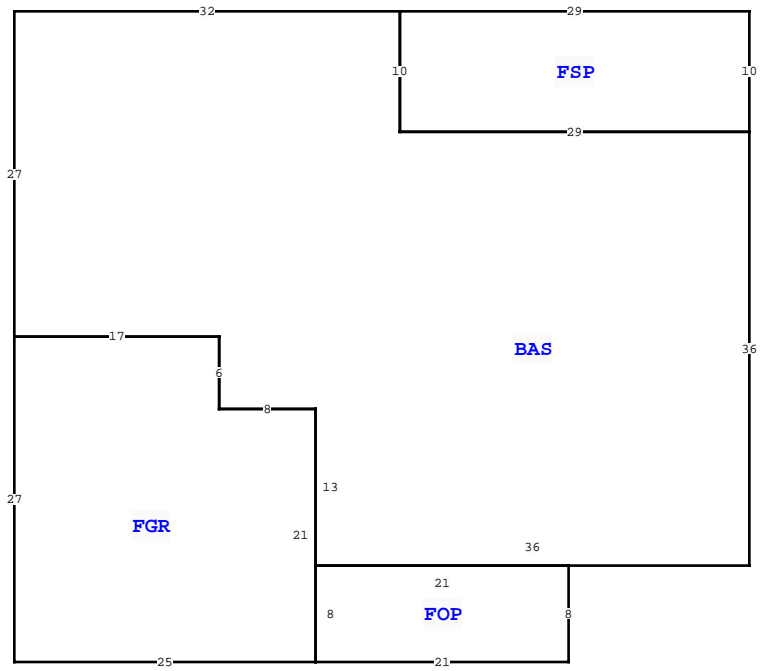

| COLUMBIA COUNTY PROPERTY  |          | PAGE 1 of 1       | 2 |
|---------------------------|----------|-------------------|---|
| VALUATION BY              |          | VALUATION SUMMARY |   |
| Tax Group: 2              | STANDARD |                   |   |
| BUILDING MARKET VALUE     | 311,981  | Tax Dist:         |   |
| TOTAL MARKET OB/XF VALUE  | 15,010   |                   |   |
| TOTAL LAND VALUE - MARKET | 56,000   |                   |   |
| TOTAL MARKET VALUE        | 382,991  |                   |   |
| SOH/AGL Deduction         | 234,084  |                   |   |
| ASSESSED VALUE            | 148,907  |                   |   |
| TOTAL EXEMPTION VALUE     | 51,411   | HX HB             |   |
| BASE TAXABLE VALUE        | 97,496   |                   |   |
| TOTAL JUST VALUE          | 382,991  |                   |   |
| NCON VALUE                | 0        |                   |   |
| INCOME VALUE              |          |                   |   |
| PREVIOUS YEAR MKT VALUE   | 386,419  |                   |   |

| PERMIT NUM | DESCRIPTION | AMT | ISSUED     |
|------------|-------------|-----|------------|
| 33899      | SFR         | 880 | 03/29/2016 |

| SALES DATA                     |            |           |     |     |        |            |
|--------------------------------|------------|-----------|-----|-----|--------|------------|
| OFF RECORD Number              | DATE       | TYPE INST | Q U | V I | RSN CD | SALE PRICE |
| 1551/2288                      | 10/10/2025 | WD        | Q   | I   | 01     | 445,000    |
| GRANTOR: GOTTSCHALK ROBIN R    |            |           |     |     |        |            |
| GRANTEE: LUETTICH FAMILY LIV   |            |           |     |     |        |            |
| 1349/1617                      | 12/12/2017 | LE        | U   | I   | 14     | 0          |
| GRANTOR: PATRICIA WASLEY MORRI |            |           |     |     |        |            |
| GRANTEE: ROBIN GOTTSCHALK &    |            |           |     |     |        |            |

| EXTRA FEATURES |            | 578 SW MAYFAIR LN, LAKE CITY |                |
|----------------|------------|------------------------------|----------------|
| L N            | OB/XF CODE | DESCRIPTION                  | ADJ UNIT PRICE |
| 1              | 0166       | CONC, PAVMT                  | 2,255.00       |
| 2              | 0166       | CONC, PAVMT                  | 1,000.00       |
| 3              | 0031       | BARN, MT AE                  | 1,000.00       |
| 4              | 0166       | CONC, PAVMT                  | 1,000.00       |
| 5              | 0070       | CARPORIT UF                  | 1,000.00       |

| L N | OB/XF CODE | DESCRIPTION | BLD CAP | L   | W  | UNITS    | UT | Adj R    | ADJ UNIT PRICE | ORIG COND | YEAR ON | YEAR ACTUAL | Q | % COND | OB/XF MKT VALUE | NOTES |
|-----|------------|-------------|---------|-----|----|----------|----|----------|----------------|-----------|---------|-------------|---|--------|-----------------|-------|
| 1   | 0166       | CONC, PAVMT | 0       | 100 | 0  | 2,255.00 | UT | 2.00     | 2.00           | 100       | 2016    | 2016        | 3 | 100    | 4,510           |       |
| 2   | 0166       | CONC, PAVMT | 0       | 100 | 12 | 1.00     | UT | 0.00     | 0.00           | 100       | 2019    | 2019        | 3 | 100    | 1,000           |       |
| 3   | 0031       | BARN, MT AE | 0       | 100 | 30 | 1.00     | UT | 0.00     | 0.00           | 100       | 2019    | 2019        | 3 | 100    | 7,500           |       |
| 4   | 0166       | CONC, PAVMT | 0       | 100 | 20 | 1.00     | UT | 0.00     | 0.00           | 100       | 2019    | 2019        | 3 | 100    | 1,000           |       |
| 5   | 0070       | CARPORIT UF | 0       | 100 | 0  | 1.00     | UT | 1,000.00 | 1,000.00       | 100       | 2024    | 2023        |   | 100    | 1,000           |       |

| BUILDING NOTES |  |
|----------------|--|
|                |  |

| BUILDING DIMENSIONS  |  |
|--|--|
| BAS= W32 S27 FGR= S27 E25 N21 W8 N6 W17\$ E17 S6 E8 S13 FOP= S8 E21 N8 W21\$ E36 N36 FSP= N10 W29 S10 E29\$ W29 N10\$. |  |

| LAND DESCRIPTION |          | TOTAL OB/XF |                      |     |     |          |       |       |             |           |     |          |        | 15,010  |            |                |            |                             |      |         |      |     |    |        |
|------------------|----------|-------------|----------------------|-----|-----|----------|-------|-------|-------------|-----------|-----|----------|--------|---------|------------|----------------|------------|-----------------------------|------|---------|------|-----|----|--------|
| L N              | USE CODE | CLS         | LAND USE DESCRIPTION | CAP | R D | LOC ZONE | FRONT | DEPTH | TOT LND UTS | UNIT TYPE | D T | DPH FACT | % COND | TOT ADJ | UNIT PRICE | ADJ UNIT PRICE | LAND VALUE | OTHER ADJUSTMENTS AND NOTES | YEAR | DENSITY | DECL | FRZ | YR | CONSRV |
| 1                | 0100     | C           | SFR                  | 100 |     | RSF-1    | 0.00  | 0.00  | 2.00        | LT        |     | 1.00     | 1.00   | 0.80    | 35,000.00  | 28,000.00      | 56,000     |                             |      |         |      |     |    |        |