

| BUILDING CHARACTERISTICS |                  | CONSTRUCTION   |      |
|--------------------------|------------------|----------------|------|
| ELEMENT                  | CD               |                |      |
| Exterior Wall            | 16               | WD FR STUC     | 70   |
| Exterior Wall            | 15               | CONC BLOCK     | 30   |
| Roof Structure           | 09               | RIDGE FRME     | 100  |
| Roof Cover               | 04               | BUILT-UP       | 100  |
| Interior Wall            | 05               | DRYWALL        | 100  |
| Interior Floor           | 15               | HARDTILE       | 100  |
| Ceiling                  | 01               | FIN.SUSPD      | 100  |
| Air Condition            | 06               | ENG CENTRL     | 100  |
| Heating Type             | 09               | ENG F AIR      | 100  |
| Fixtures                 |                  | 6              | 100  |
| Frame                    | 03               | MASONRY        | 100  |
| Story Height             |                  | 16             | 100  |
| RMS                      |                  | 3              | 100  |
| Stories                  | 1.               | 1.             | 100  |
| Units                    |                  | 0              | 100  |
| Condition Adj            | 04               | 04             | 100  |
| Quality                  | 05               | 05             |      |
| DOR CODE                 | 1126             | CONV STORE/GAS |      |
| MAP NUM                  |                  | MKT AREA       | 02   |
| NEIGHBORHOOD/LOC         | 10517.00         | 1.00/          |      |
| AREA TYPE                | TOTAL GROSS AREA | PCT OF BASE    | YEAR |
| BAS                      | 56               | 100            |      |
| BAS                      | 214              | 100            |      |
| BAS                      | 530              | 100            |      |
| BAS                      | 2,350            | 100            |      |
| CAN                      | 100              | 30             |      |
| CAN                      | 420              | 30             |      |
| CAN                      | 4,788            | 30             |      |
| TOTALS                   | 8,458            |                |      |

| MARKET ADJUSTMENTS                               |     |           |             |                |                |      |      |      |      |       |        |  |
|--|-----|-----------|-------------|----------------|----------------|------|------|------|------|-------|--------|--|
| TYPE   | MDL | EFF. AREA | TOT ADJ PTS | EFF. BASE RATE | REPL. COST NEW | AYB  | EYB  | ECON | FNCT | NORM  | % COND |  |
| 4300   | 04  | 4,742     | 123.5944    | 93.93          | 445,416        | 1995 | 1995 | 0    | 0    | 45.00 | 55.00  |  |
| 2 NBHD CONVE 0% - 0 Heated Area: 3150 HX Base Yr |     |           |             |                |                |      |      |      |      |       |        |  |

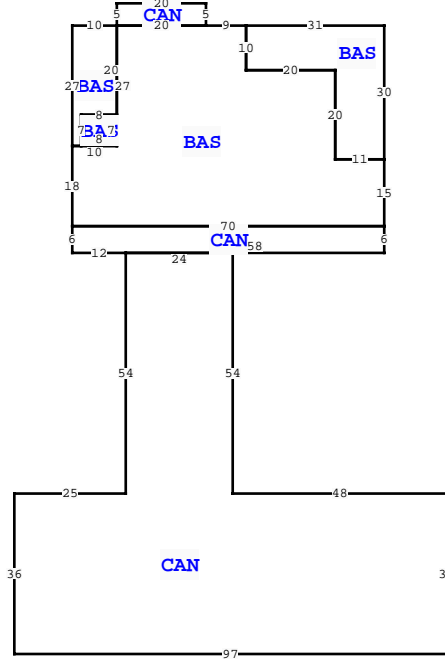

| COLUMBIA COUNTY PROPERTY  |             |           |             |
|---------------------------|-------------|-----------|-------------|
| VALUATION SUMMARY         |             |           | PAGE 1 of 1 |
| VALUATION BY              |             | STANDARD  |             |
| Tax Group: 3              |             | Tax Dist: |             |
| BUILDING MARKET VALUE     |             | 244,979   |             |
| TOTAL MARKET OB/XF VALUE  |             | 34,473    |             |
| TOTAL LAND VALUE - MARKET |             | 48,932    |             |
| TOTAL MARKET VALUE        |             | 328,384   |             |
| SOH/AGL Deduction         |             | 0         |             |
| ASSESSED VALUE            |             | 328,384   |             |
| TOTAL EXEMPTION VALUE     |             | 0         |             |
| BASE TAXABLE VALUE        |             | 328,384   |             |
| TOTAL JUST VALUE          |             | 328,384   |             |
| NCON VALUE                |             | 0         |             |
| INCOME VALUE              |             |           |             |
| PREVIOUS YEAR MKT VALUE   |             | 330,019   |             |
| XFOB:2:1: STAR MH         |             |           |             |
| PERMIT NUM                | DESCRIPTION | AMT       | ISSUED      |
| 000052128                 | Generator   | 8,634     | 01/22/2025  |
| 9561                      | COMMERCIAL  | 575       | 04/03/1995  |

| SALES DATA                     |           |           |       |       |        |            |
|--------------------------------|-----------|-----------|-------|-------|--------|------------|
| OFF RECORD Number              | DATE      | TYPE INST | Q / U | V / I | RSN CD | SALE PRICE |
| 1293/2074                      | 4/28/2015 | WD        | U     | I     | 43     | 19,812,600 |
| GRANTOR: STAFFORD L SCAFF JR   |           |           |       |       |        |            |
| GRANTEE: SOUTHWEST GEORGIA O   |           |           |       |       |        |            |
| 0795/0392                      | 8/24/1994 | WD        | U     | V     | 08     | 5,000      |
| GRANTOR: JOSEPH L & LULA F NET |           |           |       |       |        |            |
| GRANTEE: LESTER & ANNE SCAFF   |           |           |       |       |        |            |

| EXTRA FEATURES |            |             |         |   |    |       |           |       |                |           |         |             |       |        |                 |         |  |  |
|----------------|------------|-------------|---------|---|----|-------|-----------|-------|----------------|-----------|---------|-------------|-------|--------|-----------------|---------|--|--|
| L N            | OB/XF CODE | DESCRIPTION | BLD CAP | L | W  | UNITS | UT        | Adj R | ADJ UNIT PRICE | ORIG COND | YEAR ON | YEAR ACTUAL | Q     | % COND | OB/XF MKT VALUE | NOTES   |  |  |
| 1              | 0164       | CONC BIN    | 0       | 0 | 12 | 8     | 96.00     | UT    | 12.00          | 100       | 2008    | 2008        | 3     | 100    | 1,152           |         |  |  |
| 2              | 0260       | PAVEMENT-A  | 0       | 0 | 0  | 0     | 1.00      | UT    | 0.00           | 100       | 0       | 0           | 3     | 100    | 1,000           |         |  |  |
| 3              | 0166       | CONC, PAVMT | 0       | 0 | 0  | 0     | 5,563.00  | UT    | 1.50           | 100       | 1995    | 1995        | 3     | 100    | 8,345           |         |  |  |
| 4              | 0260       | PAVEMENT-A  | 0       | 0 | 0  | 0     | 20,307.00 | UT    | 0.90           | 100       | 1995    | 1995        | 3     | 100    | 18,276          |         |  |  |
| 5              | 0104       | GENERATOR   | 0       | 0 | 0  | 0     | 1.00      | UT    | 6,000.00       | 100       | 2026    | 2025        |       | 95     | 5,700           |         |  |  |
| TOTALS         |            |             |         |   |    |       |           |       |                |           |         |             | 8,458 |        | 4,742           | 244,979 |  |  |

| LAND DESCRIPTION |          |     |                      |     |     |          |       |       |             |           |     |          | TOTAL OB/XF |         |            |                |            |                             |      |         |      |     |    |        |  |
|------------------|----------|-----|----------------------|-----|-----|----------|-------|-------|-------------|-----------|-----|----------|-------------|---------|------------|----------------|------------|-----------------------------|------|---------|------|-----|----|--------|--|
| L N              | USE CODE | CLS | LAND USE DESCRIPTION | CAP | R D | LOC ZONE | FRONT | DEPTH | TOT LND UTS | UNIT TYPE | D T | DPH FACT | % COND      | TOT ADJ | UNIT PRICE | ADJ UNIT PRICE | LAND VALUE | OTHER ADJUSTMENTS AND NOTES | YEAR | DENSITY | DECL | FRZ | YR | CONSRV |  |
| 1                | 1100     | C   | STORE 1FLR           | 0   |     | A-1      | 0.00  | 0.00  | 1.15        | AC        |     | 1.00     | 1.00        | 1.15    | 37,000.00  | 42,550.00      | 48,932     |                             |      |         |      |     |    |        |  |