

| BUILDING CHARACTERISTICS |                  | CONSTRUCTION |      |
|--------------------------|------------------|--------------|------|
| ELEMENT                  | CD               |              |      |
| Exterior Wall            | 32               | HARDIE BRD   | 100  |
| Roof Structur            | 08               | IRREGULAR    | 100  |
| Roof Cover               | 03               | COMP SHNGL   | 100  |
| Interior Wall            | 05               | DRYWALL      | 100  |
| Interior Floo            | 14               | CARPET       | 90   |
| Interior Floo            | 15               | HARDTILE     | 10   |
| Air Condition            | 03               | CENTRAL      | 100  |
| Heating Type             | 04               | AIR DUCTED   | 100  |
| Bedrooms                 |                  | 3            | 100  |
| Bathrooms                |                  | 2            | 100  |
| Frame                    |                  | N/A          | 100  |
| Stories                  | 1.               | 1.           | 100  |
| Architectual             | 05               | CONV         | 100  |
| Units                    |                  | 0            | 100  |
| Condition Adj            | 03               | 03           | 100  |
| Kitchen Adjus            | 01               | 01           | 100  |
| Quality                  | 07               | 07           |      |
| DOR CODE                 | 5000 IMPROVED AG |              |      |
| MAP NUM                  |                  | MKT AREA     | 02   |
| NEIGHBORHOOD/LOC         | 9517.00 1.00/    |              |      |
| AREA TYPE                | TOTAL GROSS AREA | PCT OF BASE  | YEAR |
| BAS                      | 3,125            | 100          |      |
| FOP                      | 178              | 30           |      |
| FOP                      | 288              | 30           |      |
| UDU                      | 1,024            | 55           |      |
| UOP                      | 255              | 20           |      |
| UOP                      | 484              | 20           |      |
| TOTALS                   | 5,354            |              |      |

| MARKET ADJUSTMENTS |            |           |             |                |                |                 |     |      |      |      |        |
|--------------------|------------|-----------|-------------|----------------|----------------|-----------------|-----|------|------|------|--------|
| TYPE               | MDL        | EFF. AREA | TOT ADJ PTS | EFF. BASE RATE | REPL. COST NEW | AYB             | EYB | ECON | FNCT | NORM | % COND |
| 1                  | SINGLE FAM | 100%      | - 2002      |                |                |                 |     |      |      |      |        |
| Heated Area: 3125  |            |           |             |                |                | HX Base Yr 2002 |     |      |      |      |        |

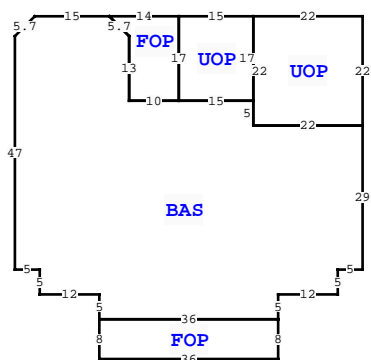
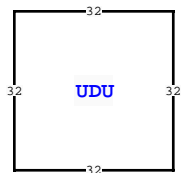

| COLUMBIA COUNTY PROPERTY  |           | PAGE 1 of 1 | 3        |
|---------------------------|-----------|-------------|----------|
| VALUATION SUMMARY         |           |             |          |
| VALUATION BY              |           |             | STANDARD |
| Tax Group: 3              | Tax Dist: |             |          |
| BUILDING MARKET VALUE     |           |             | 393,153  |
| TOTAL MARKET OB/XF VALUE  |           |             | 6,500    |
| TOTAL LAND VALUE - MARKET |           |             | 65,800   |
| TOTAL MARKET VALUE        |           |             | 413,159  |
| SOH/AGL Deduction         |           |             | 138,418  |
| ASSESSED VALUE            |           |             | 274,741  |
| TOTAL EXEMPTION VALUE     | HX HB     | 51,411      |          |
| BASE TAXABLE VALUE        |           |             | 223,330  |
| TOTAL JUST VALUE          |           |             | 465,453  |
| NCON VALUE                |           |             | 0        |
| INCOME VALUE              |           |             |          |
| PREVIOUS YEAR MKT VALUE   |           |             | 468,626  |

| PERMIT NUM | DESCRIPTION | AMT | ISSUED     |
|------------|-------------|-----|------------|
| 18156      | SFR         | 329 | 04/12/2001 |

| SALES DATA        |           |           |       |       |        |            |
|-------------------|-----------|-----------|-------|-------|--------|------------|
| OFF RECORD Number | DATE      | TYPE INST | Q / U | V / I | RSN CD | SALE PRICE |
| 0924/0580         | 4/10/2001 | WD Q      | Q     | V     | 01     | 100        |

GRANTOR: SHEROD S & MARCEL KEE  
 GRANTEE: RICHARD & MARY V MU

| EXTRA FEATURES |            |             |         |     |   |       |    |       |                |           |         |             |      |        |                 |       |  |
|----------------|------------|-------------|---------|-----|---|-------|----|-------|----------------|-----------|---------|-------------|------|--------|-----------------|-------|--|
| L N            | OB/XF CODE | DESCRIPTION | BLD CAP | L   | W | UNITS | UT | Adj R | ADJ UNIT PRICE | ORIG COND | YEAR ON | YEAR ACTUAL | Q    | % COND | OB/XF MKT VALUE | NOTES |  |
| 1              | 0190       | FPLC PF     | 0       | 100 | 0 | 0     |    | 1.00  | UT 1,200.00    | 1,200.00  | 100     | 2001        | 2001 | 3      | 100             | 1,200 |  |
| 2              | 0166       | CONC, PAVMT | 0       | 100 | 0 | 0     |    | 1.00  | UT 0.00        | 0.00      | 100     | 2012        | 2012 | 3      | 100             | 300   |  |
| 3              | 0260       | PAVEMENT-A  | 0       | 100 | 0 | 0     |    | 1.00  | UT 0.00        | 0.00      | 100     | 2012        | 2012 | 3      | 100             | 5,000 |  |

| BUILDING NOTES |  |  |  |
|----------------|--|--|--|
|                |  |  |  |

**BUILDING DIMENSIONS**  
 BAS= W15 L4 D4 S47 E5 S5 E12 S5 FOP= S8 E36 N8 W36\$ E36 N5  
 E12 N5 E5 N29 UOP= N22 W22 S22 E22\$ W22 N5 UOP= N17 W15 S17  
 E15\$ W15 FOP= N17 W14 D4 R4 S13 E10\$ W10 N13 L4 U4 \$ PTR=  
 N30 UDU= N32 W32 S32 E32\$ S30\$.

| LAND DESCRIPTION |          |     |                      |     |     |          |       |       |             |           |     | TOTAL OB/XF |        |         |            |                |            |                             |      |         |      |     |    |        |
|------------------|----------|-----|----------------------|-----|-----|----------|-------|-------|-------------|-----------|-----|-------------|--------|---------|------------|----------------|------------|-----------------------------|------|---------|------|-----|----|--------|
| L N              | USE CODE | CLS | LAND USE DESCRIPTION | CAP | R D | LOC ZONE | FRONT | DEPTH | TOT LND UTS | UNIT TYPE | D T | DPH FACT    | % COND | TOT ADJ | UNIT PRICE | ADJ UNIT PRICE | LAND VALUE | OTHER ADJUSTMENTS AND NOTES | YEAR | DENSITY | DECL | FRZ | YR | CONSRV |
| 1                | 0100     | C   | SFR                  | 100 |     | A-1      | 0.00  | 0.00  | 1.00        | AC        |     | 1.00        | 1.00   | 1.00    | 12,000.00  | 12,000.00      | 12,000     |                             |      |         |      |     |    |        |
| 2                | 6200     | A   | PASTURE 3            | 0   |     | A-1      | 0.00  | 0.00  | 5.38        | AC        |     | 1.00        | 1.00   | 1.00    | 280.00     | 280.00         | 1,506      |                             |      |         |      |     |    |        |
| 3                | 9910     | M   | MKT. VAL. AG         | 0   |     | A-1      | 0.00  | 0.00  | 5.38        | AC        |     | 1.00        | 1.00   | 1.00    | 10,000.00  | 10,000.00      | 53,800     |                             |      |         |      |     |    |        |