

N1/4 OF THE FOLLOWING PARCEL: NE  
EX 5 AC IN SE COR & EX 6.60 AC O  
SIDE & EX 2.28 AC DESC ORB 1428-

ZIEGLER VICTORIA/ZIEGLER MICHAEL  
151 SW BARWICK TERRACE  
LAKE CITY, FL 32024

2026

08-4S-16-02817-004



| BUILDING CHARACTERISTICS |                  | CONSTRUCTION |      |
|--------------------------|------------------|--------------|------|
| ELEMENT                  | CD               |              |      |
| Exterior Wall            | 31               | VINYL SID    | 100  |
| Roof Structur            | 03               | GABLE/HIP    | 100  |
| Roof Cover               | 12               | MODULAR MT   | 100  |
| Interior Wall            | 05               | DRYWALL      | 100  |
| Interior Floor           | 14               | CARPET       | 90   |
| Interior Floor           | 08               | SHT VINYL    | 10   |
| Air Condition            | 03               | CENTRAL      | 100  |
| Heating Type             | 04               | AIR DUCTED   | 100  |
| Bedrooms                 |                  | 3            | 100  |
| Bathrooms                |                  | 2            | 100  |
| Stories                  | 1.               | 1.           | 100  |
| Architactual             | 01               | CONV         | 100  |
| Units                    |                  | 0            | 100  |
| Condition Adj            | 03               | 03           | 100  |
| Kitchen Adjus            | 01               | 01           | 100  |
| Quality                  | 05               | 05           |      |
| DOR CODE                 | 0200 MOBILE HOME |              |      |
| MAP NUM                  |                  | MKT AREA     | 01   |
| NEIGHBORHOOD/LOC         | 8416.00 1.00/    |              |      |
| AREA TYPE                | TOTAL GROSS AREA | PCT OF BASE  | YEAR |
| BAS                      | 1,890            | 100          |      |
| UOP                      | 120              | 25           |      |
| UOP                      | 120              | 25           |      |
| TOTALS                   | 2,130            |              |      |

| MARKET ADJUSTMENTS                               |     |           |             |                |                |      |      |      |      |       |        |  |
|--|-----|-----------|-------------|----------------|----------------|------|------|------|------|-------|--------|--|
| TYPE   | MDL | EFF. AREA | TOT ADJ PTS | EFF. BASE RATE | REPL. COST NEW | AYB  | EYB  | ECON | FNCT | NORM  | % COND |  |
| 0201   | 02  | 1,950     | 115.9000    | 108.95         | 212,452        | 1994 | 1994 | 0    | 0    | 45.00 | 55.00  |  |
| 1 MANUF 1 0% - 2022 Heated Area: 1890 HX Base Yr |     |           |             |                |                |      |      |      |      |       |        |  |

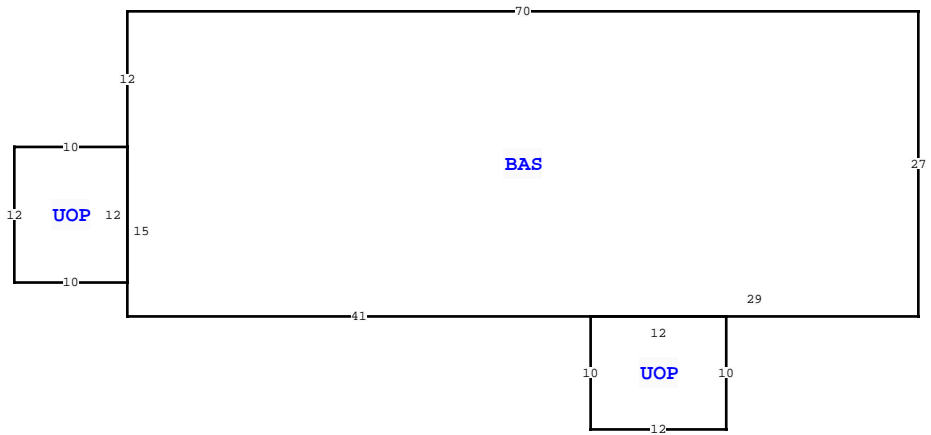

| COLUMBIA COUNTY PROPERTY                          |             |     |             |
|---|-------------|-----|-------------|
| VALUATION SUMMARY                                 |             |     | PAGE 1 of 1 |
| VALUATION BY                                      |             |     | STANDARD    |
| Tax Group: 3                                      | Tax Dist:   |     |             |
| BUILDING MARKET VALUE                             |             |     | 116,849     |
| TOTAL MARKET OB/XF VALUE                          |             |     | 17,464      |
| TOTAL LAND VALUE - MARKET                         |             |     | 47,850      |
| TOTAL MARKET VALUE                                |             |     | 182,163     |
| SOH/AGL Deduction                                 |             |     | 10,128      |
| ASSESSED VALUE                                    |             |     | 172,035     |
| TOTAL EXEMPTION VALUE                             |             |     | 0           |
| BASE TAXABLE VALUE                                |             |     | 172,035     |
| TOTAL JUST VALUE                                  |             |     | 182,163     |
| NCON VALUE  |             |     | 0           |
| INCOME VALUE                                      |             |     | 0           |
| PREVIOUS YEAR MKT VALUE                           |             |     | 173,463     |
| SALE:4:1: 7.10 AC ESTATE DEED OF PARTITION        |             |     |             |
| SALE:3:1: IN LIEU OF FORECLOSURE - GUARDIANS DEED |             |     |             |
| SALE:2:1: INCLUDED 02817-003                      |             |     |             |
| XFOB:1:1: 1994 FLEETWOOD/OAK KNOLL MH             |             |     |             |
| PERMIT NUM  | DESCRIPTION | AMT | ISSUED      |
|   |             |     |             |

| SALES DATA                     |           |           |     |     |        |            |
|--------------------------------|-----------|-----------|-----|-----|--------|------------|
| OFF RECORD Number              | DATE      | TYPE INST | Q U | V I | RSN CD | SALE PRICE |
| 1428/708                       | 1/14/2021 | WD        | U   | I   | 11     | 100        |
| GRANTOR: WICKLINE ELIZABETH AS |           |           |     |     |        |            |
| GRANTEE: ZIEGLER VICTORIA      |           |           |     |     |        |            |
| 1312/2515                      | 4/08/2016 | PB        | U   | I   | 18     | 100        |
| GRANTOR: CLERK OF COURT (RONAL |           |           |     |     |        |            |
| GRANTEE: ELIZABETH A WICKLIN   |           |           |     |     |        |            |

| EXTRA FEATURES |            |             |     |     |    |    |        |    |          |                |           |         |
|----------------|------------|-------------|-----|-----|----|----|--------|----|----------|----------------|-----------|---------|
| L N            | OB/XF CODE | DESCRIPTION | BLD | CAP | L  | W  | UNITS  | UT | Adj R    | ADJ UNIT PRICE | ORIG COND | YEAR ON |
| 1              | 0190       | FPLC PF     | 0   | 0   | 0  | 0  | 1.00   | UT | 1,200.00 | 1,200.00       | 100       | 1993    |
| 2              | 0294       | SHED WOOD/  | 0   | 0   | 8  | 8  | 64.00  | UT | 7.50     | 7.50           | 100       | 1993    |
| 3              | 9945       | Well/Sept   | 0   | 0   | 0  | 0  | 1.00   | UT | 7,000.00 | 7,000.00       | 100       |         |
| 4              | 0294       | SHED WOOD/  | 0   | 0   | 8  | 12 | 96.00  | UT | 7.50     | 7.50           | 100       | 1993    |
| 5              | 0190       | FPLC PF     | 0   | 0   | 0  | 0  | 1.00   | UT | 1,200.00 | 1,200.00       | 100       | 2006    |
| 6              | 0030       | BARN, MT    | 0   | 0   | 24 | 25 | 624.00 | UT | 11.00    | 11.00          | 100       | 2019    |

| TOTAL OB/XF |  |           |            |  |  |  |  |  |  |  |  |  |
|-------------|--|-----------|------------|--|--|--|--|--|--|--|--|--|
| 17,464      |  |           |            |  |  |  |  |  |  |  |  |  |
| BLD DATE    |  | LGL DATE  |            |  |  |  |  |  |  |  |  |  |
| XF DATE     |  | LAND DATE | 04/22/2026 |  |  |  |  |  |  |  |  |  |
| INC DATE    |  | AG DATE   |            |  |  |  |  |  |  |  |  |  |

| BUILDING NOTES   |  |  |  |  |  |  |  |  |  |  |  |  |
|--|--|--|--|--|--|--|--|--|--|--|--|--|
| BAS= W70 S12 UOP= W10 S12 E10 N12\$ S15 E41 UOP= S10 E12N10 W12\$ E29 N27\$. |  |  |  |  |  |  |  |  |  |  |  |  |

| LAND DESCRIPTION |          |     |                      |     |     |          |       |       |             |           |     |          |
|------------------|----------|-----|----------------------|-----|-----|----------|-------|-------|-------------|-----------|-----|----------|
| L N              | USE CODE | CLS | LAND USE DESCRIPTION | CAP | R D | LOC ZONE | FRONT | DEPTH | TOT LND UTS | UNIT TYPE | D T | DPH FACT |
| 1                | 0102     | C   | SFR/MH               | 0   |     | A-1      | 0.00  | 0.00  | 4.35        | AC        |     | 1.00     |

| TOT ADJ | UNIT PRICE | ADJ UNIT PRICE | LAND VALUE | OTHER ADJUSTMENTS AND NOTES | YEAR | DENSITY | DECL | FRZ | YR | CONSRV |
|---------|------------|----------------|------------|-----------------------------|------|---------|------|-----|----|--------|
| 1.00    | 11,000.00  | 11,000.00      | 47,850     |                             |      |         |      |     |    |        |

| BUILDING DIMENSIONS  |  |  |  |  |  |  |  |  |  |  |  |  |
|--|--|--|--|--|--|--|--|--|--|--|--|--|
| BAS= W70 S12 UOP= W10 S12 E10 N12\$ S15 E41 UOP= S10 E12N10 W12\$ E29 N27\$. |  |  |  |  |  |  |  |  |  |  |  |  |