

COMM SE COR OF NE1/4 OF SE1/4, R
FOR POB, RUN W 86.8 FT TO E R/W
ALONG R/W 130.6 FT, E 126.2 FT,

BEECROFT JOHN P
320 EMERALD DR
BRICK TOWNSHIP, NJ 08723

2026

07-4S-17-08149-000
VALUATION SUMMARY PAGE 1 of 1

| ELEMENT | | CD | CONSTRUCTION | | |
|------------------|------------------|---------------|--------------|--------------|----------------------|
| Exterior Wall | 31 | VINYL | SID | 60 | |
| Exterior Wall | 19 | COMMON | BRK | 40 | |
| Roof Structure | 03 | GABLE/HIP | 100 | | |
| Roof Cover | 12 | MODULAR | MT | 100 | |
| Interior Wall | 05 | DRYWALL | 100 | | |
| Interior Floor | 01 | NONE | 70 | | |
| Interior Floor | 15 | HARDTILE | 30 | | |
| Air Condition | 02 | WINDOW | 100 | | |
| Heating Type | 04 | AIR DUCTED | 100 | | |
| Bedrooms | | 2 | 100 | | |
| Bathrooms | | 2 | 100 | | |
| Frame | 01 | NONE | 100 | | |
| Stories | 1. | 1. | 100 | | |
| Architectual | 05 | CONV | 100 | | |
| Units | | 0 | 100 | | |
| Condition Adj | 01 | 01 | 100 | | |
| Kitchen Adjus | 01 | 01 | 100 | | |
| Quality | 02 | 02 | | | |
| DOR CODE | 0100 | SINGLE FAMILY | | | |
| MAP NUM | | MKT AREA | 06 | | |
| NEIGHBORHOOD/LOC | 7417.00 | 1.00/ | | | |
| AREA TYPE | TOTAL GROSS AREA | PCT OF BASE | YEAR | TOT ADJ AREA | SUBAREA MARKET VALUE |
| BAS | 1,822 | 100 | | 1,822 | 51,949 |
| FOP | 85 | 30 | | 26 | 741 |
| FSP | 322 | 40 | | 129 | 3,678 |
| FST | 176 | 55 | | 97 | 2,766 |
| TOTALS | 2,405 | | | 2,074 | 59,134 |

| MARKET ADJUSTMENTS | | | | | | | | | | | | |
|---|-----|-----------|-------------|----------------|----------------|------|------|------|------|----|-------|--------|
| TYPE | MDL | EFF. AREA | TOT ADJ PTS | EFF. BASE RATE | REPL. COST NEW | AYB | EYB | ECON | FNCT | AP | NORM | % COND |
| 0100 | 01 | 2,074 | 68.8010 | 77.06 | 159,822 | 1964 | 1964 | 18 | 0 | 10 | 35.00 | 37.00 |
| 1 SINGLE FAM 0% - 2024 Heated Area: 1822 HX Base Yr | | | | | | | | | | | | |

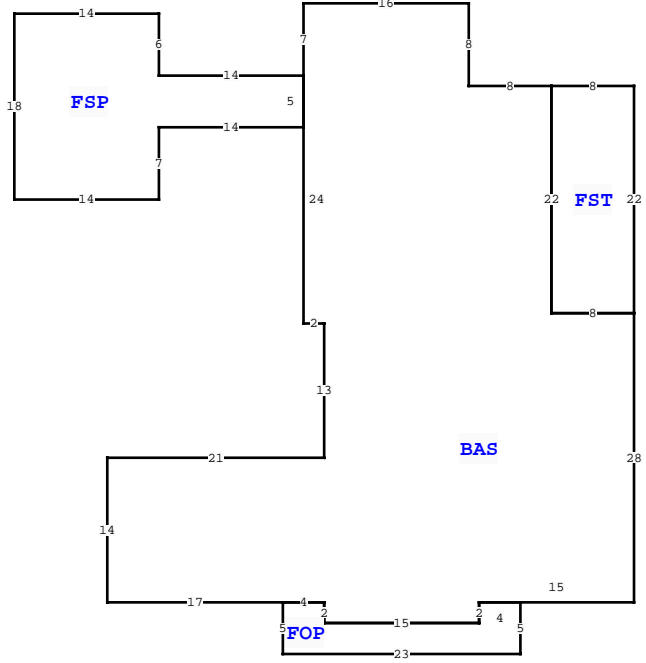

| COLUMBIA COUNTY PROPERTY | | PAGE 1 of 1 | 2 |
|---------------------------|-----------|-------------|---|
| VALUATION BY | | STANDARD | |
| Tax Group: 2 | Tax Dist: | | |
| BUILDING MARKET VALUE | 59,134 | | |
| TOTAL MARKET OB/XF VALUE | 1,450 | | |
| TOTAL LAND VALUE - MARKET | 27,812 | | |
| TOTAL MARKET VALUE | 88,396 | | |
| SOH/AGL Deduction | 0 | | |
| ASSESSED VALUE | 88,396 | | |
| TOTAL EXEMPTION VALUE | 0 | | |
| BASE TAXABLE VALUE | 88,396 | | |
| TOTAL JUST VALUE | 88,396 | | |
| NCON VALUE | 0 | | |
| INCOME VALUE | 0 | | |
| PREVIOUS YEAR MKT VALUE | 85,306 | | |

| PERMIT NUM | DESCRIPTION | AMT | ISSUED |
|------------|-------------------|-----|------------|
| 000049318 | Electrical Servic | 0 | 02/29/2024 |

| SALES DATA | | | | | | |
|--------------------------------|------------|-----------|-------|-------|--------|------------|
| OFF RECORD Number | DATE | TYPE INST | Q / U | V / I | RSN CD | SALE PRICE |
| 1503/2404 | 12/01/2023 | WD | Q | I | 01 | 100,000 |
| GRANTOR: BAKERS ELECTRONICS AN | | | | | | |
| GRANTEE: BEECROFT JOHN P | | | | | | |
| 1175/0178 | 6/12/2009 | WD | U | I | 37 | 150,000 |
| GRANTOR: LYNNE E TAPPEN | | | | | | |
| GRANTEE: BAKERS ELECTRONICS | | | | | | |

| EXTRA FEATURES | | | | | | | | | | | | | | | | | |
|----------------|------------|-------------|-----|-----|----|----|-------|----|-------|----------------|-----------|---------|-------------|---|--------|-----------------|-------|
| L N | OB/XF CODE | DESCRIPTION | BLD | CAP | L | W | UNITS | UT | Adj R | ADJ UNIT PRICE | ORIG COND | YEAR ON | YEAR ACTUAL | Q | % COND | OB/XF MKT VALUE | NOTES |
| 1 | 0294 | SHED WOOD/ | 0 | 0 | 0 | 0 | 1.00 | UT | 0.00 | 0.00 | 100 | 0 | 0 | 3 | 100 | 300 | |
| 2 | 0294 | SHED WOOD/ | 0 | 0 | 10 | 20 | 1.00 | UT | 0.00 | 0.00 | 100 | 0 | 0 | 3 | 100 | 450 | |
| 3 | 0120 | CLFENCE 4 | 0 | 0 | 0 | 0 | 1.00 | UT | 0.00 | 0.00 | 100 | 2012 | 2012 | 3 | 100 | 100 | |
| 4 | 0166 | CONC, PAVMT | 0 | 0 | 0 | 0 | 1.00 | UT | 0.00 | 0.00 | 100 | 2012 | 2012 | 3 | 100 | 200 | |
| 5 | 0060 | CARPOT F | 0 | 0 | 0 | 0 | 1.00 | UT | 0.00 | 0.00 | 100 | 2012 | 2012 | 3 | 100 | 400 | |
| TOTALS | | | | | | | | | | | | | 1,450 | | | | |

| LAND DESCRIPTION | | | | | | | | | | | | | TOTAL OB/XF | | | | | | | | | | | |
|------------------|----------|-----|----------------------|-----|-----|----------|-------|-------|-------------|-----------|-----|----------|-------------|---------|------------|----------------|------------|-----------------------------|------|---------|------|-----|----|--------|
| L N | USE CODE | CLS | LAND USE DESCRIPTION | CAP | R D | LOC ZONE | FRONT | DEPTH | TOT LND UTS | UNIT TYPE | D T | DPH FACT | % COND | TOT ADJ | UNIT PRICE | ADJ UNIT PRICE | LAND VALUE | OTHER ADJUSTMENTS AND NOTES | YEAR | DENSITY | DECL | FRZ | YR | CONSRV |
| 1 | 0100 | C | SFR | 0 | | CI | 0.00 | 0.00 | 16,481.00 | SF | | 1.00 | 1.00 | 0.75 | 2.25 | 1.69 | 27,812 | | | | | | | |