

BUILDING CHARACTERISTICS		CONSTRUCTION			
ELEMENT	CD				
Exterior Wall	19	COMMON BRK	70		
Exterior Wall	08	WD OR PLY	30		
Roof Structure	03	GABLE/HIP	100		
Roof Cover	03	COMP SHNGL	100		
Interior Wall	04	PLYWOOD	100		
Interior Floor	14	CARPET	90		
Interior Floor	06	VINYL ASB	10		
Air Condition	03	CENTRAL	100		
Heating Type	04	AIR DUCTED	100		
Bedrooms		3	100		
Bathrooms		2	100		
Frame	01	NONE	100		
Stories	1.	1.	100		
Architectual	05	CONV	100		
Units		0	100		
Condition Adj	03	03	100		
Kitchen Adjus	01	01	100		
Quality	05	05			
DOR CODE	0102	SFRES/MOBILE HOME			
MAP NUM		MKT AREA	01		
NEIGHBORHOOD/LOC	6517.00	1.00/			
AREA TYPE	TOTAL GROSS AREA	PCT OF BASE	YEAR	TOT ADJ AREA	SUBAREA MARKET VALUE
BAS	1,418	100		1,418	114,051
FEP	140	80		112	9,008
FOP	64	30		19	1,528
FOP	72	30		22	1,769
FOP	224	30		67	5,389
UST	244	45		110	8,847
TOTALS	2,162			1,748	140,594

MARKET ADJUSTMENTS											
TYPE	MDL	EFF. AREA	TOT ADJ PTS	EFF. BASE RATE	REPL. COST NEW	AYB	EYB	ECON	FNCT	NORM	% COND
0100	01	1,748	110.4840	123.74	216,298	1974	1974	0	0	35.00	65.00
1 SINGLE FAM			100% - 0	Heated Area: 1418		HX Base Yr					

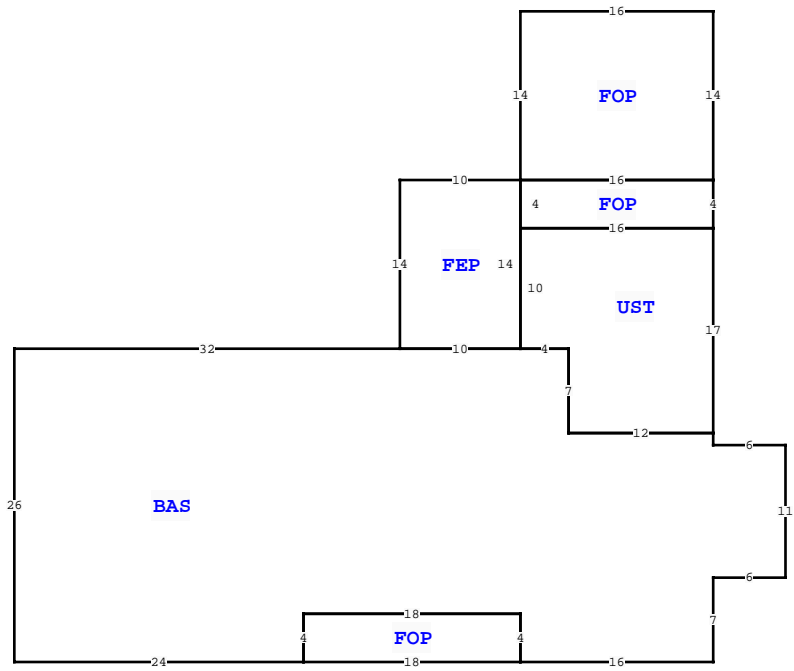

COLUMBIA COUNTY PROPERTY			PAGE 1 of 1	3
VALUATION SUMMARY				
VALUATION BY	STANDARD			
Tax Group: 3	Tax Dist:			
BUILDING MARKET VALUE	140,594			
TOTAL MARKET OB/XF VALUE	4,110			
TOTAL LAND VALUE - MARKET	60,000			
TOTAL MARKET VALUE	204,704			
SOH/AGL Deduction	113,660			
ASSESSED VALUE	93,044			
TOTAL EXEMPTION VALUE	56,411		HX HB VX	
BASE TAXABLE VALUE	36,633			
TOTAL JUST VALUE	204,704			
NCON VALUE	0			
INCOME VALUE				
PREVIOUS YEAR MKT VALUE	199,704			

PERMIT NUM	DESCRIPTION	AMT	ISSUED
000052888	Roof Replacement	12,645	04/15/2025
24956	M H	293	09/07/2006
11826	M H	125	11/04/1996
8742	M H	125	08/18/1994

SALES DATA						
OFF RECORD Number	DATE	TYPE INST	Q U	V I	RSN CD	SALE PRICE

BLD DATE		LGL DATE	
XF DATE	INC DATE	LAND DATE	AG DATE
		04/22/2026	MLU

BUILDING NOTES	
BAS= W32 S26 E24 FOP= E18 N4 W18 S4\$ N4 E18 S4 E16 N7 E6N11 W6 N1 UST= N17 FOP= N4 FOP= N14 W16 S14 E16\$ W16 S4 E16\$ W16 S10 E4 S7 E12\$W12 N7 W4 FEP= N14 W10 S14 E10\$ W10\$.	

EXTRA FEATURES																
L N	OB/XF CODE	DESCRIPTION	BLD CAP	L	W	UNITS	UT	Adj R	ADJ UNIT PRICE	ORIG COND	YEAR ON	YEAR ACTUAL	Q	% COND	OB/XF MKT VALUE	NOTES
1	0166	CONC,PAVMT	0	100	0	0	0	0	0.00	100	0	0	3	100	110	
2	0296	SHED METAL	0	100	0	0	0	0	0.00	100	0	0	3	100	200	
3	9947	Septic	0	100	0	0	0	3,000.00	3,000.00	100			3	100	3,000	
4	0296	SHED METAL	0	100	0	0	0	0.00	0.00	100	0	0	3	100	800	

LAND DESCRIPTION												TOTAL OB/XF												
L N	USE CODE	CLS	LAND USE DESCRIPTION	CAP	R D	LOC ZONE	FRONT	DEPTH	TOT LND UTS	UNIT TYPE	D T	DPTH FACT	% COND	TOT ADJ	UNIT PRICE	ADJ UNIT PRICE	LAND VALUE	OTHER ADJUSTMENTS AND NOTES	YEAR	DENSITY	DECL	FRZ	YR	CONSRV
1	0100	C	SFR	100		A-1	0.00	0.00	5.00	AC		1.00	1.00	1.00	12,000.00	12,000.00	60,000							