

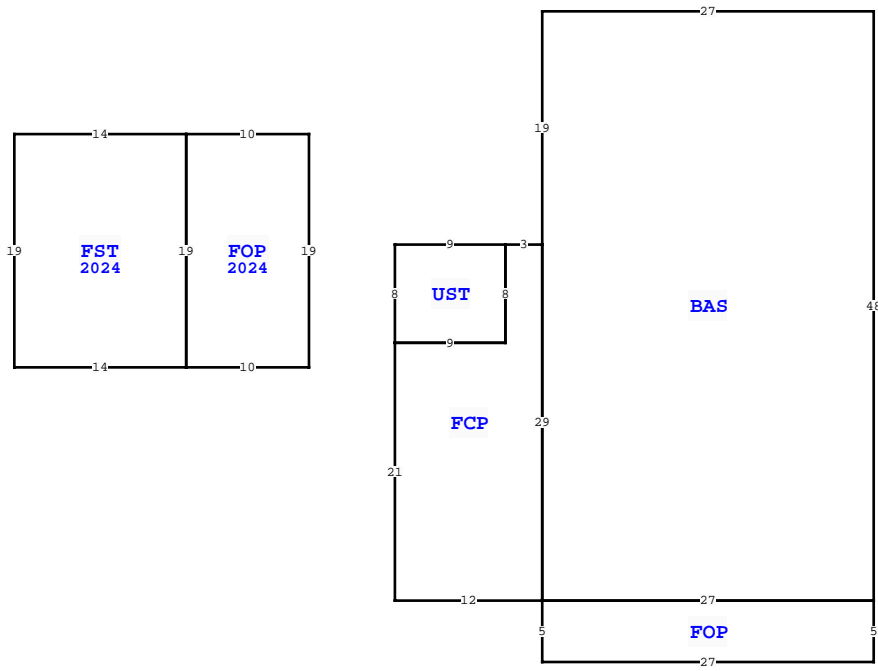

ELEMENT		CD	CONSTRUCTION
Exterior Wall	19	COMMON BRK	100
Roof Structur	03	GABLE/HIP	100
Roof Cover	03	COMP SHNGL	100
Interior Wall	05	DRYWALL	100
Interior Floo	14	CARPET	70
Interior Floo	06	VINYL ASB	30
Air Condition	03	CENTRAL	100
Heating Type	04	AIR DUCTED	100
Bedrooms		3	100
Bathrooms		1.5	100
Frame	01	NONE	100
Stories	1.	1.	100
Architectual	05	CONV	100
Units		0	100
Condition Adj	02	02	100
Kitchen Adjus	01	01	100
Quality	03	03	
DOR CODE	0101	SFRES/SFRES	
MAP NUM		MKT AREA	01
NEIGHBORHOOD/LOC	1516.00	1.00/	
AREA TYPE	TOTAL GROSS AREA	PCT OF BASE	YEAR
BAS	1,296	100	
FCP	276	25	
FOP	135	30	
FOP	190	30	2024
FST	266	55	2024
UST	72	45	
TOTALS	2,235		

MARKET ADJUSTMENTS											
TYPE	MDL	EFF. AREA	TOT ADJ PTS	EFF. BASE RATE	REPL. COST NEW	AYB	EYB	ECON	FNCT	NORM	% COND
0100	01	1,640	91.8176	102.84	168,658	1969	1969	10	0	35.00	55.00
1 SINGLE FAM 0% - 2024 Heated Area: 1296 HX Base Yr											



COLUMBIA COUNTY PROPERTY		PAGE 1 of 9	3
VALUATION BY		STANDARD	
Tax Group: 3		Tax Dist:	
BUILDING MARKET VALUE		808,597	
TOTAL MARKET OB/XF VALUE		64,153	
TOTAL LAND VALUE - MARKET		141,400	
TOTAL MARKET VALUE		1,014,150	
SOH/AGL Deduction		0	
ASSESSED VALUE		1,014,150	
TOTAL EXEMPTION VALUE		0	
BASE TAXABLE VALUE		1,014,150	
TOTAL JUST VALUE		1,014,150	
NCON VALUE		0	
INCOME VALUE		0	
PREVIOUS YEAR MKT VALUE		1,026,696	

PERMIT NUM	DESCRIPTION	AMT	ISSUED
000054976	Electrical Servic		02/09/2026
26798	MAINT/ALTR	35	02/26/2008

SALES DATA						
OFF RECORD Number	DATE	TYPE INST	Q / U	V / I	RSN CD	SALE PRICE
1505/1223	12/15/2023	WD	Q	I	05	2,400,000
GRANTOR: DIAZ RANCH LLC						
GRANTEE: MONTENEGRO RANCH LL						
1231/1356	1/11/2012	WD	U	I	17	200,000
GRANTOR: MOUNTAINTOP MINISTERIE						
GRANTEE: DIAZ RANCH LLC						

EXTRA FEATURES											
L N	OB/XF CODE	DESCRIPTION	BLD	CAP	L	W	UNITS	UT	Adj R	ADJ UNIT PRICE	ORIG COND
1	0294	SHED WOOD/	0	0	0	0	1.00	UT	0.00	0.00	100
2	0070	CARPORT UF	0	0	11	20	1.00	UT	0.00	0.00	100
3	0021	BARN, FR AE	0	0	24	20	1.00	UT	0.00	0.00	100
4	0251	LEAN TO W/	0	0	0	10	360.00	UT	3.00	3.00	40
5	0251	LEAN TO W/	0	0	0	0	1.00	UT	0.00	0.00	100
6	0261	PRCH, UOP	0	0	0	0	1.00	UT	0.00	0.00	100
7	0294	SHED WOOD/	0	0	18	12	216.00	UT	7.50	7.50	100
8	0166	CONC, PAVMT	0	0	10	15	150.00	UT	2.25	2.25	100
9	0251	LEAN TO W/	0	0	7	12	84.00	UT	4.00	4.00	100
10	0166	CONC, PAVMT	0	0	0	0	1,824.00	UT	2.00	2.00	100

TOTAL OB/XF											
L N	USE CODE	CLS	LAND USE DESCRIPTION	CAP	R D	LOC ZONE	FRONT	DEPTH	TOT LND UTS	UNIT TYPE	D T
1	0100	C	SFR	0		A-1	0.00	0.00	2.00	AC	1.00
2	0100	C	SFR	0		A-1	0.00	0.00	0.36	AC	1.00
3	0100	C	SFR	0		A-1	0.00	0.00	2.00	AC	1.00
4	0100	C	SFR	0		A-1	0.00	0.00	2.00	AC	1.00
5	0000	C	VAC RES	0					7.78	AC	1.00
TOTALS: 8,911											

BUILDING NOTES											
BAS=[ORIG=0,0] W27 S19 S29 E27 N48 \$											
FCP=[ORIG=-27,19] W3 S8 W9 S21 E12 N29 \$											
FOP=[ORIG=-27,48] S5 E27 N5 W27 \$											
UST=[ORIG=-30,19] W9 S8 E9 N8 \$											
FST=[YR=2024;ORIG=-70,10] S19 E14 N19 W14 \$											
FOP=[YR=2024;ORIG=-56,10] S19 E10 N19 W10 \$											

LAND DESCRIPTION												TOTAL OB/XF											
L N	USE CODE	CLS	LAND USE DESCRIPTION	CAP	R D	LOC ZONE	FRONT	DEPTH	TOT LND UTS	UNIT TYPE	D T	% COND	TOT ADJ	UNIT PRICE	ADJ UNIT PRICE	LAND VALUE	OTHER ADJUSTMENTS AND NOTES	YEAR	DENSITY	DECL	FRZ	YR	CONSRV
1	0100	C	SFR	0		A-1	0.00	0.00	2.00	AC	1.00	1.00	1.00	10,000.00	10,000.00	20,000							
2	0100	C	SFR	0		A-1	0.00	0.00	0.36	AC	1.00	1.00	1.00	10,000.00	10,000.00	3,600							
3	0100	C	SFR	0		A-1	0.00	0.00	2.00	AC	1.00	1.00	1.00	10,000.00	10,000.00	20,000							
4	0100	C	SFR	0		A-1	0.00	0.00	2.00	AC	1.00	1.00	1.00	10,000.00	10,000.00	20,000							
5	0000	C	VAC RES	0					7.78	AC	1.00	1.00	1.00	10,000.00	10,000.00	77,800							

COMM NW COR OF NW1/4 OF NE1/4, R
320.49 FT FOR POB, CONT S 368.60
E R/W LITTLE RD, N ALONG R/W 348

MONTENEGRO RANCH LLC
225 EAST DANIA BEACH BLVD
DANIA BEACH, FL 33004

2026

01-5S-16-03402-000



BUILDING CHARACTERISTICS		CONSTRUCTION	
ELEMENT	CD		
Exterior Wall	19	COMMON BRK	100
Roof Structur	03	GABLE/HIP	100
Roof Cover	03	COMP SHNGL	100
Interior Wall	05	DRYWALL	100
Interior Floo	14	CARPET	90
Interior Floo	08	SHT VINYL	10
Air Condition	03	CENTRAL	100
Heating Type	04	AIR DUCTED	100
Bedrooms		2	100
Bathrooms		1	100
Frame	01	NONE	100
Stories	1.	1.	100
Architectual	05	CONV	100
Units		0	100
Condition Adj	02	02	100
Kitchen Adjus	01	01	100
Quality	05	05	
DOR CODE	0101	SFRES/SFRES	
MAP NUM		MKT AREA	01
NEIGHBORHOOD/LOC	1516.00	1.00/	
AREA TYPE	TOTAL GROSS AREA	PCT OF BASE	YEAR
BAS	1,000	100	
FCP	240	25	
FOP	51	30	
UST	96	45	
TOTALS	1,387		

MARKET ADJUSTMENTS											
TYPE	MDL	EFF. AREA	TOT ADJ PTS	EFF. BASE RATE	REPL. COST NEW	AYB	EYB	ECON	FNCT	NORM	% COND
0100	01	1,118	105.3864	118.03	131,958	1969	1969	10	0	0	35.00
2 SINGLE FAM 0% - 2024 Heated Area: 1000 HX Base Yr											

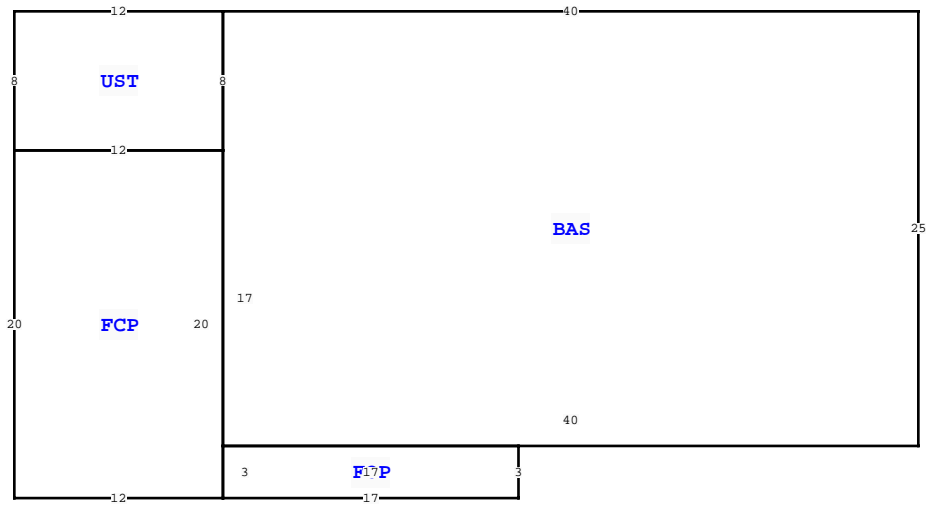

COLUMBIA COUNTY PROPERTY		PAGE 2 of 9	3
VALUATION SUMMARY			
VALUATION BY		STANDARD	
Tax Group: 3	Tax Dist:		
BUILDING MARKET VALUE		808,597	
TOTAL MARKET OB/XF VALUE		64,153	
TOTAL LAND VALUE - MARKET		141,400	
TOTAL MARKET VALUE		1,014,150	
SOH/AGL Deduction		0	
ASSESSED VALUE		1,014,150	
TOTAL EXEMPTION VALUE		0	
BASE TAXABLE VALUE		1,014,150	
TOTAL JUST VALUE		1,014,150	
NCON VALUE		0	
INCOME VALUE			
PREVIOUS YEAR MKT VALUE		1,026,696	

PERMIT NUM	DESCRIPTION	AMT	ISSUED

SALES DATA						
OFF RECORD Number	DATE	TYPE INST	Q / U	V / I	RSN CD	SALE PRICE
1505/1223	12/15/2023	WD	Q	I	05	2,400,000
GRANTOR: DIAZ RANCH LLC						
GRANTEE: MONTENEGRO RANCH LL						
1231/1356	1/11/2012	WD	U	I	17	200,000
GRANTOR: MOUNTAINTOP MINISTERIE						
GRANTEE: DIAZ RANCH LLC						

EXTRA FEATURES											
L N	OB/XF CODE	DESCRIPTION	BLD	CAP	L	W	UNITS	UT	Adj R	ADJ UNIT PRICE	ORIG COND
11	0282	POOL ENCL	0	0	40	80	3,200.00	UT	15.00	15.00	30
12	0166	CONC, PAVMT	0	0	0	0	43,507.00	UT	2.00	2.00	35
13	0040	BARN, POLE	0	0	10	12	1.00	UT	0.00	0.00	100
14	0169	FENCE/WOOD	0	0	0	0	1.00	UT	0.00	0.00	100
15	0040	BARN, POLE	0	0	16	16	1.00	UT	0.00	0.00	100
16	0280	POOL R/CON	0	0	24	12	288.00	UT	70.00	70.00	100

TOTAL OB/XF											
L N	OB/XF CODE	DESCRIPTION	BLD	CAP	L	W	UNITS	UT	Adj R	ADJ UNIT PRICE	ORIG COND
1895 SW LITTLE RD, LAKE CITY											
BLD DATE: 04/15/2026 MLU											
LGL DATE: 04/15/2026											
LAND DATE: 04/15/2026											
AG DATE: 04/15/2026											
INC DATE: 04/15/2026											
TOTAL OB/XF VALUE: 55,242											

BUILDING NOTES											

BUILDING DIMENSIONS											
BAS= W40 UST= W12 S8 E12 N8\$S8 FCP= W12 S20 E12 N20\$ S17 FOP= S3 E17 N3 W17\$ E40 N25\$.											

LAND DESCRIPTION												TOTAL OB/XF												
L N	USE CODE	CLS	LAND USE DESCRIPTION	CAP	R D	LOC ZONE	FRONT	DEPTH	TOT LND UTS	UNIT TYPE	D T	DPH FACT	% COND	TOT ADJ	UNIT PRICE	ADJ UNIT PRICE	LAND VALUE	OTHER ADJUSTMENTS AND NOTES	YEAR	DENSITY	DECL	FRZ	YR	CONSRV

COMM NW COR OF NW1/4 OF NE1/4, R
320.49 FT FOR POB, CONT S 368.60
E R/W LITTLE RD, N ALONG R/W 348

MONTENEGRO RANCH LLC
225 EAST DANIA BEACH BLVD
DANIA BEACH, FL 33004

2026

01-5S-16-03402-000



BUILDING CHARACTERISTICS		CONSTRUCTION	
ELEMENT	CD		
Exterior Wall	32	HARDIE BRD	100
Roof Structur	03	GABLE/HIP	100
Roof Cover	12	MODULAR MT	100
Interior Wall	02	WALL BD/WD	100
Interior Floo	15	HARDTILE	100
Air Condition	03	CENTRAL	100
Heating Type	04	AIR DUCTED	100
Bedrooms		0	100
Bathrooms		0	100
Frame	02	WOOD FRAME	100
Stories	1.5	1.5	100
Architectual	05	CONV	100
Units		0	100
Condition Adj	03	03	100
Quality	05	05	
DOR CODE	0101 SFRES/SFRES		
MAP NUM		MKT AREA	01
NEIGHBORHOOD/LOC	1516.00	1.00/	
AREA TYPE	TOTAL GROSS AREA	PCT OF BASE	YEAR
BAS	360	100	
BAS	990	100	
BAS	1,360	100	
FCP	1,050	25	
TOTALS	3,760		

MARKET ADJUSTMENTS												
TYPE	MDL	EFF. AREA	TOT ADJ PTS	EFF. BASE RATE	REPL. COST NEW	AYB	EYB	ECON	FNCT	NORM	% COND	
0100	01	2,972	105.0000	117.60	349,507	2005	2005	10	0	20.00	70.00	
3 SINGLE FAM 0% - 2024 Heated Area: 2710 HX Base Yr												

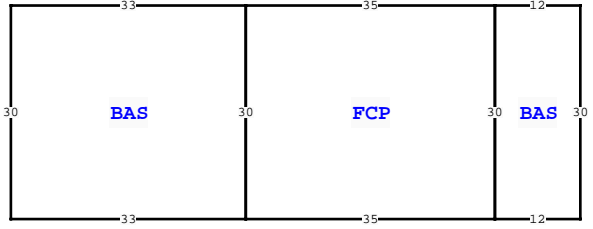
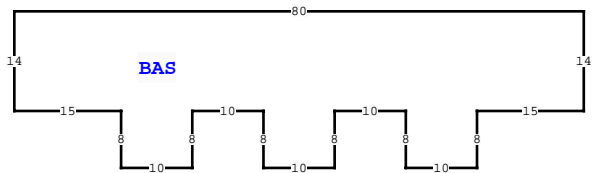

L	OB/XF	DESCRIPTION	BLD	CAP	L	W	UNITS	UT	Adj R	ADJ UNIT PRICE	ORIG COND	YEAR ON	YEAR ACTUAL	Q	% COND	OB/XF MKT VALUE	NOTES

TOTAL OB/XF												
BLD DATE	XF DATE	INC DATE	LGL DATE	LAND DATE	AG DATE							
			04/15/2026			MLU						

LAND DESCRIPTION																								
L	USE CODE	CLS	LAND USE DESCRIPTION	CAP	R	D	LOC ZONE	FRONT	DEPTH	TOT LND UTS	UNIT TYPE	DPTH FACT	% COND	TOT ADJ	UNIT PRICE	ADJ UNIT PRICE	LAND VALUE	OTHER ADJUSTMENTS AND NOTES	YEAR	DENSITY	DECL	FRZ	YR	CONSRV

TOTAL OB/XF																								
0																								

COLUMBIA COUNTY PROPERTY		PAGE 3 of 9	3
VALUATION SUMMARY			
VALUATION BY			STANDARD
Tax Group: 3	Tax Dist:		
BUILDING MARKET VALUE			808,597
TOTAL MARKET OB/XF VALUE			64,153
TOTAL LAND VALUE - MARKET			141,400
TOTAL MARKET VALUE			1,014,150
SOH/AGL Deduction			0
ASSESSED VALUE			1,014,150
TOTAL EXEMPTION VALUE			0
BASE TAXABLE VALUE			1,014,150
TOTAL JUST VALUE			1,014,150
NCON VALUE			0
INCOME VALUE			
PREVIOUS YEAR MKT VALUE			1,026,696

PERMIT NUM	DESCRIPTION	AMT	ISSUED

SALES DATA						
OFF RECORD Number	DATE	TYPE INST	Q / U	V / I	RSN CD	SALE PRICE
1505/1223	12/15/2023	WD	Q	I	05	2,400,000
GRANTOR: DIAZ RANCH LLC						
GRANTEE: MONTENEGRO RANCH LL						
1231/1356	1/11/2012	WD	U	I	17	200,000
GRANTOR: MOUNTAINTOP MINISTERIE						
GRANTEE: DIAZ RANCH LLC						

BUILDING NOTES												

BUILDING DIMENSIONS												
BAS=[ORIG=0,-30] N14 W80 S14 E15 S8 E10 N8 E10 S8 E10 N8 E10 S8 E10 N8 E15 \$												
FCP=[ORIG=0,30] E35 N30 W35 S30 \$												
BAS=[ORIG=0,0] W33 S30 E33 N30 \$												
BAS=[ORIG=35,30] E12 N30 W12 S30 \$												
PTR=[ORIG=0,0] N30 S30 \$												

COMM NW COR OF NW1/4 OF NE1/4, R
320.49 FT FOR POB, CONT S 368.60
E R/W LITTLE RD, N ALONG R/W 348

MONTENEGRO RANCH LLC
225 EAST DANIA BEACH BLVD
DANIA BEACH, FL 33004

2026

01-5S-16-03402-000



BUILDING CHARACTERISTICS		CONSTRUCTION	
ELEMENT	CD		
Exterior Wall	29	NONE	60
Exterior Wall	11	BD/BTN	AVG 40
Roof Structure	03	GABLE/HIP	100
Roof Cover	11	SLATE	100
Interior Wall	06	CUST PANEL	100
Interior Floor	12	HARDWOOD	100
Air Condition	03	CENTRAL	100
Heating Type	04	AIR DUCTED	100
Bedrooms		0	100
Bathrooms		0	100
Frame	02	WOOD FRAME	100
Stories	1.	1.	100
Architectural Units	05	CONV	100
Condition Adj	03	03	100
Quality	05	05	
DOR CODE	0101 SFRES/SFRES		
MAP NUM		MKT AREA	01
NEIGHBORHOOD/LOC	1516.00	1.00/	
AREA TYPE	TOTAL GROSS AREA	PCT OF BASE	YEAR
BAS	280	100	
BAS	946	100	
FST	168	55	
TOTALS	1,394		

MARKET ADJUSTMENTS																									
TYPE	MDL	EFF. AREA	TOT ADJ PTS	EFF. BASE RATE	REPL. COST NEW	AYB	EYB	ECON	FNCT	NORM	% COND														
8601	01	1,318	94.8000	24.65	32,489	2005	2005	10	0	23.00	67.00														
4 OPEN/STRG 0% - 2024 Heated Area: 1226 HX Base Yr																									
<table border="1"> <thead> <tr> <th>BLD DATE</th> <th>XF DATE</th> <th>INC DATE</th> <th>LGL DATE</th> <th>LAND DATE</th> <th>AG DATE</th> </tr> </thead> <tbody> <tr> <td></td> <td></td> <td></td> <td>04/15/2026</td> <td>MLU</td> <td></td> </tr> </tbody> </table>														BLD DATE	XF DATE	INC DATE	LGL DATE	LAND DATE	AG DATE				04/15/2026	MLU	
BLD DATE	XF DATE	INC DATE	LGL DATE	LAND DATE	AG DATE																				
			04/15/2026	MLU																					

COLUMBIA COUNTY PROPERTY		PAGE 4 of 9	3
VALUATION SUMMARY			
VALUATION BY			STANDARD
Tax Group: 3	Tax Dist:		
BUILDING MARKET VALUE			808,597
TOTAL MARKET OB/XF VALUE			64,153
TOTAL LAND VALUE - MARKET			141,400
TOTAL MARKET VALUE			1,014,150
SOH/AGL Deduction			0
ASSESSED VALUE			1,014,150
TOTAL EXEMPTION VALUE			0
BASE TAXABLE VALUE			1,014,150
TOTAL JUST VALUE			1,014,150
NCON VALUE			0
INCOME VALUE			
PREVIOUS YEAR MKT VALUE			1,026,696

PERMIT NUM	DESCRIPTION	AMT	ISSUED

SALES DATA						
OFF RECORD Number	DATE	TYPE INST	Q U	V I	RSN CD	SALE PRICE
1505/1223	12/15/2023	WD	Q	I	05	2,400,000
GRANTOR: DIAZ RANCH LLC						
GRANTEE: MONTENEGRO RANCH LL						
1231/1356	1/11/2012	WD	U	I	17	200,000
GRANTOR: MOUNTAINTOP MINISTERIE						
GRANTEE: DIAZ RANCH LLC						

EXTRA FEATURES																
L N	OB/XF CODE	DESCRIPTION	BLD CAP	L	W	UNITS	UT	Adj R	ADJ UNIT PRICE	ORIG COND	YEAR ON	YEAR ACTUAL	Q	% COND	OB/XF MKT VALUE	NOTES
1895 SW LITTLE RD, LAKE CITY																
TOTALS 0																

BUILDING NOTES													

BUILDING DIMENSIONS													
BAS= W1 FST= N14 W12 S14 E12\$ W12 BAS= N14 W20 S14 E20\$ W21 S22 E6 S9 E22 N9 E6 N22\$.													

LAND DESCRIPTION														TOTAL OB/XF													
L N	USE CODE	CLS	LAND USE DESCRIPTION	CAP	R D	LOC ZONE	FRONT	DEPTH	TOT LND UTS	UNIT TYPE	D T	DPH FACT	% COND	TOT ADJ	UNIT PRICE	ADJ UNIT PRICE	LAND VALUE	OTHER ADJUSTMENTS AND NOTES	YEAR	DENSITY	DECL	FRZ	YR	CONSRV			



ELEMENT		CD	CONSTRUCTION		
Exterior Wall	05	AVERAGE	100		
Roof Structur	03	GABLE/HIP	100		
Roof Cover	08	CLAY TILE	100		
Interior Wall	05	DRYWALL	100		
Interior Floo	15	HARDTILE	90		
Interior Floo	14	CARPET	10		
Air Condition	03	CENTRAL	100		
Heating Type	04	AIR DUCTED	100		
Bedrooms		3	100		
Bathrooms		2	100		
Frame	01	NONE	100		
Stories	1.	1.	100		
Architectual	05	CONV	100		
Units		0	100		
Condition Adj	03	03	100		
Kitchen Adjus	01	01	100		
Quality	05	05			
DOR CODE	0101	SFRES/SFRES			
MAP NUM		MKT AREA		01	
NEIGHBORHOOD/LOC	1516.00	1.00/			
AREA TYPE	TOTAL GROSS AREA	PCT OF BASE	YEAR	TOT ADJ AREA	SUBAREA MARKET VALUE
BAS	197	100		197	13,615
BAS	336	100		336	23,222
BAS	384	100		384	26,539
BAS	1,368	100	2024	1,368	94,547
BAS	161	100		161	11,127
FGR	378	55		208	14,375
FOP	128	30		38	2,626
FOP	240	30		72	4,976
FST	98	55		54	3,732
SFB	108	80		86	5,944
TOTALS	3,734			3,089	213,490

MARKET ADJUSTMENTS																
TYPE	MDL	EFF. AREA	TOT ADJ PTS	EFF. BASE RATE	REPL. COST NEW	AYB	EYB	ECON	FNCT	NORM	% COND					
0100	01	3,089	112.1950	125.66	388,164	1949	1980	10	0	0	35.00	55.00				
5 SINGLE FAM 0% - 2024 Heated Area: 2554 HX Base Yr																
** This building has 11 Sub-Areas 1895 SW LITTLE RD, LAKE CITY																
				BLD DATE					LGL DATE							
				XF DATE					LAND DATE	04/15/2026	MLU					
				INC DATE					AG DATE							
L N	OB/XF CODE	DESCRIPTION	BLD CAP	L	W	UNITS	UT	Adj R	ADJ UNIT PRICE	ORIG COND	YEAR ON	YEAR ACTUAL	Q	% COND	OB/XF MKT VALUE	NOTES

COLUMBIA COUNTY PROPERTY										PAGE 5 of 9	3													
VALUATION SUMMARY																								
VALUATION BY										STANDARD														
Tax Group: 3										Tax Dist:														
BUILDING MARKET VALUE										808,597														
TOTAL MARKET OB/XF VALUE										64,153														
TOTAL LAND VALUE - MARKET										141,400														
TOTAL MARKET VALUE										1,014,150														
SOH/AGL Deduction										0														
ASSESSED VALUE										1,014,150														
TOTAL EXEMPTION VALUE										0														
BASE TAXABLE VALUE										1,014,150														
TOTAL JUST VALUE										1,014,150														
NCON VALUE										0														
INCOME VALUE																								
PREVIOUS YEAR MKT VALUE										1,026,696														
PERMIT NUM	DESCRIPTION			AMT	ISSUED																			
SALES DATA																								
OFF RECORD Number	DATE	TYPE INST	Q U	V I	RSN CD	SALE PRICE																		
1505/1223	12/15/2023	WD	Q	I	05	2,400,000																		
GRANTOR: DIAZ RANCH LLC																								
GRANTEE: MONTENEGRO RANCH LL																								
1231/1356	1/11/2012	WD	U	I	17	200,000																		
GRANTOR: MOUNTAINTOP MINISTERIE																								
GRANTEE: DIAZ RANCH LLC																								
BUILDING NOTES																								
BUILDING DIMENSIONS																								
BAS=[ORIG=0,0] W36 S22 W12 S12 E22 E26 N23 N11 \$																								
BAS=[ORIG=39,-40] N16 W24 S16 E24 \$																								
FGR=[ORIG=7,11] S23 E14 N27 W14 S4 \$																								
UDU=[ORIG=0,-30] N21 W16 S21 E16 \$																								
BAS=[ORIG=39,-56] N14 W24 S14 E24 \$																								
FOP=[ORIG=15,-30] E24 N10 W24 S10 \$																								
BAS=[ORIG=0,11] E7 N4 N7 E8 N8 W15 S19 \$																								
BAS=[YR=2024;ORIG=0,11] S23 E7 N23 W7 \$																								
FOP=[ORIG=-26,34] S8 E16 N8 W16 \$																								
SFB=[ORIG=-50,65] E12 N9 W12 S9 \$																								
FST=[ORIG=7,7] E14 N7 W14 S7 \$																								
LAND DESCRIPTION																								
L N	USE CODE	CLS	LAND USE DESCRIPTION	CAP	R D	LOC ZONE	FRONT	DEPTH	TOT LND UTS	UNIT TYPE	D T	DPHT FACT	% COND	TOT ADJ	UNIT PRICE	ADJ UNIT PRICE	LAND VALUE	OTHER ADJUSTMENTS AND NOTES	YEAR	DENSITY	DECL	FRZ	YR	CONSRV

