

| BUILDING CHARACTERISTICS | |
|--------------------------|---------------------|
| ELEMENT | CD |
| Exterior Wall | 17 MSNRY STUC 100 |
| Roof Structur | 03 GABLE/HIP 100 |
| Roof Cover | 14 PREFIN MT 100 |
| Interior Wall | 03 PLASTER 100 |
| Interior Floor | 14 CARPET 90 |
| Interior Floor | 08 SHT VINYL 10 |
| Air Condition | 03 CENTRAL 100 |
| Heating Type | 04 AIR DUCTED 100 |
| Bedrooms | 3 100 |
| Bathrooms | 2 100 |
| Frame | 01 NONE 100 |
| Stories | 1. 1. 100 |
| Architectual | 05 CONV 100 |
| Units | 0 100 |
| Condition Adj | 03 03 100 |
| Kitchen Adjus | 01 01 100 |
| Quality | 05 05 |
| DOR CODE | 0100 SINGLE FAMILY |
| MAP NUM | MKT AREA 06 |
| NEIGHBORHOOD/LOC | 870317.00 1.00/ |
| AREA TYPE | TOTAL GROSS AREA |
| BAS | 90 100 |
| BAS | 2,230 100 |
| FOP | 148 30 |
| FSP | 168 40 |
| FST | 180 55 |
| UCP | 486 20 |
| UEP | 99 60 |
| UST | 270 45 |
| TOTALS | 3,671 2,808 231,180 |

| MARKET ADJUSTMENTS | | | | | | | | | | | | | |
|--|-----|-----------|-------------|----------------|----------------|------|------|------|------|-------|--------|--|--|
| TYPE | MDL | EFF. AREA | TOT ADJ PTS | EFF. BASE RATE | REPL. COST NEW | AYB | EYB | ECON | FNCT | NORM | % COND | | |
| 0100 | 01 | 2,808 | 113.0880 | 126.66 | 355,661 | 1948 | 1948 | 0 | 0 | 35.00 | 65.00 | | |
| 1 SINGLE FAM 100% - 0 Heated Area: 2320 HX Base Yr | | | | | | | | | | | | | |

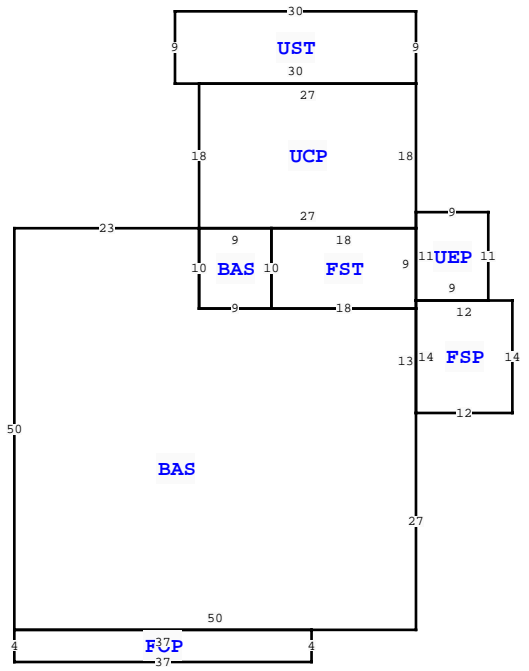

| COLUMBIA COUNTY PROPERTY | | |
|---------------------------|-----------|-------------|
| VALUATION SUMMARY | | PAGE 1 of 1 |
| VALUATION BY | STANDARD | |
| Tax Group: 1 | Tax Dist: | |
| BUILDING MARKET VALUE | 231,180 | |
| TOTAL MARKET OB/XF VALUE | 3,050 | |
| TOTAL LAND VALUE - MARKET | 15,098 | |
| TOTAL MARKET VALUE | 249,328 | |
| SOH/AGL Deduction | 147,047 | |
| ASSESSED VALUE | 102,281 | |
| TOTAL EXEMPTION VALUE | 51,411 | |
| BASE TAXABLE VALUE | 50,870 | |
| TOTAL JUST VALUE | 249,328 | |
| NCON VALUE | 0 | |
| INCOME VALUE | | |
| PREVIOUS YEAR MKT VALUE | 245,704 | |

| PERMIT NUM | DESCRIPTION | AMT | ISSUED |
|------------|-------------|-----|------------|
| 4 | ADDN SFR | 50 | 01/25/2007 |

| SALES DATA | | | | | | |
|-------------------|-----------|-----------|-------|-------|--------|------------|
| OFF RECORD Number | DATE | TYPE INST | Q / U | V / I | RSN CD | SALE PRICE |
| 0518/0598 | 8/01/1983 | WD | Q | I | 01 | 59,000 |

| BUILDING NOTES | |
|----------------|--|
| GRANTOR: | |
| GRANTEE: | |

| BUILDING DIMENSIONS | |
|--|--|
| BAS= W23 S50 FOP= S4 E37 N4 W37\$ E50 N27 FSP= E12 N14 W12 S14\$ N13 FST= N1 UEP= E9 N11 W9 S11\$ N9 W18 S10 E18\$ W18 BAS= N10 W9 S10 E9\$ W9 N10 UCP= E27 N18 UST= N9 W30 S9 E30\$ W27 S18 \$. | |

| EXTRA FEATURES | | | | | | | | | | | | | | | | |
|----------------|------------|-------------|---------|-----|---|-------|------|-------|----------------|-----------|---------|-------------|---|--------|-----------------|-------|
| L N | OB/XF CODE | DESCRIPTION | BLD CAP | L | W | UNITS | UT | Adj R | ADJ UNIT PRICE | ORIG COND | YEAR ON | YEAR ACTUAL | Q | % COND | OB/XF MKT VALUE | NOTES |
| 1 | 0190 | FPLC PF | 0 | 100 | 0 | 0 | 1.00 | UT | 1,200.00 | 100 | 0 | 0 | 3 | 100 | 1,200 | |
| 2 | 0166 | CONC,PAVMT | 0 | 100 | 0 | 0 | 1.00 | UT | 0.00 | 100 | 0 | 0 | 3 | 100 | 1,000 | |
| 3 | 0120 | CLFENCE 4 | 0 | 100 | 0 | 0 | 1.00 | UT | 0.00 | 100 | 1993 | 1993 | 3 | 100 | 200 | |
| 4 | 0294 | SHED WOOD/ | 0 | 100 | 0 | 0 | 1.00 | UT | 0.00 | 100 | 2011 | 2011 | 3 | 100 | 650 | |

| LAND DESCRIPTION | | | | | | | | | | | | | | TOTAL OB/XF | | | | | | | | | | |
|------------------|----------|-----|----------------------|-----|-----|----------|--------|--------|-------------|-----------|-----|-----------|--------|-------------|------------|----------------|------------|-----------------------------|------|---------|------|-----|----|--------|
| L N | USE CODE | CLS | LAND USE DESCRIPTION | CAP | R D | LOC ZONE | FRONT | DEPTH | TOT LND UTS | UNIT TYPE | D T | DPTH FACT | % COND | TOT ADJ | UNIT PRICE | ADJ UNIT PRICE | LAND VALUE | OTHER ADJUSTMENTS AND NOTES | YEAR | DENSITY | DECL | FRZ | YR | CONSRV |
| 1 | 0100 | C | SFR | 100 | | 00 | 110.00 | 122.00 | 13,420.00 | SF | | 1.00 | 1.00 | 0.90 | 1.25 | 1.13 | 15,098 | | | | | | | |