

| BUILDING CHARACTERISTICS | | CONSTRUCTION | |
|--------------------------|------------------|----------------|--------------|
| ELEMENT | CD | | |
| Exterior Wall | 31 | VINYL SID 90 | |
| Exterior Wall | 04 | SINGLE SID 10 | |
| Roof Structure | 03 | GABLE/HIP 100 | |
| Roof Cover | 12 | MODULAR MT 100 | |
| Interior Wall | 02 | WALL BD/WD 100 | |
| Interior Floor | 09 | PINE WOOD 100 | |
| Air Condition | 02 | WINDOW 100 | |
| Heating Type | 02 | CONVECTION 100 | |
| Bedrooms | | 3 100 | |
| Bathrooms | | 1 100 | |
| Frame | 01 | NONE 100 | |
| Stories | 1.1 | 1.100 | |
| Architectural Units | 05 | CONV 100 | |
| Condition Adj | 03 | 03 100 | |
| Kitchen Adjus | 01 | 01 100 | |
| Quality | 05 | 05 | |
| DOR CODE | 0100 | SINGLE FAMILY | |
| MAP NUM | | MKT AREA | 07 |
| NEIGHBORHOOD/LOC | 860317.00 | 1.00/ | |
| AREA TYPE | TOTAL GROSS AREA | PCT OF BASE | YEAR |
| BAS | 264 | 100 | |
| BAS | 1,024 | 100 | |
| TOTALS | 1,288 | | 1,288 77,918 |

| MARKET ADJUSTMENTS | | | | | | | | | | | | | |
|--|-----|-----------|-------------|----------------|----------------|------|------|------|------|-------|--------|--|--|
| TYPE | MDL | EFF. AREA | TOT ADJ PTS | EFF. BASE RATE | REPL. COST NEW | AYB | EYB | ECON | FNCT | NORM | % COND | | |
| 0100 | 01 | 1,288 | 83.0960 | 93.07 | 119,874 | 1952 | 1975 | 0 | 0 | 35.00 | 65.00 | | |
| 1 SINGLE FAM 0% - 0 Heated Area: 1288 HX Base Yr | | | | | | | | | | | | | |

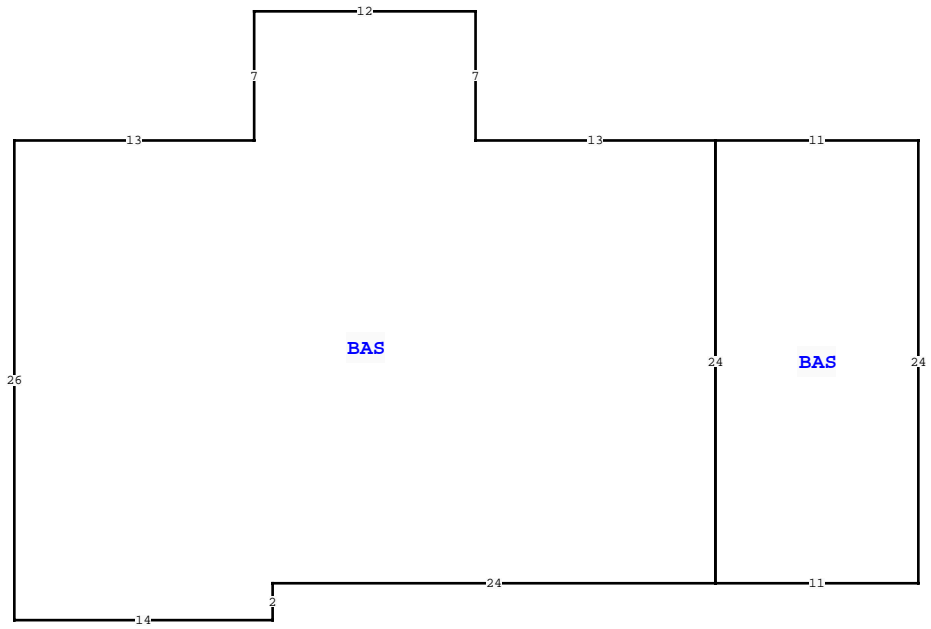

| COLUMBIA COUNTY PROPERTY | | | |
|---------------------------|-----------|--|-------------|
| VALUATION SUMMARY | | | PAGE 1 of 1 |
| VALUATION BY | | | STANDARD |
| Tax Group: 1 | Tax Dist: | | |
| BUILDING MARKET VALUE | | | 77,918 |
| TOTAL MARKET OB/XF VALUE | | | 1,560 |
| TOTAL LAND VALUE - MARKET | | | 7,674 |
| TOTAL MARKET VALUE | | | 87,152 |
| SOH/AGL Deduction | | | 374 |
| ASSESSED VALUE | | | 86,778 |
| TOTAL EXEMPTION VALUE | | | 0 |
| BASE TAXABLE VALUE | | | 86,778 |
| TOTAL JUST VALUE | | | 87,152 |
| NCON VALUE | | | 0 |
| INCOME VALUE | | | |
| PREVIOUS YEAR MKT VALUE | | | 87,152 |

| PERMIT NUM | DESCRIPTION | AMT | ISSUED |
|------------|-------------|-----|--------|
| 00540 | | | |

| SALES DATA | | | | | | |
|-------------------|-----------|-----------|-------|-------|--------|------------|
| OFF RECORD Number | DATE | TYPE INST | Q / U | V / I | RSN CD | SALE PRICE |
| 1194/2781 | 5/21/2010 | WD Q | Q | I | 01 | 58,500 |

GRANTOR: GEORGIA UMSTEAD & LEE
GRANTEE: DONALLE S REED

| BUILDING NOTES | |
|---|--|
| BUILDING DIMENSIONS | |
| BAS= W13 N7 W12 S7 W13 S26 E14 N2 E24 BAS= E11 N24 W11 S24\$ N24\$. | |

| EXTRA FEATURES | | | | | | | | | | | | | | | | |
|----------------|------------|-------------|---------|---|----|--------|----|-------|----------------|-----------|---------|-------------|---|--------|-----------------|-------|
| L N | OB/XF CODE | DESCRIPTION | BLD CAP | L | W | UNITS | UT | Adj R | ADJ UNIT PRICE | ORIG COND | YEAR ON | YEAR ACTUAL | Q | % COND | OB/XF MKT VALUE | NOTES |
| 1 | 0166 | CONC, PAVMT | 0 | 0 | 0 | 1.00 | UT | 0.00 | 0.00 | 100 | 0 | 0 | 3 | 100 | 80 | |
| 2 | 0296 | SHED METAL | 0 | 0 | 0 | 1.00 | UT | 0.00 | 0.00 | 100 | 2004 | 2004 | 3 | 100 | 100 | |
| 3 | 0296 | SHED METAL | 0 | 0 | 0 | 1.00 | UT | 0.00 | 0.00 | 100 | 2004 | 2004 | 3 | 100 | 300 | |
| 4 | 0070 | CARPORT UF | 0 | 0 | 18 | 360.00 | UT | 3.00 | 3.00 | 100 | 2004 | 2004 | 3 | 100 | 1,080 | |

| LAND DESCRIPTION | | | | | | | | | | | | | | TOTAL OB/XF | | | | | | | | | | |
|------------------|----------|-----|----------------------|-----|-----|----------|--------|--------|-------------|-----------|-----|----------|--------|-------------|------------|----------------|------------|-----------------------------|------|---------|------|-----|----|--------|
| L N | USE CODE | CLS | LAND USE DESCRIPTION | CAP | R D | LOC ZONE | FRONT | DEPTH | TOT LND UTS | UNIT TYPE | D T | DPH FACT | % COND | TOT ADJ | UNIT PRICE | ADJ UNIT PRICE | LAND VALUE | OTHER ADJUSTMENTS AND NOTES | YEAR | DENSITY | DECL | FRZ | YR | CONSRV |
| 1 | 0100 | C | SFR | 0 | | *RSF- | 370.00 | 115.00 | 8,078.00 | SF | | 1.00 | 1.00 | 1.00 | 0.95 | 0.95 | 7,674 | | | | | | | |