

BUILDING CHARACTERISTICS	
ELEMENT	CD
Exterior Wall	08 WD OR PLY 80
Exterior Wall	10 ABOVE AVG. 20
Roof Structure	03 GABLE/HIP 100
Roof Cover	14 PREFIN MT 80
Roof Cover	01 MINIMUM 20
Interior Wall	02 WALL BD/WD 100
Interior Floor	06 VINYL ASB 100
Air Condition	02 WINDOW 100
Heating Type	02 CONVECTION 100
Bedrooms	3 100
Bathrooms	1 100
Frame	01 NONE 100
Stories	1. 1. 100
Architectual	05 CONV 100
Units	0 100
Condition Adj	03 03 100
Kitchen Adjus	01 01 100

MARKET ADJUSTMENTS											
TYPE	MDL	EFF. AREA	TOT ADJ PTS	EFF. BASE RATE	REPL. COST NEW	AYB	EYB	ECON	FNCT	NORM	% COND
1	SFR	PILING	0%	- 0							
Heated Area: 440						HX Base Yr					

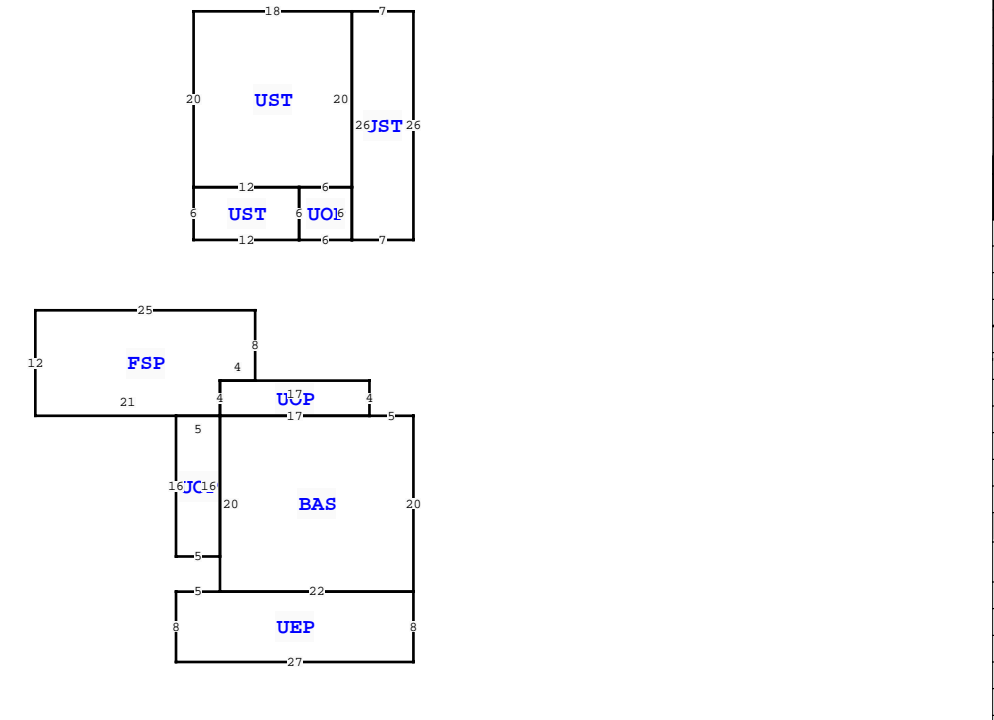

Quality					
DOR CODE	MAP NUM				
05 05	02				
0100 SINGLE FAMILY					
NEIGHBORHOOD/LOC	100000.07 1.00/				
AREA TYPE	TOTAL GROSS AREA	PCT OF BASE	YEAR	TOT ADJ AREA	SUBAREA MARKET VALUE
BAS	440	100		440	31,237
FSP	284	40		114	8,093
UEP	216	60		130	9,229
UOP	36	20		7	497
UOP	68	20		14	994
UOP	80	20		16	1,136
UST	72	45		32	2,272
UST	182	45		82	5,821
UST	360	45		162	11,501
TOTALS	1,738			997	70,779

2766 SW SANTA FE DR, FORT WHITE

BLD DATE		LGL DATE	
XF DATE		LAND DATE	05/13/2025
INC DATE		AG DATE	MLU

EXTRA FEATURES											
L N	OB/XF CODE	DESCRIPTION	BLD	CAP	L	W	UNITS	UT	Adj R	ADJ UNIT PRICE	ORIG COND
1	0080	DECKING	0	0	0	0	1.00	UT	0.00	0.00	100

YEAR ON	YEAR ACTUAL	Q	% COND	OB/XF MKT VALUE	NOTES
2016	2016	3	100	300	

COLUMBIA COUNTY PROPERTY		PAGE 1 of 1	3
VALUATION SUMMARY			
VALUATION BY	STANDARD		
Tax Group: 3	Tax Dist:		
BUILDING MARKET VALUE	70,779		
TOTAL MARKET OB/XF VALUE	300		
TOTAL LAND VALUE - MARKET	74,100		
TOTAL MARKET VALUE	145,179		
SOH/AGL Deduction	14,834		
ASSESSED VALUE	130,345		
TOTAL EXEMPTION VALUE	0		
BASE TAXABLE VALUE	130,345		
TOTAL JUST VALUE	145,179		
NCON VALUE	0		
INCOME VALUE			
PREVIOUS YEAR MKT VALUE	145,179		

PERMIT NUM	DESCRIPTION	AMT	ISSUED
11376	ADDN SFR	50	07/05/1996

SALES DATA						
OFF RECORD Number	DATE	TYPE INST	Q / U	V / I	RSN CD	SALE PRICE
1562/613	3/02/2026	QC	U	I	11	100
GRANTOR: SEACRIST VIRGINIA ANN						
GRANTEE: SEACRIST VIRGINIA R						
1372/0938	8/29/2016	QC	U	I	11	100
GRANTOR: VIRGINIA SEACRIST						
GRANTEE: VIRGINIA ANN JACOBS						

BUILDING NOTES	

BUILDING DIMENSIONS	
BAS=[ORIG=0,0] W5 W17 S20 E22 N20 \$	
UST=[ORIG=-7,-46] W18 S20 E12 E6 N20 \$	
FSP=[ORIG=-22,0] N4 E4 N8 W25 S12 E21 \$	
UEP=[ORIG=-22,20] W5 S8 E27 N8 W22 \$	
UST=[ORIG=0,-20] N26 W7 S26 E7 \$	
UOP=[ORIG=-22,0] W5 S16 E5 N16 \$	
UST=[ORIG=-25,-26] S6 E12 N6 W12 \$	
UOP=[ORIG=-5,0] N4 W17 S4 E17 \$	
UOP=[ORIG=-13,-26] S6 E6 N6 W6 \$	

LAND DESCRIPTION												TOTAL OB/XF												
L N	USE CODE	CLS	LAND USE DESCRIPTION	CAP	R D	LOC ZONE	FRONT	DEPTH	TOT LND UTS	UNIT TYPE	D T	DPH FACT	% COND	TOT ADJ	UNIT PRICE	ADJ UNIT PRICE	LAND VALUE	OTHER ADJUSTMENTS AND NOTES	YEAR	DENSITY	DECL	FRZ	YR	CONSRV
1	0132	C	SFR RIVER	0		A-1	0.00	0.00	76.00	FF		1.00	1.00	1.30	750.00	975.00	74,100							