

BUILDING CHARACTERISTICS		CONSTRUCTION	
ELEMENT	CD		
Exterior Wall	31	VINYL SID	100
Roof Structur	03	GABLE/HIP	100
Roof Cover	12	MODULAR MT	100
Interior Wall	05	DRYWALL	100
Interior Floor	14	CARPET	90
Interior Floor	08	SHT VINYL	10
Air Condition	03	CENTRAL	100
Heating Type	04	AIR DUCTED	100
Bedrooms		3	100
Bathrooms		2	100
Stories	1.	1.	100
Architectural	01	CONV	100
Units		0	100
Condition Adj	03	03	100
Kitchen Adjus	01	01	100
Quality	05	05	
DOR CODE	0200 MOBILE HOME		
MAP NUM		MKT AREA	07
NEIGHBORHOOD/LOC	17317.040 1.00/		
AREA TYPE	TOTAL GROSS AREA	PCT OF BASE	YEAR
BAS	1,728	100	
TOTALS	1,728		1,728 114,842

MARKET ADJUSTMENTS																									
TYPE	MDL	EFF. AREA	TOT ADJ PTS	EFF. BASE RATE	REPL. COST NEW	AYB	EYB	ECON	FNCT	NORM	% COND														
0201	02	1,728	115.9000	108.95	188,266	2010	2009	0	0	39.00	61.00														
1 MANUF 1 100% - 0 Heated Area: 1728 HX Base Yr																									
<div style="border: 1px solid black; width: 100%; height: 100%; display: flex; align-items: center; justify-content: center;"> BAS </div>																									
<table border="1" style="width: 100%;"> <tr> <td>BLD DATE</td> <td></td> <td>LGL DATE</td> <td></td> </tr> <tr> <td>XF DATE</td> <td></td> <td>LAND DATE</td> <td>04/21/2023 MLU</td> </tr> <tr> <td>INC DATE</td> <td></td> <td>AG DATE</td> <td></td> </tr> </table>														BLD DATE		LGL DATE		XF DATE		LAND DATE	04/21/2023 MLU	INC DATE		AG DATE	
BLD DATE		LGL DATE																							
XF DATE		LAND DATE	04/21/2023 MLU																						
INC DATE		AG DATE																							

COLUMBIA COUNTY PROPERTY			PAGE 1 of 2
VALUATION SUMMARY			2
VALUATION BY		STANDARD	
Tax Group: 2	Tax Dist:		
BUILDING MARKET VALUE			135,792
TOTAL MARKET OB/XF VALUE			20,722
TOTAL LAND VALUE - MARKET			33,300
TOTAL MARKET VALUE			189,814
SOH/AGL Deduction			70,029
ASSESSED VALUE			119,785
TOTAL EXEMPTION VALUE	HX HB	50,722	
BASE TAXABLE VALUE			69,063
TOTAL JUST VALUE			189,814
NCON VALUE			0
INCOME VALUE			
PREVIOUS YEAR MKT VALUE			197,345

PERMIT NUM	DESCRIPTION	AMT	ISSUED
000047785	Roof Replacement	11,040	07/28/2023
28254	M H	375	12/07/2009
13895	M H	125	04/15/1998

SALES DATA						
OFF RECORD Number	DATE	TYPE INST	Q U	V I	RSN CD	SALE PRICE

EXTRA FEATURES																	
L N	OB/XF CODE	DESCRIPTION	BLD	CAP	L	W	UNITS	UT	Adj R	ADJ UNIT PRICE	ORIG COND	YEAR ON	YEAR ACTUAL	Q	% COND	OB/XF MKT VALUE	NOTES
1	0294	SHED WOOD/	0	100	0	0	1.00	UT	0.00	0.00	100	1993	1993	3	100	500	
2	0070	CARPORT UF	0	100	18	20	360.00	UT	3.00	3.00	50	1993	1993	3	50	540	
3	0120	CLFENCE 4	0	100	0	0	1.00	UT	0.00	0.00	100	1993	1993	3	100	1,500	
4	9945	Well/Sept	0	100	0	0	1.00	UT	7,000.00	7,000.00	100			3	100	7,000	
5	0255	MBL HOME S	0	100	0	0	1,272.00	UT	1.00	1.00	100	2009	2009	3	100	1,272	
6	9947	Septic	0	0	0	0	1.00	UT	3,000.00	3,000.00	100			3	100	3,000	
7	0285	SALVAGE	0	100	0	0	1.00	UT	0.00	0.00	100	2010	2010	3	100	500	
8	0264	PRCH,FSP	0	100	0	0	1.00	UT	0.00	0.00	100	2010	2010	3	100	1,800	
9	0210	GARAGE U	0	100	18	27	486.00	UT	11.00	11.00	75	2015	2015	3	75	4,010	
10	0261	PRCH,UOP	0	100	0	0	1.00	UT	0.00	0.00	100	2015	2015	3	100	600	

LAND USE DESCRIPTION														TOTAL OB/XF										
L N	USE CODE	CLS	LAND USE DESCRIPTION	CAP	R D	LOC ZONE	FRONT	DEPTH	TOT LND UTS	UNIT TYPE	D T	DPHT FACT	% COND	TOT ADJ	UNIT PRICE	ADJ UNIT PRICE	LAND VALUE	OTHER ADJUSTMENTS AND NOTES	YEAR	DENSITY	DECL	FRZ	YR	CONSRV
1	0200	C	MBL HM	100		A-1	0.00	0.00	1.00	LT		1.00	1.00	0.90	18,500.00	16,650.00	16,650							
2	0200	C	MBL HM	0		A-1	0.00	0.00	1.00	LT		1.00	1.00	0.90	18,500.00	16,650.00	16,650							

BUILDING NOTES													

BUILDING DIMENSIONS													
BAS= W64 S27 E64 N27\$.													

LAND USE DESCRIPTION														TOTAL OB/XF										
L N	USE CODE	CLS	LAND USE DESCRIPTION	CAP	R D	LOC ZONE	FRONT	DEPTH	TOT LND UTS	UNIT TYPE	D T	DPHT FACT	% COND	TOT ADJ	UNIT PRICE	ADJ UNIT PRICE	LAND VALUE	OTHER ADJUSTMENTS AND NOTES	YEAR	DENSITY	DECL	FRZ	YR	CONSRV
1	0200	C	MBL HM	100		A-1	0.00	0.00	1.00	LT		1.00	1.00	0.90	18,500.00	16,650.00	16,650							
2	0200	C	MBL HM	0		A-1	0.00	0.00	1.00	LT		1.00	1.00	0.90	18,500.00	16,650.00	16,650							

BUILDING CHARACTERISTICS		
ELEMENT	CD	CONSTRUCTION
Exterior Wall	03	BELOW AVG. 100
Roof Structur	03	GABLE/HIP 100
Roof Cover	12	MODULAR MT 100
Interior Wall	05	DRYWALL 100
Interior Floor	14	CARPET 90
Interior Floor	08	SHT VINYL 10
Air Condition	03	CENTRAL 100
Heating Type	04	AIR DUCTED 100
Bedrooms		3 100
Bathrooms		1.5 100
Stories	1.	1. 100
Architectual	01	CONV 100
Units		0 100
Condition Adj	02	02 100
Kitchen Adjus	01	01 100
Quality	03	03
DOR CODE	0200 MOBILE HOME	
MAP NUM		MKT AREA 07
NEIGHBORHOOD/LOC	17317.040 1.00/	
AREA TYPE	TOTAL GROSS AREA	PCT OF BASE
BAS	1,008	100
UOP	120	25
UOP	120	25
TOTALS	1,248	1,068

MARKET ADJUSTMENTS											
TYPE	MDL	EFF. AREA	TOT ADJ PTS	EFF. BASE RATE	REPL. COST NEW	AYB	EYB	ECON	FNCT	NORM	% COND
0800	02	1,068	81.7290	49.04	52,375	1979	1979	0	0	60.00	40.00
2 MOBILE HME 0% - 0 Heated Area: 1008 HX Base Yr											

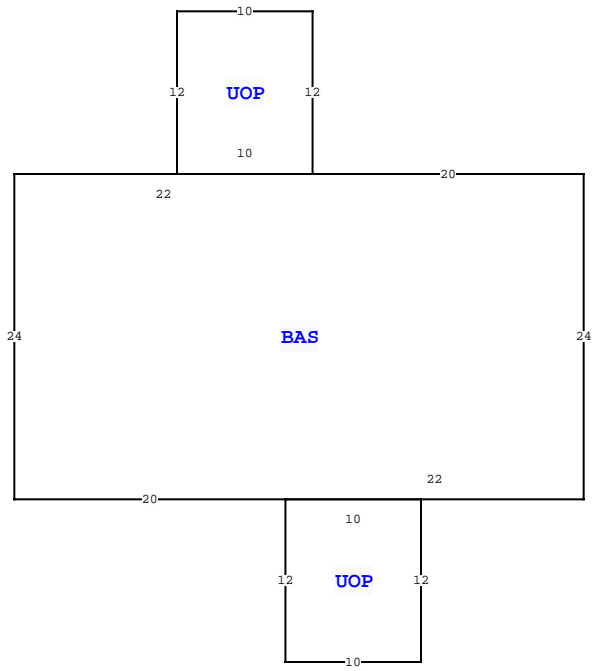

VALUATION SUMMARY		STANDARD
VALUATION BY	Tax Group: 2	Tax Dist:
BUILDING MARKET VALUE		135,792
TOTAL MARKET OB/XF VALUE		20,722
TOTAL LAND VALUE - MARKET		33,300
TOTAL MARKET VALUE		189,814
SOH/AGL Deduction		70,029
ASSESSED VALUE		119,785
TOTAL EXEMPTION VALUE	HX HB	50,722
BASE TAXABLE VALUE		69,063
TOTAL JUST VALUE		189,814
NCON VALUE		0
INCOME VALUE		
PREVIOUS YEAR MKT VALUE		197,345

PERMIT NUM	DESCRIPTION	AMT	ISSUED

SALES DATA						
OFF RECORD Number	DATE	TYPE INST	Q / U	V / I	RSN CD	SALE PRICE

EXTRA FEATURES											
L N	OB/XF CODE	DESCRIPTION	BLD CAP	L	W	UNITS	UT	Adj R	ADJ UNIT PRICE	ORIG COND	YEAR ON

TOTAL OB/XF											
BLD DATE	XF DATE	INC DATE	LGL DATE	LAND DATE	AG DATE	04/21/2023	MLU				

BUILDING NOTES											

BUILDING DIMENSIONS											
BAS= W20 UOP= N12 W10 S12 E10\$ W22 S24 E20 UOP= S12 E10 N12 W10\$ E22 N24\$.											

LAND DESCRIPTION												TOTAL OB/XF												
L N	USE CODE	CLS	LAND USE DESCRIPTION	CAP	R D	LOC ZONE	FRONT	DEPTH	TOT LND UTS	UNIT TYPE	D T	DPH FACT	% COND	TOT ADJ	UNIT PRICE	ADJ UNIT PRICE	LAND VALUE	OTHER ADJUSTMENTS AND NOTES	YEAR	DENSITY	DECL	FRZ	YR	CONSRV